

COMMITTEE OF THE WHOLE - JANUARY 7, 2002

**FIRST GULF KEELE HOLDINGS INC.
KEELE / 407 BUSINESS PARK
19T-00V08
SERVICING ALLOCATION**

Recommendation

The Commissioner of Development Services and Public Works recommends:

That Council pass the following resolution allocating sewage and water servicing capacity to the proposed Plan of Subdivision 19T-00V08 for a total of 24.46 hectares:

“NOW THEREFORE BE AND IT IS HEREBY RESOLVED THAT the proposed Plan of Subdivision 19T-00V08 is allocated sewage capacity from the York/Durham Servicing Scheme, and water capacity from Pressure District No. 6 of the York Water Supply System.”

Purpose

This report represents a review of the proposed servicing allocation for the subject subdivision.

Background - Analysis and Options

The Keele / 407 Business Park subdivision comprises 3 industrial blocks and a stormwater management facility located on the east side of Keele Street south of Highway 407 as shown on Attachment No. 1. This proposed plan of subdivision was draft approved on December 18, 2000, at which time Council passed the following resolution with respect to the allocation of water and sewage servicing capacity:

“NOW THEREFORE BE AND IT IS HEREBY RESOLVED THAT the Plan of Subdivision 19T-00V08 is allocated sewage capacity from the York/Durham Servicing Scheme, and water capacity from Pressure District No. 6 of the York Water Supply System. Said allocation shall automatically be revoked after a period of one year in the event that the plan is not registered.”

The Keele / 407 Business Park subdivision plan has not been registered. Accordingly, pursuant to Council's direction, the reservation of sewage capacity for this subdivision returned to Council on December 18, 2001.

Currently, preservicing of the Keele / 407 Business Park subdivision is underway. The subdivision agreement is being finalized and it is expected to be executed shortly. The developer has advised that it is his intention to clear all conditions of draft plan approval and proceed to registration of the plan in February 2002.

Conclusion

Staff recommends the allocation of sewage and water servicing capacity to the Keele / 407 Business Park, in order that the developer may proceed with registration of the Plan. Should Council concur, the recommended resolution may be passed.

Attachments

I. Location Map

Report prepared by

Mirella Doyle, Senior Engineering Assistant, ext. 8256

Tony Ching, Development Engineer, Development Review, ext 8711

Brendan Holly, Senior Manager Development/Transportation Engineering, ext 8250

Respectfully submitted,

FRANK MIELE
Commissioner of Development Services
and Public Works

Bill Robinson, P. Eng.
Executive Director of City Engineering
and Public Works

MD/mr

ATTACHMENT No. 1

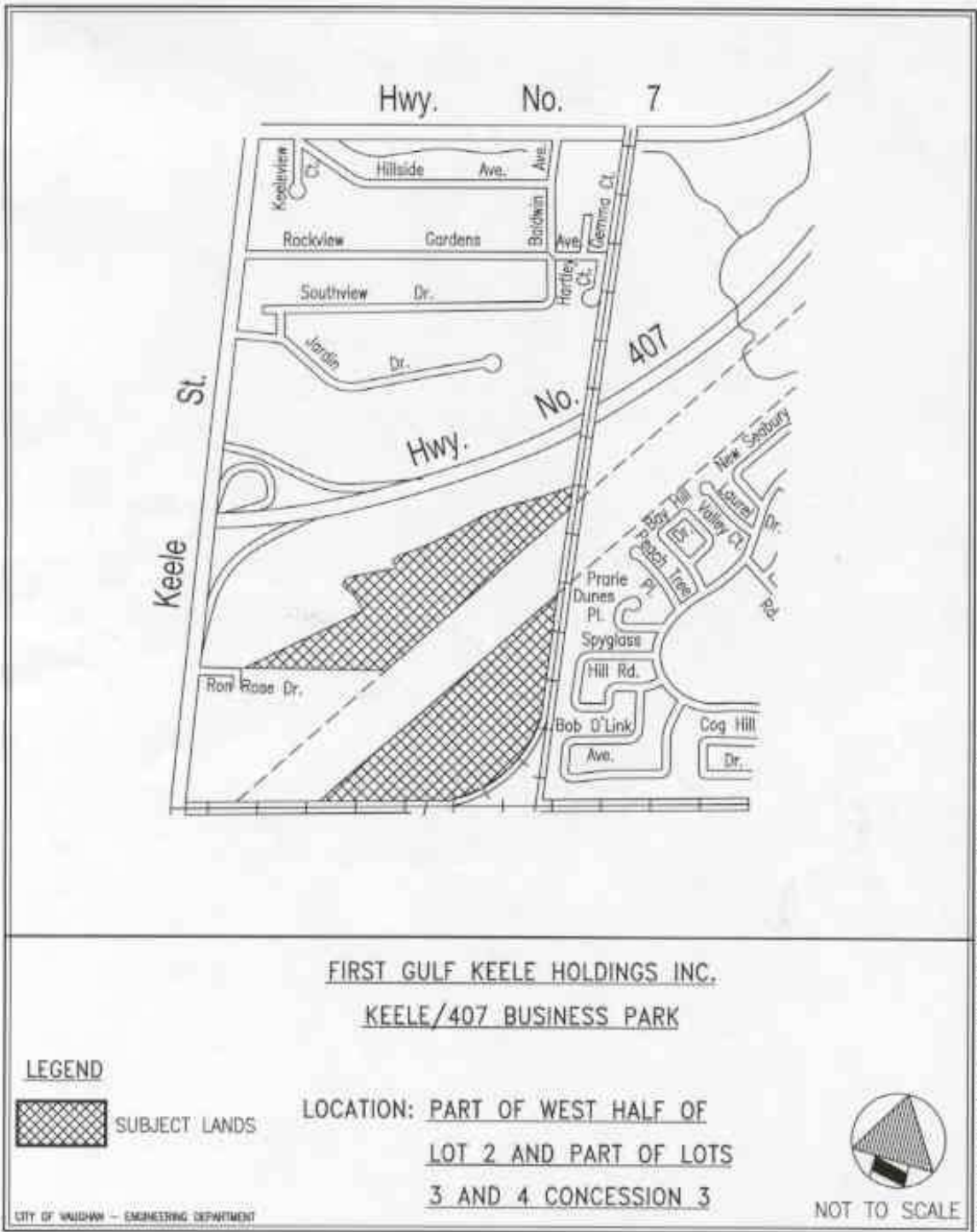

FIRST GULF KEELE HOLDINGS INC.
 KEELE/407 BUSINESS PARK

LEGEND

 SUBJECT LANDS

LOCATION: PART OF WEST HALF OF
 LOT 2 AND PART OF LOTS
 3 AND 4 CONCESSION 3

CITY OF WILLOW - ENGINEERING DEPARTMENT

NOT TO SCALE

Drawing name: R:\E0000477\BCEVELOP\J5-ANNING\MCH022\Views-407_Business park.dwg