

COMMITTEE OF THE WHOLE OCTOBER 7, 2002

SIGN VARIANCE APPLICATION

FILE NO.: SV.02-011
OWNER: AMICA VILLA DE VINCI
LOCATION: 7365 MARTIN GROVE ROAD
PART 7, PLAN 65R-11514

Recommendation

The Sign Variance Committee recommends:

That Sign Variance Application SV.02-011, Amica Villa De Vinci, be approved for signage identified as signs #3 and #4 of the variance application, and that signs identified as signs #1 and #2 conform and comply to all requirements of the sign by-law and are approved as in the site plan agreement.

Purpose

Applicant is requesting to install one additional ground sign and one non-illuminated plaque on the building.

Background - Analysis and Options

By-Law Requirements (203-92, as amended)

“Section 7 – Multiple Family Buildings”

- 7.2 (a) Only one ground sign per lot, identifying a multiple family building or other permitted use, shall be permitted. Said sign shall not exceed a sign height of 2.0m nor a sign area of 2.4 sq.m.
- 7.2 (b) In addition of the above, one wall sign located at the ground floor level of a permitted use may also be permitted provided such sign does not exceed a sign area of 2.4 sq.m. Such sign shall not contain commercial advertising and shall identify only the building.

Conclusion

Applicant is requesting to install one additional ground sign measuring 1.52m and one additional wall sign measuring .15m.

Original site plan agreement accommodated sign #1 and 2 on drawing, but does not accommodate sign #3 and 4, therefore variance is required.

Attachments

1. Sketch of Sign

Report prepared by:

John Studdy, Manager of Customer & Administrative Services

Respectfully submitted,

John Studdy
Chair, Sign Variance Committee

/pa

FEB-23-2012 09:08

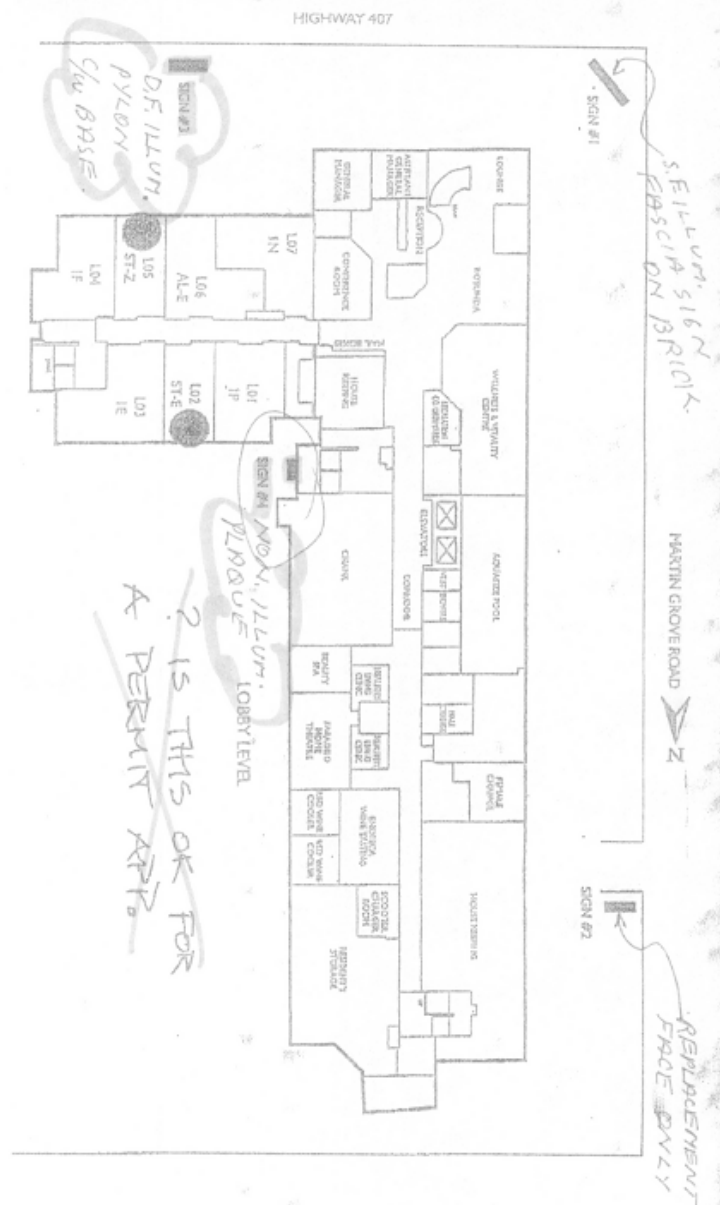

SP SITE PLAN SHOWING LOCATION OF SIGN #1, #2, #3, AND #4
N. T. S.

The contractor to be contacted for design must be a registered professional engineer or architect. The contractor must be licensed in the state of North Carolina. Before commencing work, the contractor must obtain all necessary permits from the appropriate local, state, and federal agencies. The contractor shall be responsible for obtaining all necessary permits. The contractor shall be responsible for obtaining all necessary permits. The contractor shall be responsible for obtaining all necessary permits.

AS NOTED	AS NOTED	AS NOTED	AS NOTED	AS NOTED	AS NOTED	AS NOTED
01-8963	1 OF SIX	02/02/08	J-LINCOLN/AR/ICAM/WOODBRIDGE/SP	CLINT HARRIS	01-11-15	01/11/15
172" = 1'-0"	D.J.					

NOTE: THIS SHEET WAS CREATED BY L.S. LEE. PARTIAL LAYOUTS HAVE BEEN CONDENSED BY JOHN HALL. ALL DIMENSIONS ARE IN FEET UNLESS OTHERWISE NOTED.

P. 18/18

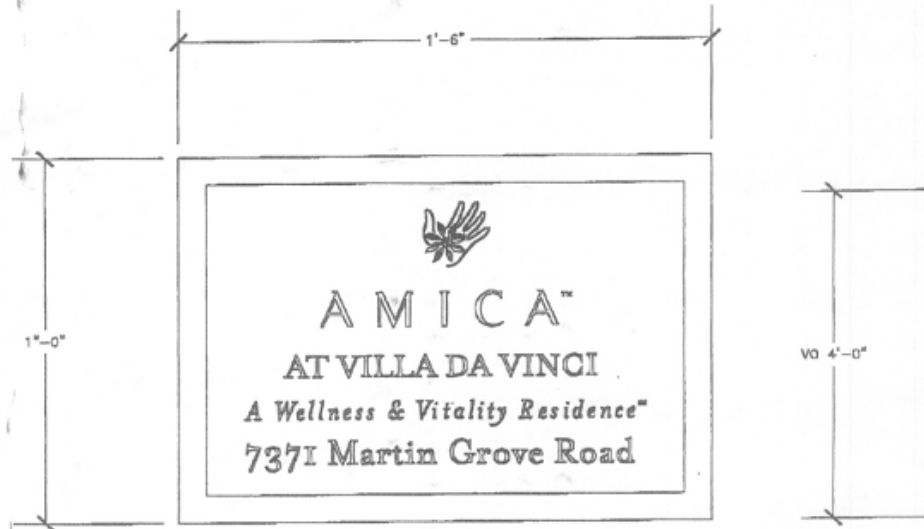

SIGN #4 PLAQUE

WHITE COPY AND LOGO
 CLEAR LEXAN FACE WITH
 3M #128 DARK EMERALD
 GREEN VINYL BACKGROUND
 ON SECOND SURFACE,
 GPS ON FIRST SURFACE.

NON-ILLUMINATED
 PLAQUE

#4

