

**COMMITTEE OF THE WHOLE OCTOBER 7, 2002**

**STREET NAME APPROVAL FILE 19T-89024**  
**VELLORE VILLAGE PHASE 5**

**Recommendation**

The Commissioner of Planning recommends:

THAT the following street names be submitted for approval:

| <u>STREET</u> | <u>PROPOSED NAME</u>            |
|---------------|---------------------------------|
| Street 'A'    | Via Campanile                   |
| Street 'B'    | Pieta Place                     |
| Street 'C'    | Cupola Crescent                 |
| Street 'D'    | Saint Nicholas Crescent         |
| Street 'E'    | Christina Ciccolini Court       |
| Street 'F'    | Saint Victor Drive              |
| Street 'G'    | Saint James Avenue              |
| Street 'H'    | Vescovo Road                    |
| Street 'I'    | Saint Francis Avenue (existing) |

**Purpose**

The owner has submitted street name(s) for approval by the City to satisfy a condition of draft approval.

**Background - Analysis and Options**

The plan was draft approved by the O.M.B. on February 2, 1998. The Planning Department for the Region does not have any objections to the proposed names.

**Conclusion**

Staff consider the proposed names to be satisfactory and should Council concur, the proposed names should be approved.

**Attachments**

1. Location map
2. Plan showing proposed streets

**Report prepared by:**

Jack McAllister, Draftsperson G, ext. 8209

Respectfully submitted,

MICHAEL DeANGELIS  
Commissioner of Planning

JOANNE R. ARBOUR  
Director of Community Planning

/LG

47

40

Major Mackenzie Dr.

Dr.

Dr.

Valley Dr.

Pine Dr.

Rutherford Rd.

Rd.

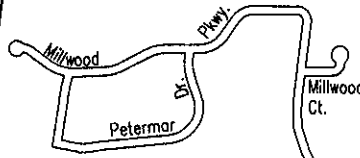

Woodend Pl.

LOT 21 | 22 Weston Rd. 23

20

39

18 Weston

17

LOT 16

5

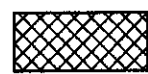
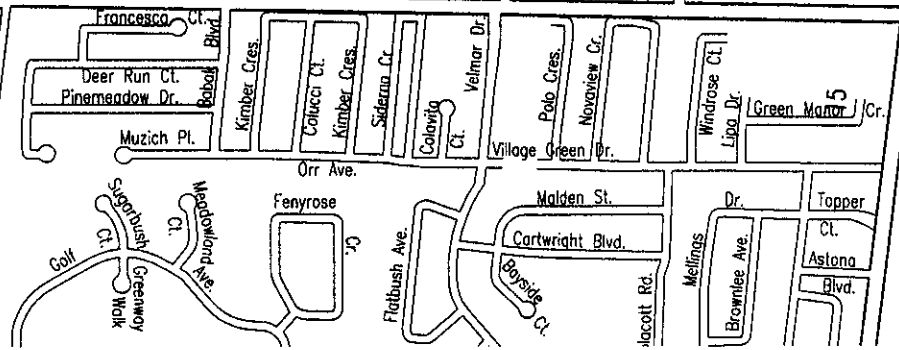
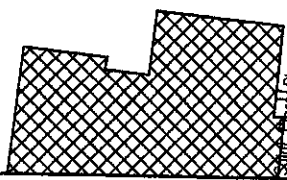

**SUBJECT LANDS**

**ATTACHMENT '1'**  
**LOCATION MAP**

|                |                    |
|----------------|--------------------|
| FILE #:        | REPORT #:          |
| 19T-89024      | LOCATION:          |
| DATE: 02/09/25 | PT. LOT 16, CON. 6 |
| SCALE:         | NOT TO SCALE       |

APPLICANT: VELLORE VILLAGE PHASE V

CITY OF VAUGHAN PLANNING DEPARTMENT

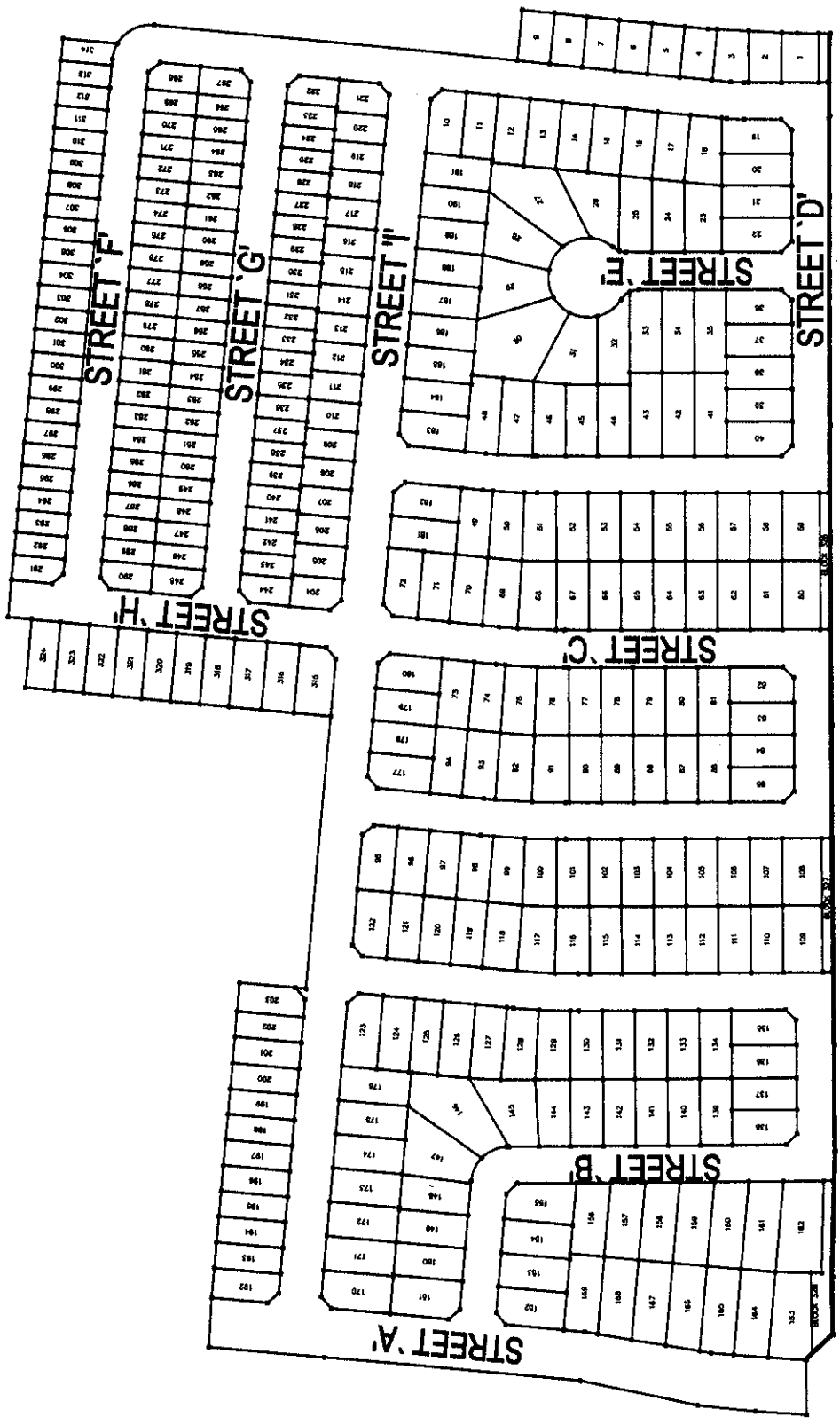

RUTHERFORD ROAD

**ATTACHMENT '2'**  
**PROPOSED PLAN**

FILE # 19T-89024  
 REPORT #

LOCATION: LOT 16, CONC. 5  
 02/09/25

NOT TO SCALE

CITY OF VAUGHAN PLANNING DEPARTMENT

APPLICANT: VELLORE VILLAGE PHASE V

