

COMMITTEE OF THE WHOLE – DECEMBER 8, 2003

**WATER SUPPLY ALLOCATION
FOREST HILL OF KLEINBURG RESIDENTIAL SUBDIVISION 19T-80002**

Recommendation

The Commissioner of Engineering and Public Works recommends:

That Council pass the following resolution allocating water servicing capacity to the proposed Plan of Subdivision 19T-80002 from the Kleinburg-Nashville Servicing System:

“NOW THEREFORE BE AND IT IS HEREBY RESOLVED THAT the proposed Plan of Subdivision 19T-80002 is allocated water capacity from the Kleinburg-Nashville Water System of the York Water Supply System for a total of 12 residential units.”

Purpose

This report is intended to obtain Council approval for the allocation of water supply to the Forest Hill of Kleinburg subdivision, 19T-80002.

Background - Analysis and Options

The Forest Hill of Kleinburg subdivision is located south of Nashville Road and west of Highway 27 as illustrated on Attachment No. 1. This proposed plan of subdivision was draft approved on September 16, 1986, and comprises of 12 estate residential lots serviced with municipal water and private sewage disposal systems.

The subdivision agreement is presently being prepared for execution in accordance with the Delegation By-law 333-98. Therefore, it is appropriate to allocate water servicing capacity to the Plan upon execution of the subdivision agreement to the satisfaction of the City.

Conclusion

It is recommended that Council approve the allocation of water supply to the proposed Forest Hill of Kleinburg 19T-80002, upon execution of the subdivision agreement to the satisfaction of the City.

Attachments

- I. Location Map

Report prepared by

Jacqueline Thoman, Senior Engineering Assistant, ext. 8728
Tony Ching, Development Engineer, Development Review, ext 8711

Respectfully submitted,

Bill Robinson, P. Eng.
Commissioner of Engineering and Public Works

Michael Won, P. Eng.
Director of Development/Transportation
Engineering

ATTACHMENT No. 1

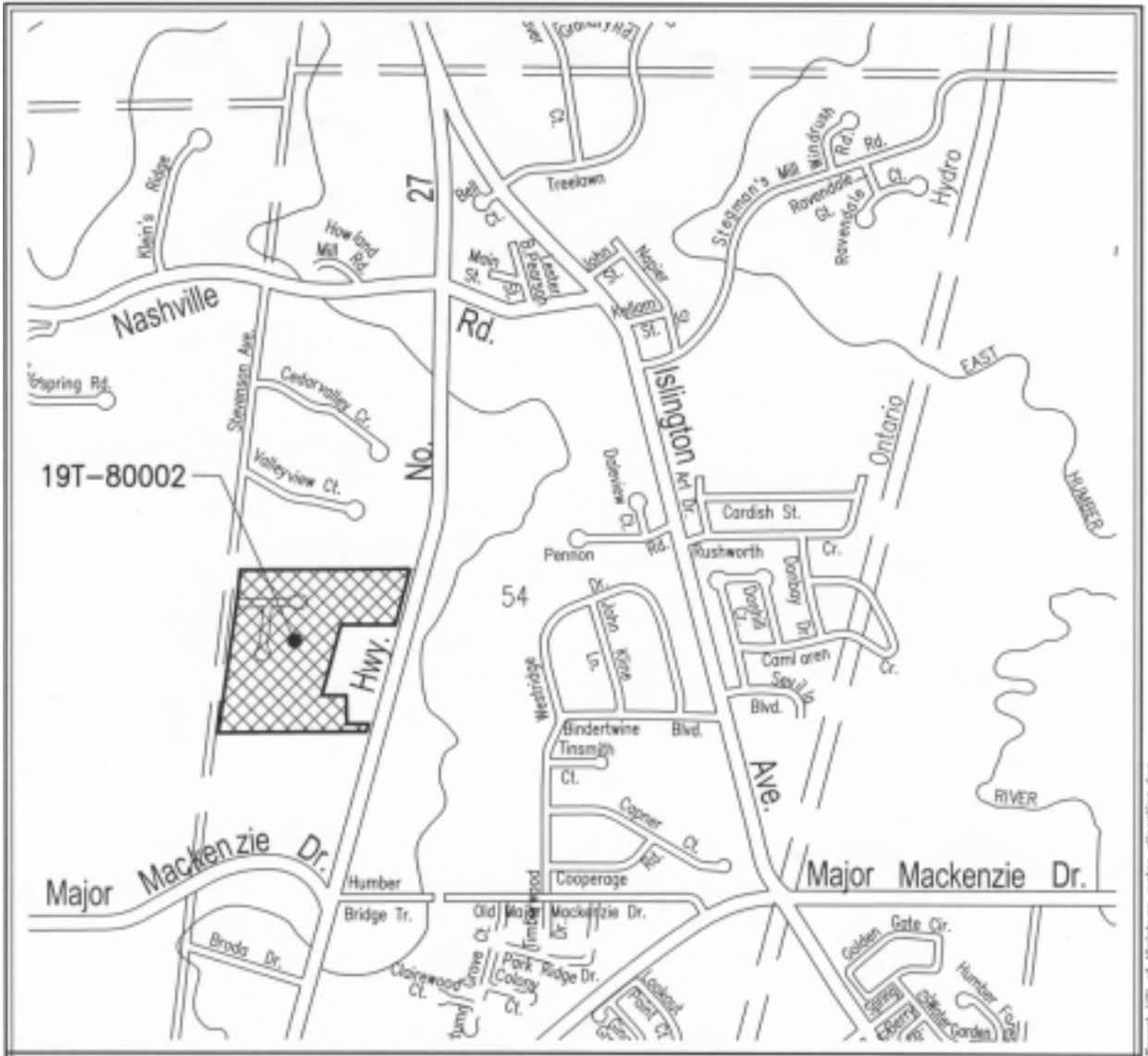

THE FOREST HILL OF KLEINBURG WATER SERVICING ALLOCATION

19T-80002

LOCATION : Part of Lot 22
Concession 8

LEGEND

 SUBJECT LANDS



NOT TO SCALE