

## **COMMITTEE OF THE WHOLE – APRIL 7, 2003**

### **ASSUMPTION - PRIMOLA CONSTRUCTION LIMITED** **PRIMOLA CONSTRUCTION LIMITED** **19T-88004\65M-3287**

#### **Recommendation**

The Commissioner of Engineering and Public Works recommends:

That the necessary by-law be passed assuming the municipal services in the Subdivision Agreement for Plan 65M-3287, and that the municipal services letter of credit be reduced to \$10,000 to guarantee payment of the Owner's contribution towards the construction of the Pine Valley Lift Station improvements.

#### **Purpose**

The Subdivision has been completed and is ready to be assumed by the City.

#### **Background - Analysis and Options**

The 34 lot development is a residential subdivision. The development is located south of Rutherford road, east of Pine Valley, as shown on Attachment 1. The Subdivision Agreement was signed on November 20, 1998. The municipal services in Plan 65M-3287 were installed in August 1998, and the top course asphalt was placed in July 2001.

All the documentation required by the Subdivision Agreement for assumption has been submitted. The Commissioner of Engineering and Public Works has received inspection clearance from all pertinent City Departments and the City Treasurer has confirmed that all of the City's financial requirements regarding this subdivision have been met.

The developer is required to contribute towards the cost of improvements to the Pine Valley Lift Station. The final costs have not been determined. When the final cost is determined and the Owner has paid his contribution, any balance will be returned to the developer.

#### **Conclusion**

It is therefore appropriate that the municipal services in 65M-3287 be assumed and the municipal services letter of credit be reduced to \$10,000.

#### **Attachments**

1. Location Map

#### **Report prepared by:**

Vick Renold, C.E.T. – Sr. Engineering Assistant, ext. 8001  
Robb Brown, Municipal Services Inspection Supervisor, ext. 8255  
Dan Stevens, P. Eng. – Manager of Engineering/Construction Services, ext. 8257

Respectfully submitted,

Bill Robinson, P. Eng.  
Commissioner of Engineering and Public Works

VR:MC

# ATTACHMENT No. 1

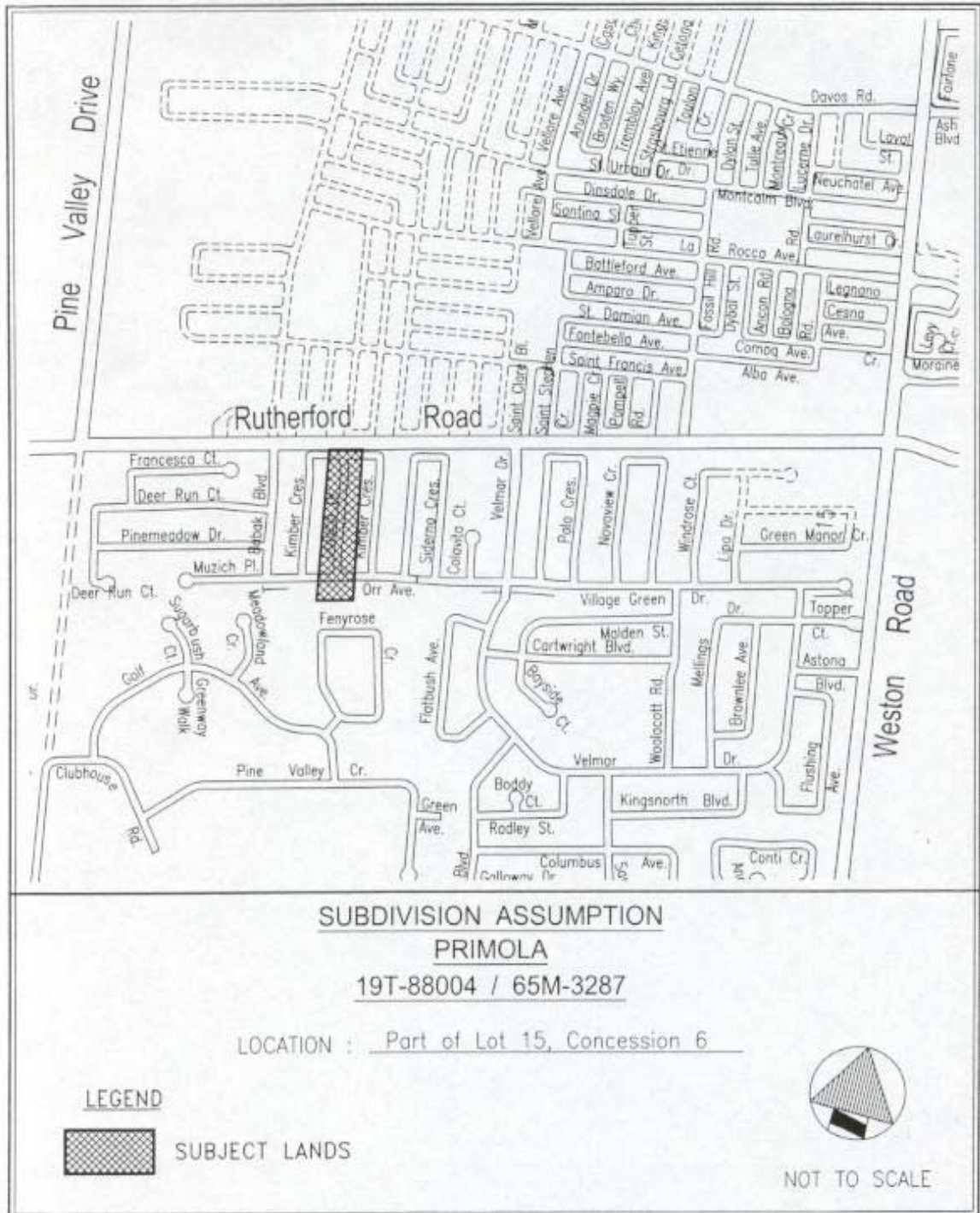

Drawing name: E:\ENG\DMIT\ENCSERV\WC\R\Assumption 2003\Primola.dwg