

COMMITTEE OF THE WHOLE – DECEMBER 11, 2006

SIGN VARIANCE APPLICATION

FILE NO: SV.06-022

OWNER: RIO CAN REAL ESTATE DEV. CO. INC.

LOCATION: 355 HIGHWAY 7, LOT 5, CONCESSION 5

Recommendation

That Sign Variance Application SV.06-022, Rio Can Real Estate Dev. Co. Inc., be APPROVED.

Economic Impact

None.

Purpose

Request to install 6 movie poster banners located on the subject building as shown on the attached drawings.

Background - Analysis and Options

By-Law Requirements (203-92, as amended)

6.2 (a) Where a site plan approved by the City provides standards for signage and the signs for the development comply therewith, such signs shall be deemed to comply with this By-Law.

Relationship to Vaughan Vision 2007

This report is consistent with the priorities previously set by Council and the necessary resources have been allocated and approved.

Conclusion

The applicant is proposing to install 6 movie poster banners on the elevations of the existing building as shown on the attached drawings.

Members of the Sign Variance Committee generally had no objections to the application as submitted. Members are of the opinion that due to the unique circumstances of the project, (Large Movie Theatre) the intent and purpose of the Sign By-Law is being maintained.

If Council finds merit in the application, a Sign Permit issued by the Building Standards Department is required prior to construction.

Attachments

1. Site Plan
2. Sketch of Sign

Report prepared by:

John Studdy, Manager of Customer & Administrative Services Ext 8232

Respectfully submitted,

John Studdy
Chair, Sign Variance Committee

/pa

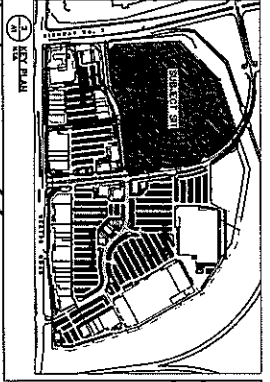
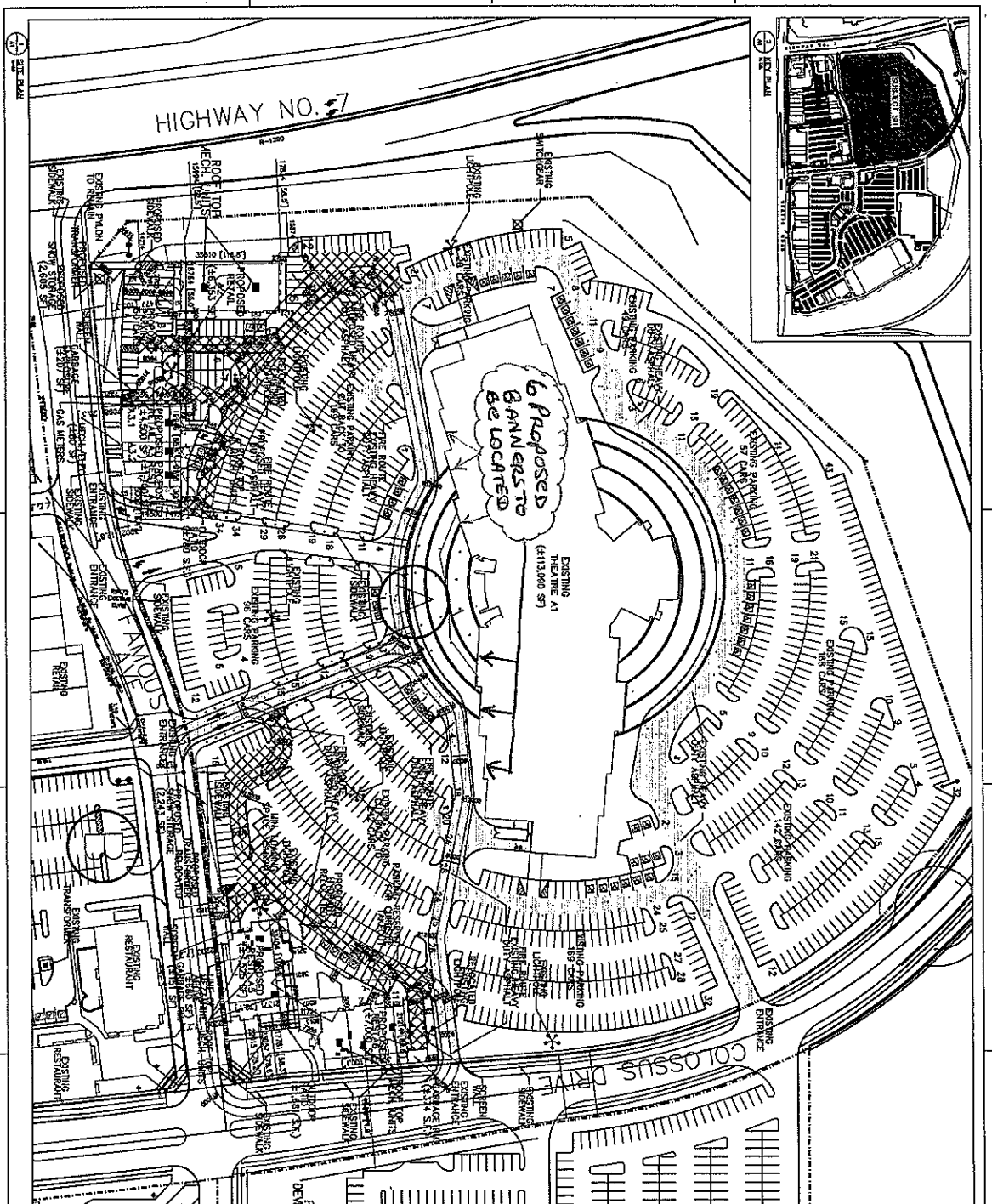

WOODBRIDGE
 Colossus Theatre
 Site Plan
 to show locations
 for 6 Proposed
 Banner Signs
 SEPT 15, 2006

STATISTICS

ITEM	AMOUNT	UNIT
TOTAL AREA	1,111,000	SQ. FT.
TOTAL BANNER AREA	12,000	SQ. FT.
TOTAL THEATRE AREA	411,000	SQ. FT.
TOTAL PARKING AREA	150,000	SQ. FT.
TOTAL RESTAURANT AREA	100,000	SQ. FT.
TOTAL OFFICE AREA	50,000	SQ. FT.
TOTAL RETAIL AREA	30,000	SQ. FT.
TOTAL OTHER AREA	20,000	SQ. FT.
TOTAL BANNER PERCENTAGE	1.1	%
TOTAL THEATRE PERCENTAGE	36.9	%
TOTAL PARKING PERCENTAGE	13.5	%
TOTAL RESTAURANT PERCENTAGE	9.0	%
TOTAL OFFICE PERCENTAGE	4.5	%
TOTAL RETAIL PERCENTAGE	2.7	%
TOTAL OTHER PERCENTAGE	1.8	%

TRINITY
 COLLOSSUS THEATRE
 WOODBRIDGE, ONTARIO

PREPARED BY: [Firm Name]
 DATE: [Date]

Proposed Banners

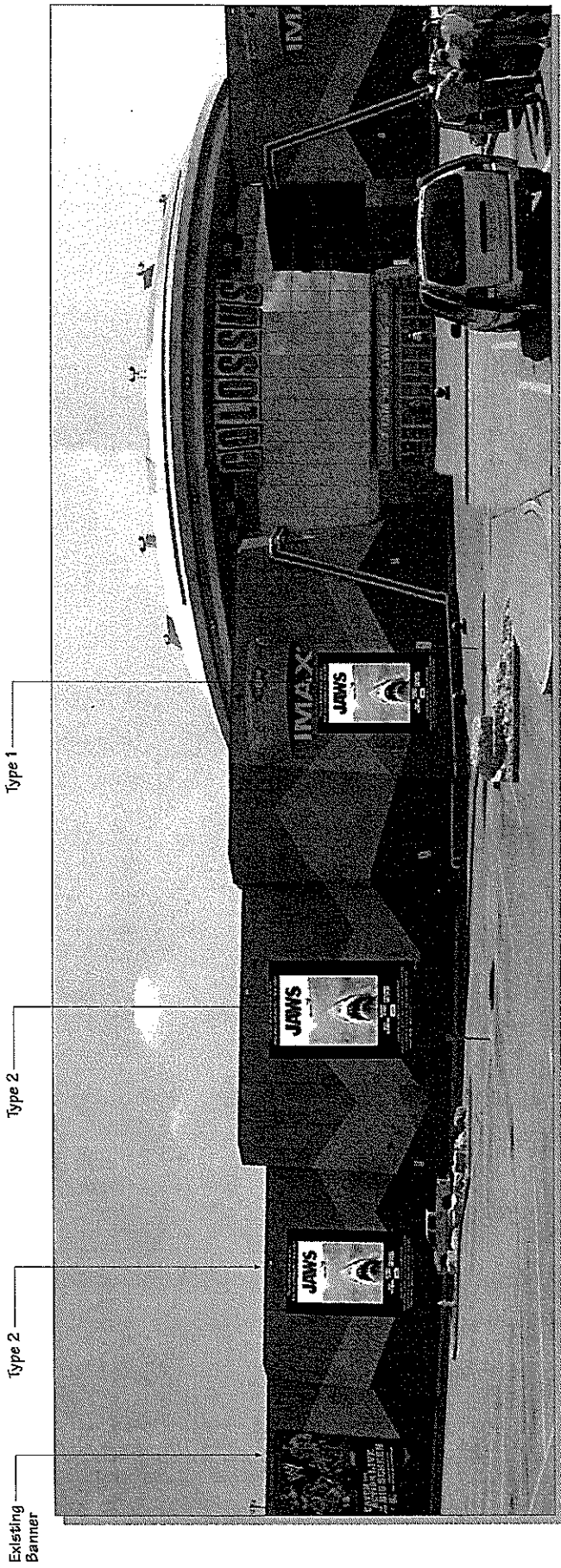

Northwest Elevation Shown • Southwest Elevation to be Mirror Layout of Northwest Elevation

This is the property of KNIGHT SIGNS
(A division of Pacific Sign Group) and is not to be
 copied in whole or in part without
 Permission by the owners

Colors shown on this presentation are
 strictly representational.



KNIGHT SIGNS®

•Project: Colossus •Address: Woodbridge On. •Contact: •Phone: •Email:
 •Sales: Doug Jackett •Date: September 14, 2006 •Production: Jennifer Falconi •File Name: 1850-07-Colossus_wdbrge-smrR1 •Revision Number 1
 •Indicate change(s): •Date released for construction
 •Approved with changes (INITIAL) •Customer Approval: •Date: •NOTE: we can not proceed without your signed approval