

COMMITTEE OF THE WHOLE – JUNE 18, 2007

COMPREHENSIVE TRAFFIC BY-LAW 284-94

Recommendation

The Commissioner of Engineering and Public Works recommends:

1. That consolidations be made to By-law 284-94, the Comprehensive Traffic By-Law to include updates to Schedule A, B, C, D, E, F, and G;
2. That Schedule E, Part 5, "School Speed Zone – 40 km/h" be added;
3. That Schedule G, Part 2, "Pedestrian Crossovers" be changed to "Intersection or Midblock Pedestrian Signals";
4. That Schedule G, Part 3, "Community Safety Zones" be added;
5. That Schedule F, Part 3, "One Way Streets" be added;
6. That Schedule F, Part 4, "Traffic Circles" be added; and
7. That various administrative amendments be made to the text of By-law 284-94 the Comprehensive Traffic By-Law.

Economic Impact

None.

Communications Plan

Engineering Staff have been in discussion with the Public Works Department and the Legal Services Department to affect these proposed changes to the Comprehensive Traffic By-law.

Purpose

To incorporate administrative amendments and consolidations in the City of Vaughan's Comprehensive Traffic By-Law 284-94 to the end of the 2006 year.

Background - Analysis and Options

The City of Vaughan's Comprehensive Traffic By-Law has had various amendments over the years. These amendments would include approved by-laws and reflect updates to the Ontario Highway Traffic Act. This is the first consolidation of this by-law since 1994.

The following Schedules are part of the Comprehensive Traffic By-law:

| | | |
|------------|--------|--|
| Schedule A | Part 1 | Pedestrian Crossing Prohibited |
| | Part 2 | Bicycles prohibited |
| Schedule B | Part 1 | Through Streets |
| | Part 2 | Multi-Way stops |
| | Part 3 | Yield Signs |
| Schedule C | Part 1 | Prohibit Heavy Trucks |
| Schedule D | Part 1 | Load Restrictions |
| Schedule E | Part 1 | Speed limit By-law – 40 km/h |
| | Part 2 | Speed limit By-law – 50 km/h |
| | Part 3 | Speed limit By-law – 60 km/h |
| | Part 4 | Speed limit By-law – 70 km/h |
| | Part 5 | Speed limit By-law – 40 km/h School Zone |
| Schedule F | Part 1 | Lane Designations |
| | Part 2 | Prohibited Turn |
| | Part 3 | One Way Street |
| | Part 4 | Traffic Circles |
| Schedule G | Part 1 | Traffic Control Signals |
| | Part 2 | Pedestrian Crossovers |
| | Part 3 | Community Safety Zones |

With the assistance of Public Works staff, Traffic staff will update the Prohibit Heavy Truck and Load Restriction by-laws to include a seasonal truck restriction on industrial roads. The by-laws pertaining to heavy vehicles will be revised to reflect the structural capacity of a roadway. The seasonal time periods will remain Springtime only specifically from March 1 through to April 30, inclusive. The heavy vehicle prohibition is intended to be year-round.

It should be noted that although the by-law will allow staff to post seasonal half loads on various roads, the posting would only be done if staff observed a need to redirect loads to avoid damage to the road infrastructure.

Many roads are posted heavy trucks prohibited year round. Some of these roads are in residential areas and are not required to be signed on the basis of no truck activity. Many of these signs were originally installed during the time of subdivision development and have remained in place. Removal of these signs will not increase heavy truck traffic through residential neighbourhoods. Attachment Nos. 1-4 graphically illustrate the revised Load Capacity Restrictions by road.

It is necessary that the schedules be updated, so that all traffic control is maintained in one comprehensive document. Some examples of the changes being made include:

- Updating to include the wording, “Pedestrian Signals”, as the by-law currently refers to Pedestrian Crossovers only.

“THAT City of Vaughan By-law 284-94 as amended, be and is hereby further amended by amending subsection 2(1) n. to read as follows:

n. “Intersection or Midblock Pedestrian Signal” means an Intersection or Midblock Pedestrian Signal as defined in the Act.”

- Updating to divide Column 2 in Section C, Part 1, from “Description” into two separate columns, “From” and “To”:

“THAT City of Vaughan By-law 284-94 as amended, be and is hereby further amended by amending subsection 7(1) to read as follows:

(1) Except as provided in Subsection (2) of this section, when official heavy truck restriction signs are erected and on display, no person shall move, drive, park or operate a heavy truck, on the highways set out in Schedule C to this by-law, Part 1, Column 1 between the limits set out between Column 2 and Column 3 of the said part”.

- Updating definitions:

“THAT City of Vaughan By-law 284-94 as amended, be and is hereby further amended by amending subsection 2(1)e to read as follows:

e. “Commissioner” means the Commissioner of Engineering and Public Works for the City or a designate.

Relationship to Vaughan Vision 2007

This report is consistent with Vaughan Vision 2007 as to review the level of enforcement, compliance, and monitoring of regulations related to public safety.

Regional Implications

Not Applicable.

Conclusion

It is recommended that Council approve the amendments and consolidations to the Comprehensive Traffic By-Law 284-94.

Attachments

1. City Map, Northwest quadrant - Heavy truck, Load Restrictions, Seasonal Load Restrictions
2. City Map, Southwest quadrant - Heavy truck, Load Restrictions, Seasonal Load Restrictions
3. City Map, Northeast quadrant - Heavy truck, Load Restrictions, Seasonal Load Restrictions
4. City Map, Southeast quadrant - Heavy truck, Load Restrictions, Seasonal Load Restrictions

Report prepared by:

Leslie Winfrow, Senior Traffic Technologist, ext. 3131
Mike Dokman, Supervisor Traffic Engineering, ext. 3118

Respectfully submitted,

Bill Robinson, P. Eng.
Commissioner of Engineering and Public Works
LW:mc

Gary P. Carroll, P. Eng.
Director of Engineering Services

ATTACHMENT No. 1

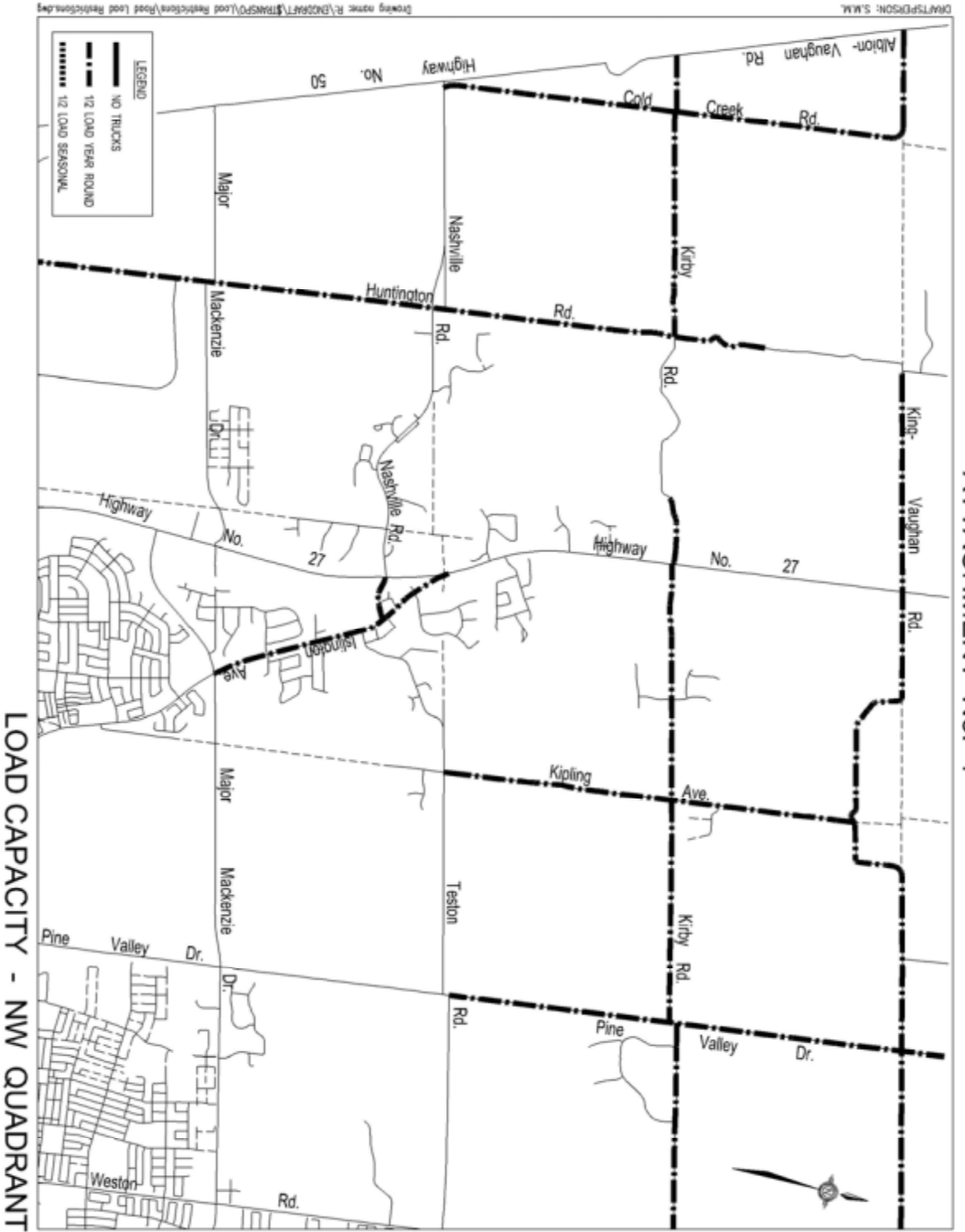

LOAD CAPACITY - NW QUADRANT

DRAWN BY: S.M.M. Drawing name: R:\ENOS\BATT\TRMS\F0\Load Restrictions\Road Load Restrictions.dwg

ATTACHMENT No. 2

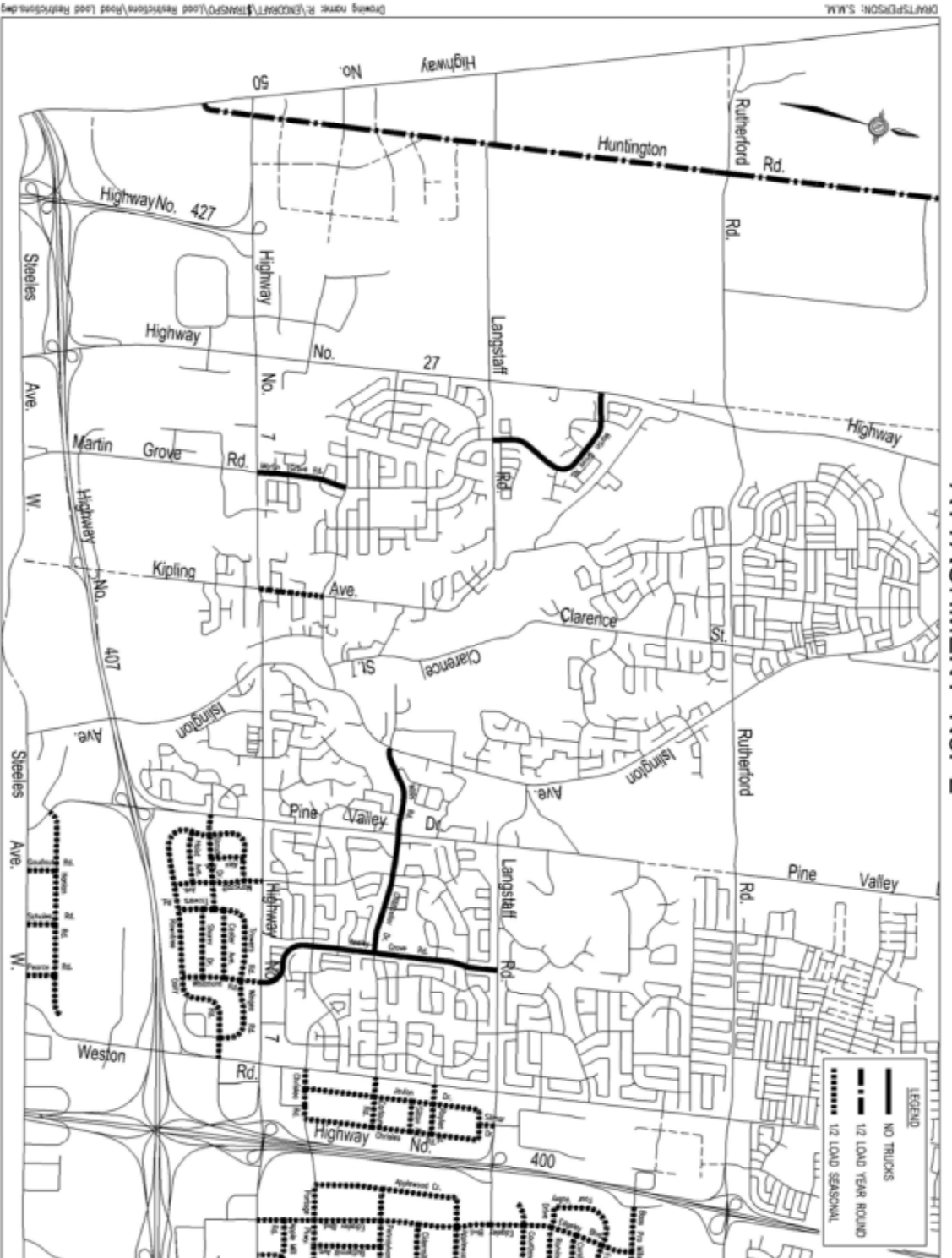

LOAD CAPACITY - SW QUADRANT

ATTACHMENT NO. 3

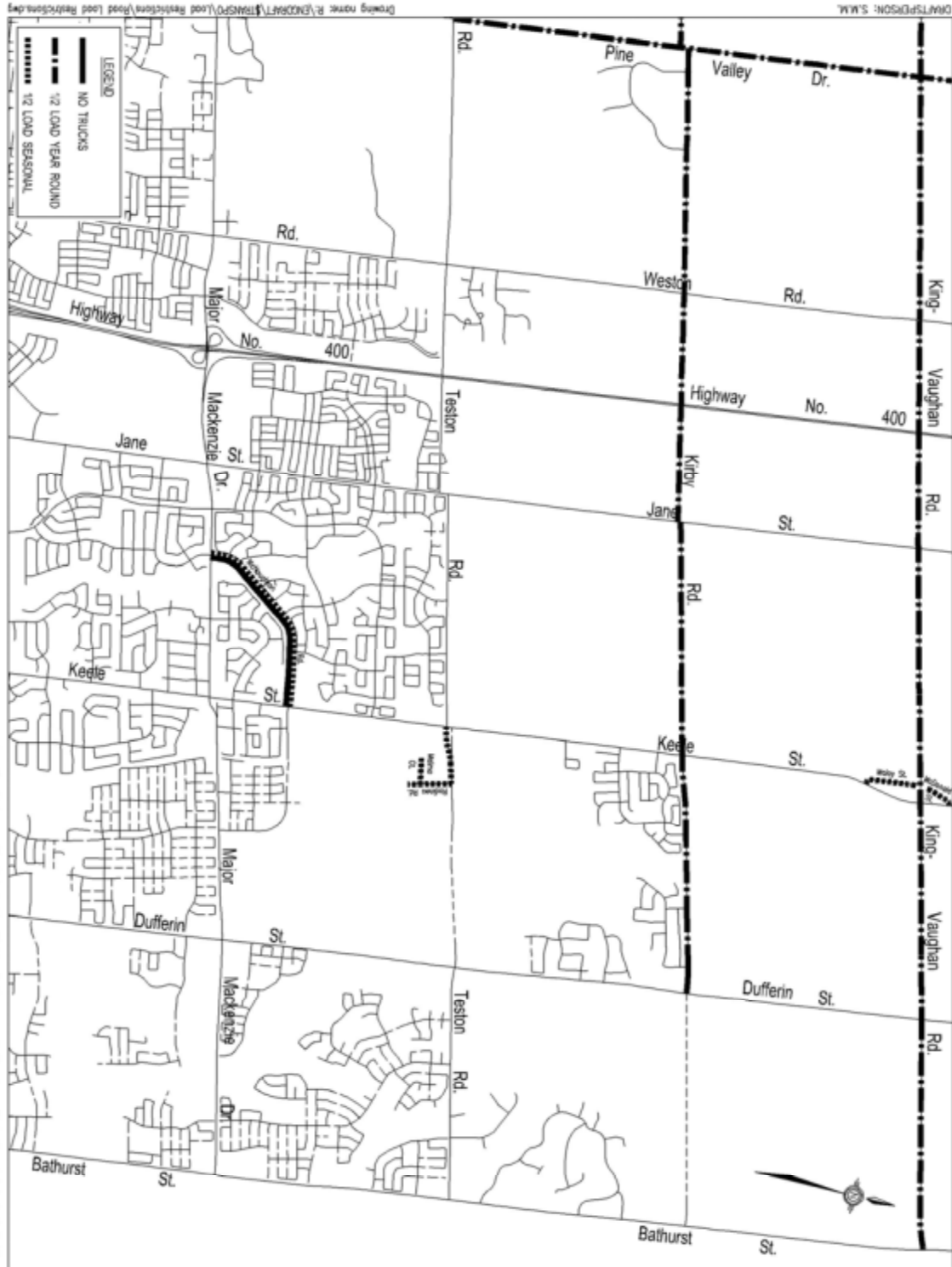

LOAD CAPACITY - NE QUADRANT

ATTACHMENT NO. 4

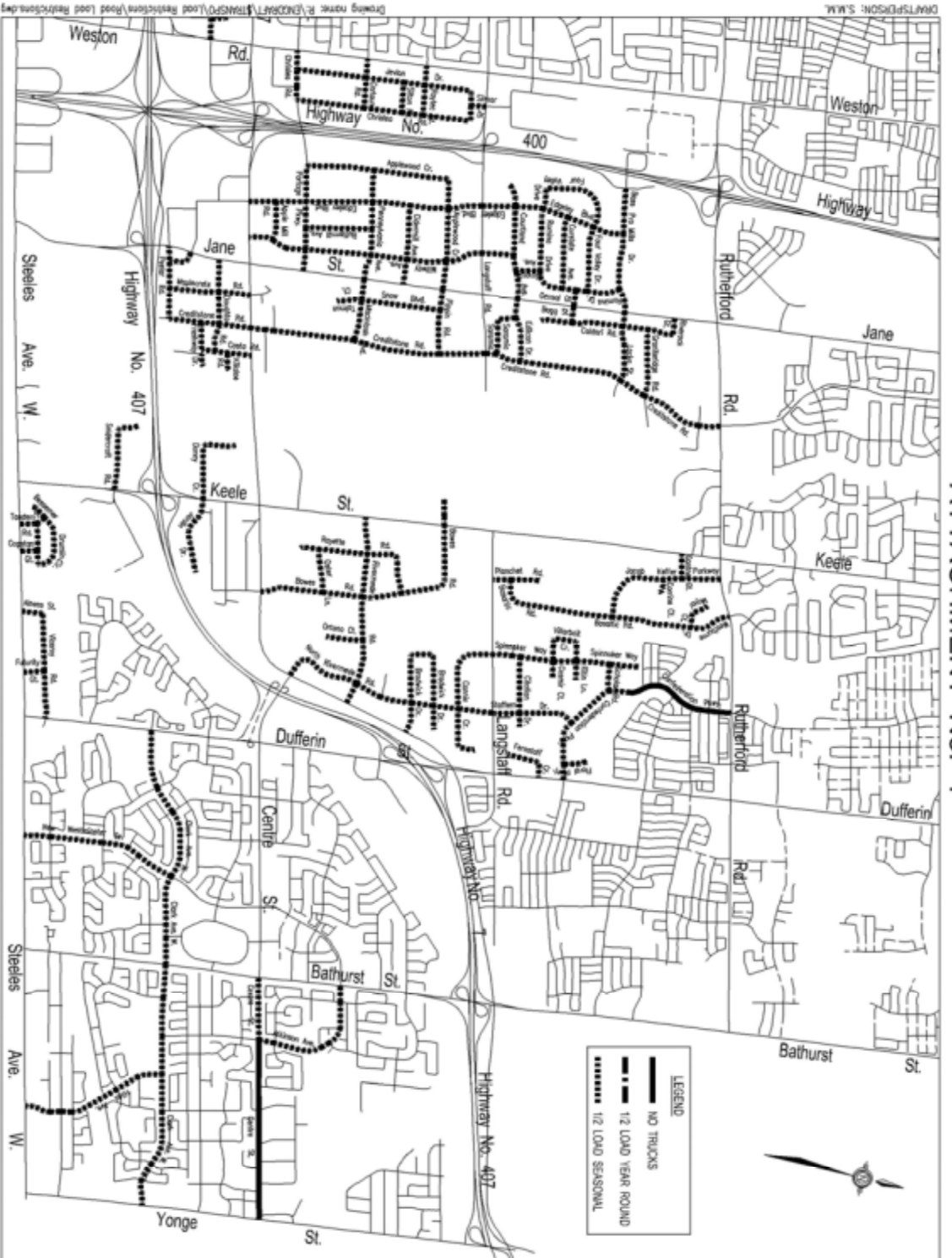

LOAD CAPACITY - SE QUADRANT

DRAFTSPERSON: S.M.M. Drawing name: R:\ENDORSE\TRANSPO\Load Restrictions\Road Load Restrictions.dwg