

**COMMITTEE OF THE WHOLE SEPTEMBER 4, 2007**

**SIGN VARIANCE APPLICATION**

**FILE NO: SV.07-013**

**OWNER: JOY RABIDEAU**

**LOCATION: 252 BASS PRO MILLS DRIVE, UNIT 502  
BLOCK 1, REGISTERED PLAN 65M-3696**

**Recommendation**

That Sign Variance Application SV.07-013, Joy Rabideau, be APPROVED.

**Economic Impact**

None.

**Communications Plan**

The results of this application will be communicated to the applicant through the Secretary to the Sign Variance Committee.

**Purpose**

Request to install an additional wall sign at the rear of the building of the subject property as shown on the attached drawings.

**Background - Analysis and Options**

6.2 (a) Where a site plan approved by the City provides standards for signage and the signs for the development comply therewith, such signs shall be deemed to comply with this By-Law.

**Relationship to Vaughan Vision 2007**

This report is consistent with the priorities previously set by Council and the necessary resources have been allocated and approved.

**Regional Implications**

Region of York Engineering approval is not required for the proposed signs.

**Conclusion**

The applicant is proposing to install an additional wall sign at the rear of the building as shown on the attached drawings.

Sign Variance Committee members have no objections to the application as submitted, and are of the opinion that the intent and purpose of the Sign By-law is being maintained.

If Council finds merit in the application, a Sign Permit issued by the Building Standards Department is required.

**Attachments**

1. Site Plan
2. Sketch of Sign

**Report prepared by:**

John Studdy, Manager of Customer & Administrative Services Ext 8232

Respectfully submitted,

John Studdy  
Chair, Sign Variance Committee

/pa

FOR OFFICE USE ONLY

CITY OF VAUGHAN  
BUILDING STANDARDS DEPARTMENT  
PLANS EXAMINATION

RECEIVED  
MUNICIPALITY OF VAUGHAN

FOR REFERENCE ONLY

08/07

ZONING  
GRADING  
PLAN  
MECHANICAL  
PLUMBING

Proposed  
Signs

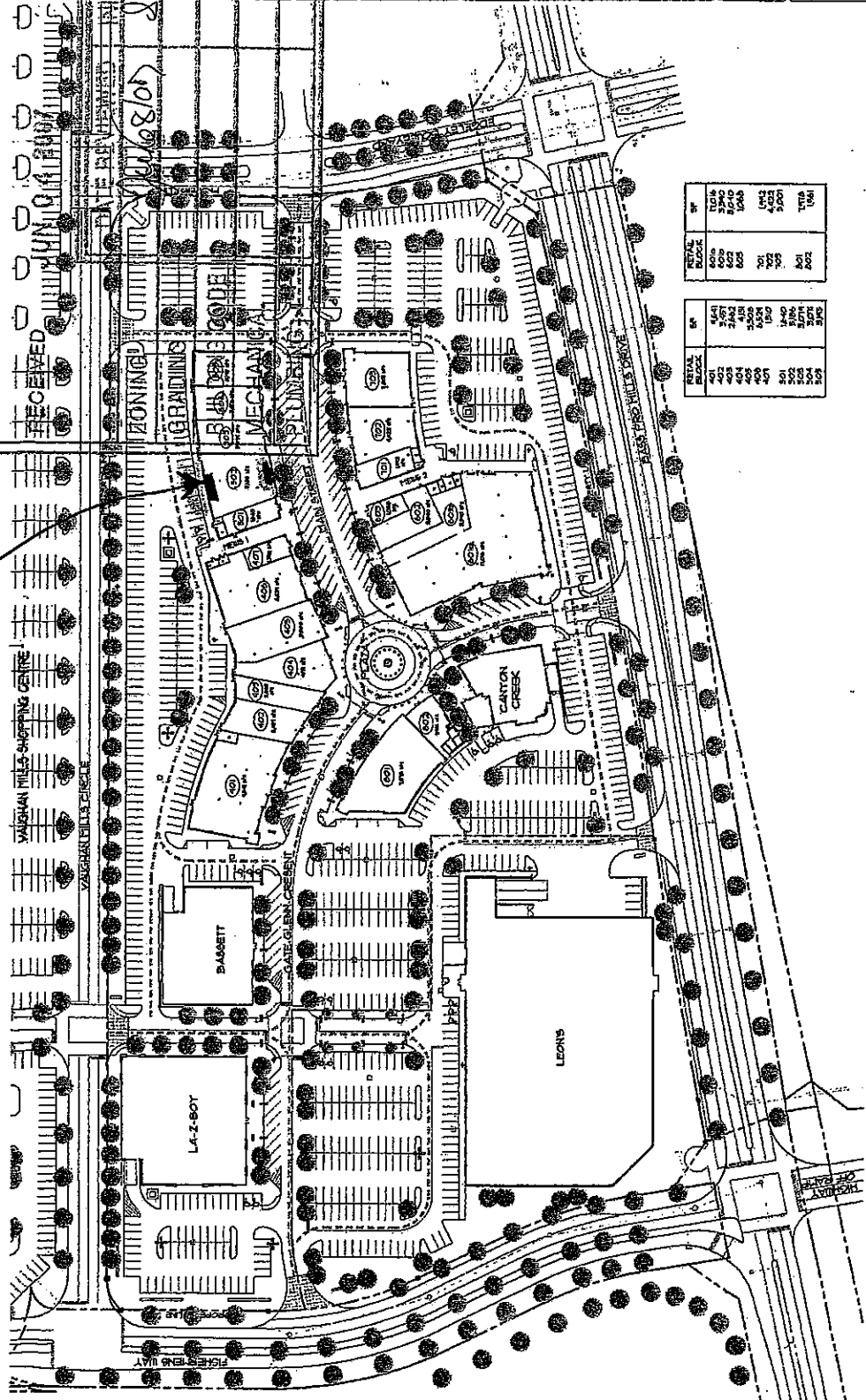

BLK	SP	SP	SP
401	441	1040	1040
402	402	2040	2040
403	403	408	408
404	404	816	816
405	405	1632	1632
406	406	3264	3264
407	407	6528	6528
501	501	1040	1040
502	502	2040	2040
503	503	408	408
504	504	816	816
505	505	1632	1632
506	506	3264	3264
507	507	6528	6528

↑

Drawn by: [ ]  
 Checked by: [ ]  
 Prepared by: [ ]

**Bacor Village  
at  
Vaughan Mills**  
Vaughan, Ontario

By  
**Salogham  
Developments Limited**

Overall Leasing Plan

drawing no.  
**LPI-1**

CELLOR  
INCORPORATED

Scale: 1/8" = 1'-0"  
 1/4" = 1'-0"  
 1/2" = 1'-0"  
 3/4" = 1'-0"  
 1" = 1'-0"

OFFICE COPY  
07-347



front Elev.

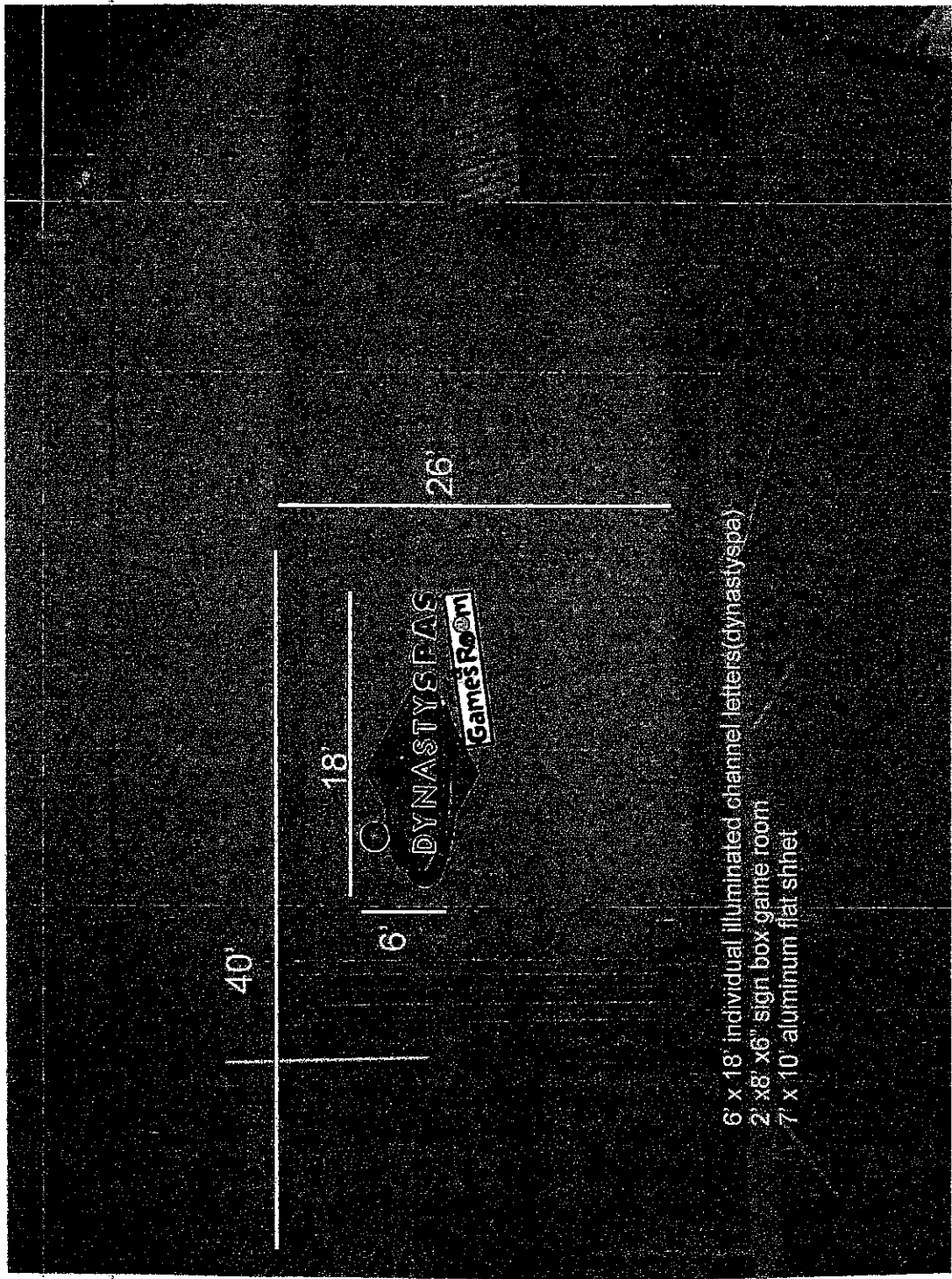

- 6' x 18' individual illuminated channel letters (dynastyspa)
- 2' x 8' x 6" sign box game room
- 7' x 10' aluminum flat sheet

*Back Elev.*