

COMMITTEE OF THE WHOLE – MAY 11, 2010

SIGN VARIANCE APPLICATION

FILE NO: SV.10-003
OWNER: RIO CAN
LOCATION: 7601 WESTON ROAD
LOT 5, CONCESSION 5
WARD 3

Recommendation

The Sign Variance Committee recommends:

That Sign Variance Application SV.10-003, Rio Can, be approved as per the sign proposed at the south and west elevations subject to the sign on the south elevation being moved lower to align with the sign across the street.

Contribution to Sustainability

N/A

Economic Impact

None.

Communications Plan

The results of this application will be communicated to the applicant through the Secretary to the Sign Variance Committee.

Purpose

Request to install a wall sign on the south and west building face of the subject property as shown on the attached drawings.

Background - Analysis and Options

Bylaw Requirements (203-92, as amended):

6.2 (a) Where a site plan approved by the City provides standards for signage and the signs for the development comply therewith, such signs shall be deemed to comply with this By-Law.

Noting the above, where the property is regulated by a site plan agreement approved by the City, only those wall signs and pylon signs approved under the site plan agreement are deemed to be permitted by the City's Sign By-Law.

Relationship to Vaughan Vision 2020/Strategic Plan

This report is consistent with the priorities previously set by Council and the necessary resources have been allocated and approved.

Regional Implications

Region of York Engineering approval is not required for the proposed signs.

Conclusion

The applicant is proposing to install a wall sign on the south and west building face as shown on the attached drawings. (Proposed Sign Areas: West Elevation - 12 sqm. or 128 sqft. & South Elevation - 12 sqm. or 128 sqft.)

Members of the Sign Variance Committee have no objections to the application subject to the proposed sign for the south building elevation being lower to align with the sign across the street.

If Council finds merit in the application a Sign Permit issued by the Building Standards Department is required.

Attachments

1. Site Plan
2. Sketch of Sign (2)

Report prepared by:

John Studdy, Manager of Customer & Administrative Services Ext 8232

Respectfully submitted,

John Studdy
Chair, Sign Variance Committee

/pa

SV.10-003.

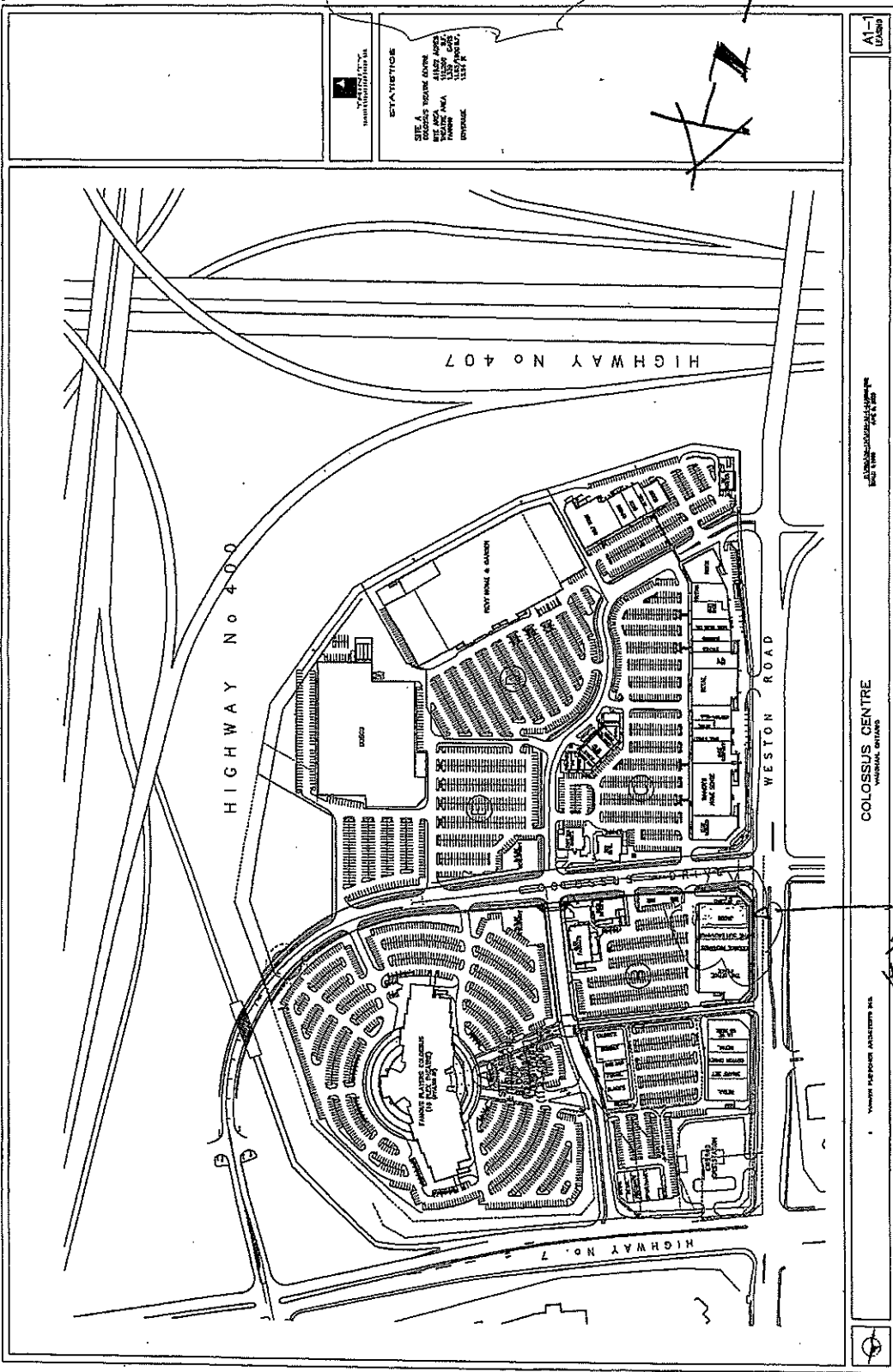

UNIVERSITY OF TEXAS AT DALLAS

STATISTICS
 STUDY TITLE: COLLOSSUS CENTRE
 STUDY AREA: COLLOSSUS CENTRE
 STUDY DATE: 1988
 STUDY PERIOD: 1988
 STUDY TYPE: SITE PLAN

A1-1000

COLLOSSUS CENTRE
WESTON CENTRE

UNIVERSITY OF TEXAS AT DALLAS



SV-10-003

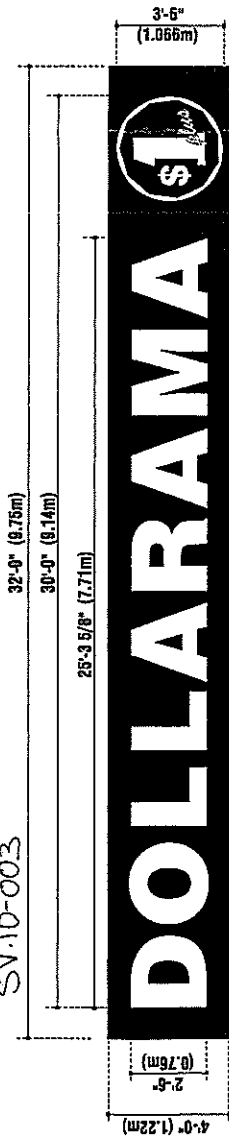

Sign Elevation **ONE SET OF LOGO AND ILLUMINATED CHANNEL LETTERS ON ALUMINUM BOX**
 Scale: 1/4" = 1'-0"

INDIVIDUAL CHANNEL LETTERS

One (1) set of individual channel letters and
 One (1) logo on Aluminum Panel painted green Dollarama, installed on wall.
 Sides of letters painted green Dollarama with
 1" black "Syvatium"
 3/16" thick, yellow pigmented acrylic diffuser faces
 Logo graphic with green vinyl on first surface
 Illuminated with Mega White LEDs and transformers in each letter

Green Vinyl #3630-76 / Painted Green Dollarama

SIGN WEIGHT: 300 lbs

LETTERS & LOGO SUPERFICIES

2'-5" x 25'-3 5/8" = 63.25 s.f. / 5.87 m²
 3'-5" x 3'-6" = 12.25 s.f. / 1.13 m²
 Total superificy: 75.5 s.f. / 7 m²

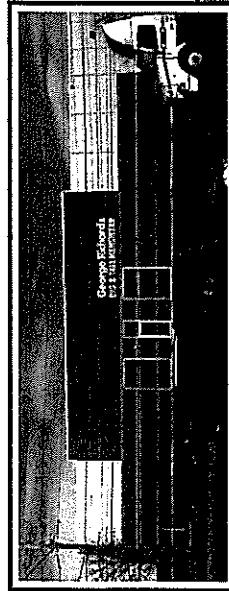
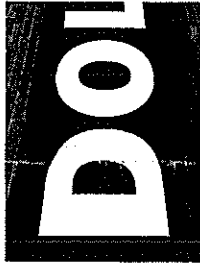

WEST ELEVATION

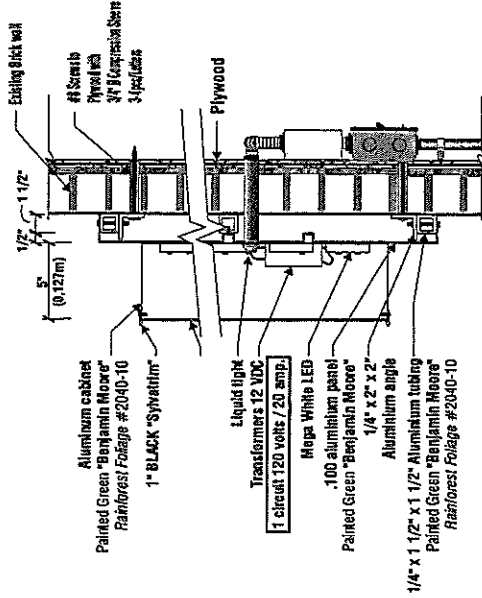

Typical Cross Section
 Scale: N.L.S.

NOTE:
 1. DOMINION SIGNS retains sole title to all royalties of the attached work and reserves exclusive rights to producer or copy for each work, whether or in part, in any material format.

2. Colors illustrated in this drawing may differ from those produced from watching, or reproducing charts for exact shades.

OWNER:
 DOLLARAMA

ADDRESS:
 10-17 Columbus Drive
 (Blanca Coliseum Center)
 Yaghas, ON

DATE:
 06/17/2009

REVISED:
 07/13/2009
 Monthly Detail 10/12/09 M.D.
 14/01/2010 (N.T.)
 12/03/2010 (N.T.)

SCALE:
 AS SHOWN

DESIGNER:
 CALVIN HERBERT/ARTS

ARTIST:
 PIERRE LACHANCE

DESIGNER:
 ROSALIE HAMELIN

DRAWING #:
 004-264-R3

QUOTE #:
 21,041

PAGE:
 4/6

DOMINION SIGNS
 1000 SHEPPARD AVENUE EAST
 MONTREAL, QUEBEC
 H3A 2B4
 Tel.: 1-800-653-7449 - Fax: (514) 244-1192

SIGN LOCATION

Propo Sign

SV-10-003

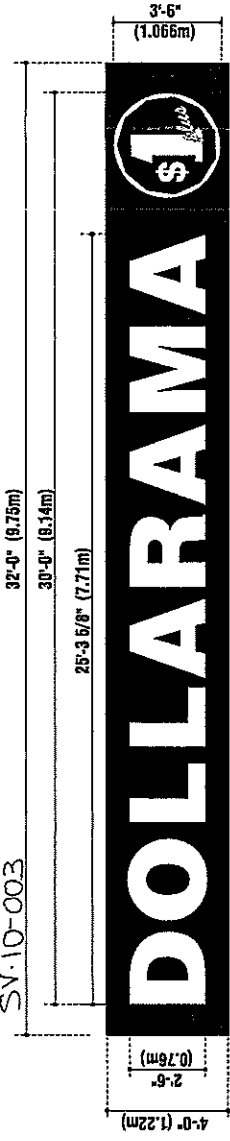

DOLLARAMA

SIGN WEIGHT: 300 lbs

LETTERS & LOGO SUPERFICY
 2'-6" x 25'-3 5/8" = 63.25 s.f. / 5.87 m²
 3'-6" x 3'-6" = 12.25 s.f. / 1.13 m²
Total superfiery: 75.5 s.f. / 7 m²

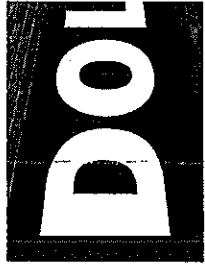

3D PRESENTATION

Sign Elevation Scale: 1/4" = 1'-0"
B ONE SET OF LOGO AND ILLUMINATED CHANNEL LETTERS ON ALUMINUM BOX

INDIVIDUAL CHANNEL LETTERS

One (1) set of individual channel letters and
 One (1) logo on Aluminum Panel painted green Dollarama. Installed on wall.
 Sides of letters painted green Dollarama with
 1" black "Sylvahtim"
 3/16" thick, yellow pigmented acrylic diffuser faces
 Logo graphic with green vinyl on first surface
 Illuminated with Mega white LEDs and transformers in each letters

Green Vinyl #3630-76 / Painted Green Dollarama

Proposed Sign



SIGN LOCATION

South BURBANK

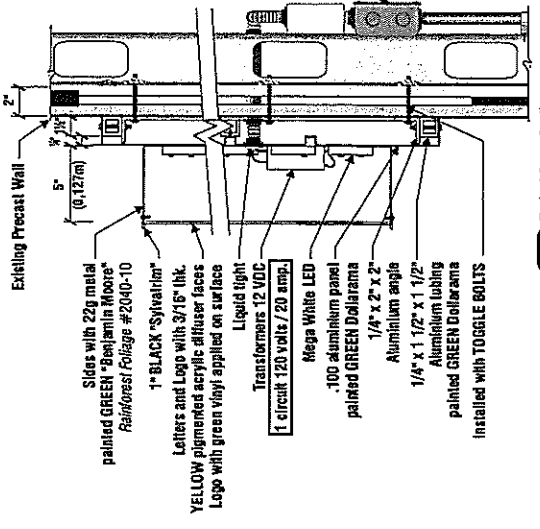

Typical Cross Section
 Scale: n.l.s.

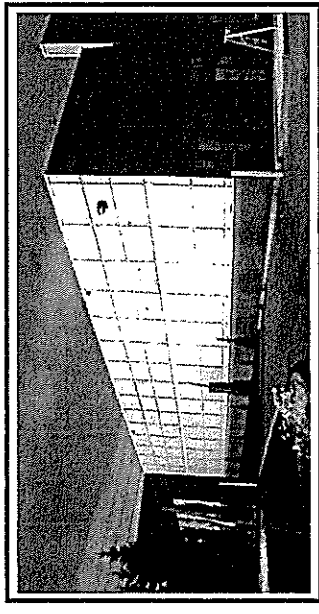

EXISTING

NOTE:
 1. DOMINION SIGNS retains sole title to all copyrights of the attached work and reserves exclusive rights to produce or copy on each work, wholly or in part, in any material format.

2. Colors illustrated in this drawing may differ from those printed in our work sheet. Please refer to the corresponding colors for exact shade.

COMPONENTS
 DOLLARAMA
ADDRESS:
 16-57 Colarus Drive
 (Riverside Colarus Center)
 Vuyshan, OH
DATE:
 06/17/2009

REVIEWS:
 07/13/2009
 Mounting Detail 16/12/09 M.D.
 14/01/2010 (N.T.)
 12/03/2010 (N.T.)

SCALE:
 AS SHOWN
PAUSE NUMBER:
 PIERRE LACHANCE
DESIGNER:
 ROSALIE HAMELIN
DRAWING #: 004-264-R3
QUOTE #: 21_040
PAGE: 2/6

DOMINION SIGNS
 16000 W. 24th Ave. Suite 100
 Fort Collins, CO 80504
 Phone: 970-226-4422 Fax: 970-226-4422