

**COMMITTEE OF THE WHOLE JUNE 4, 2001**

**SIGN VARIANCE APPLICATION**

**FILE NO.:** SV.01-012

**OWNER:** TRINITY DEVELOPMENT

**LOCATION:** 200 WINDFLOWER GATE, UNIT 500-501.  
LOT 6, CONCESSION 6

---

**Recommendation**

The Sign Variance Committee recommends:

That Sign Variance Application SV.01-012, Trinity Development, be APPROVED.

**Purpose**

Applicant is requesting to install two signs in an approved sign variance location except these signs are different dimensions than previously approved.

**Background - Analysis and Options**

**By-law Requirements (203-92 as amended)**

Sign variance approved sign location to be partially above roof line. Sign face measures 5.2m x 1.83m, total sign face 9.52m<sup>2</sup>.

**Conclusion**

Applicant is requesting to install the signs in the same location. The "GAP" sign measures 2.74m x 2.74m, sign face area 7.51m<sup>2</sup>. The "OUTLET" sign measures 2.74m x .41m, sign face area 1.12m<sup>2</sup>. The total of both sign faces are 8.63m<sup>2</sup>.

**Attachments**

1. Sketch of Sign

**Report prepared by:**

John Studdy, Manager of Customer & Administrative Services

Respectfully submitted,

John Studdy  
Chair, Sign Variance Committee

/pa

REVISIONS

DATE: 10/10/00  
BY: [Signature]  
DESCRIPTION: [Text]

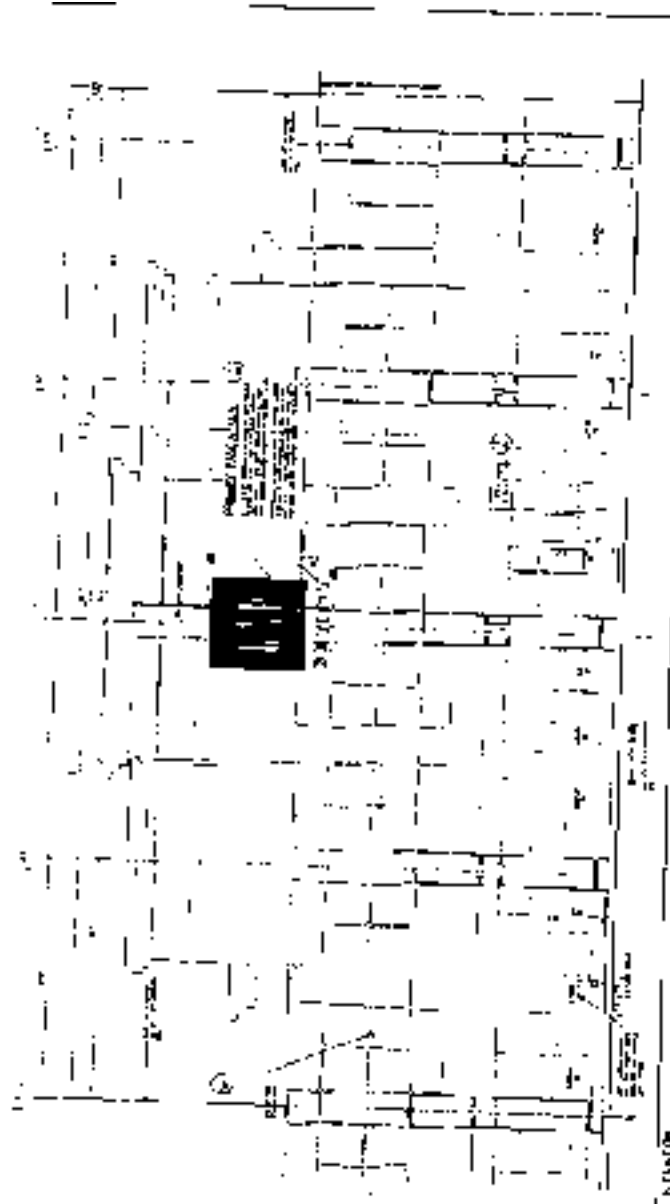

SCALE: 1/8" = 1'-0"  
DATE: 10/10/00  
BY: [Signature]  
PROJECT: [Text]  
SHEET: [Text]