

COMMITTEE OF THE WHOLE – JUNE 3, 2002

CITY WORKS IN REGION OF YORK CONTRACT
DUFFERIN STREET DETAILED DESIGN – RUTHERFORD RD. TO MAJOR MACKENZIE DR.

Recommendation

The Commissioner, Development Services in consultation with the Director of Purchasing Services recommends:

That notwithstanding the Purchasing Policy, the City retain the Region of York's Consultant, Trow Consulting Engineers Ltd., for the design of the sidewalk and street-lighting on both sides of Dufferin Street from Rutherford Road to Major MacKenzie Drive at an estimated cost of \$38,000 plus G.S.T.

Purpose

To include the design for the sidewalk and illumination in the Region of York project for reconstruction of Dufferin Street from Rutherford Road to Major MacKenzie Drive.

Background - Analysis and Options

The Region of York is presently finalizing the design for the reconstruction of Dufferin Street between Rutherford Road to Major MacKenzie Drive. It would be advantageous and cost effective for the City to include the design of sidewalk and street-lighting on Dufferin Street from Rutherford Road to Major MacKenzie Drive in the Region's design.

The Region's Consultant, Trow Consulting Engineers Ltd., estimated their fees for the design of the sidewalk and street-lighting to be \$38,000 plus G.S.T. Funding has been approved in the 2002 Capital Budget Project No. 1472.0 for the design of sidewalks and street-lighting (funded from City Wide Development Charges).

Conclusion

It is cost effective to retain the Region's Consultant, Trow Consulting Engineers Ltd. to design the sidewalk and street-lighting for the City due to their involvement in the Region's road reconstruction project.

Attachments

1. Location Map

Report prepared by:

Tom Ungar, P.Eng. Sr. Engineering Assistant, ext. 8263
Frederick Lam, P. Eng. – Design Engineer, Ext. 8638
Dan Stevens, P. Eng. – Manager of Engineering/Construction Services, ext. 8257

Respectfully submitted,

FRANK MIELE
Commissioner, Development Services

TU:FL

Bill Robinson, P. Eng.
Executive Director of City Engineering
and Public Works

ATTACHMENT No. 1

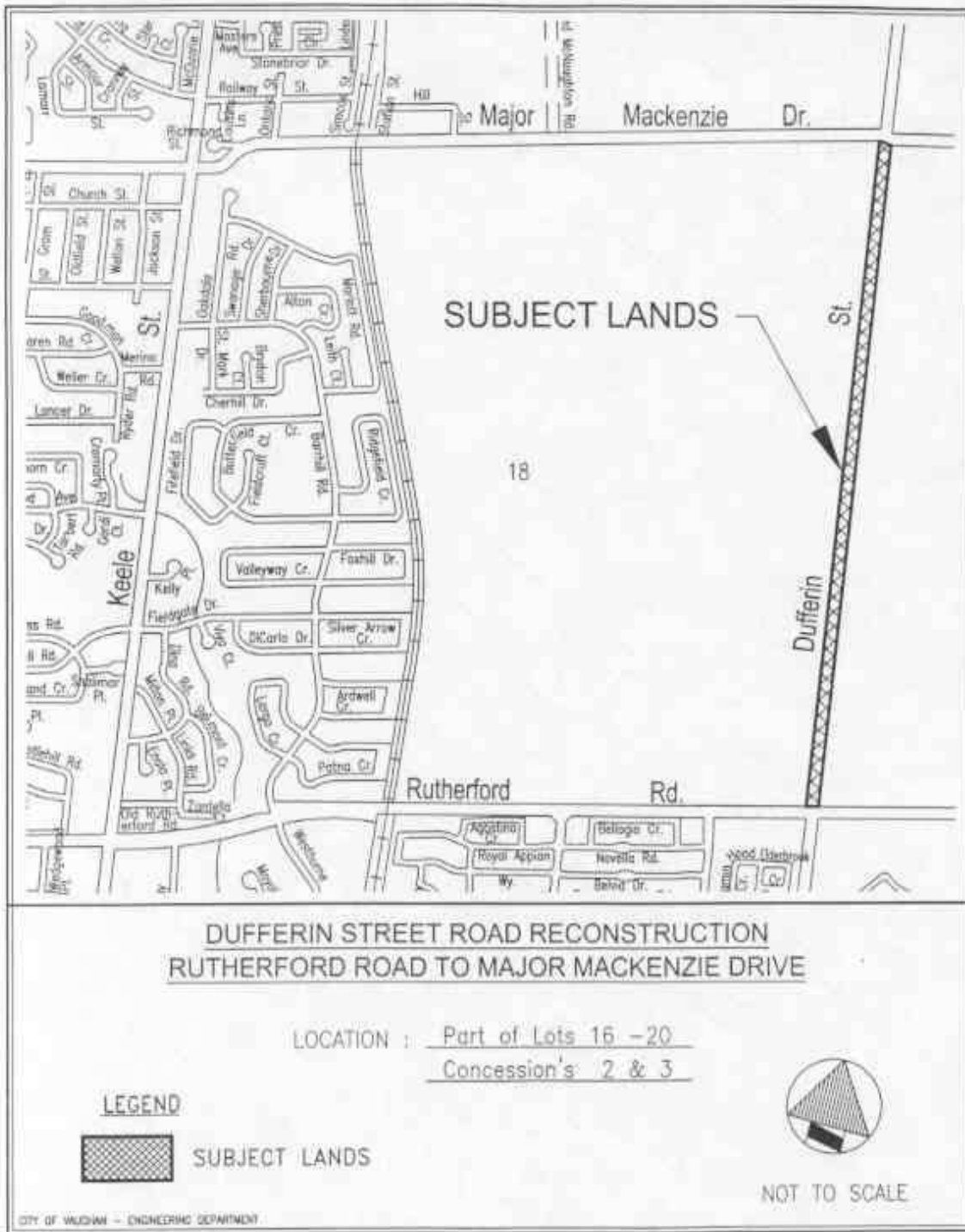

Drawing name: R:\Disciplines\Engineering\Road\ATTACHMENT\Dufferin St.dwg