

COMMITTEE OF THE WHOLE JANUARY 6, 2003

SIGN VARIANCE APPLICATION

FILE NO.: SV.02-031

OWNER: ACUMEN INVESTMENTS LIMITED

LOCATION: 1000 ROWNTREE DAIRY ROAD, LOTS 1 AND 2

REGISTERED PLAN NOS. 65M-2167 AND 65M-2333, CONCESSION 6

Recommendation

The Sign Variance Committee recommends:

That Sign Variance Application SV.02-031, Acumen Investments Limited, be APPROVED subject to the Sign By-law permitting three (3) ground signs on the lot.

Purpose

Applicant is requesting to install one (1) additional free standing pylon (identity) sign for Petro Canada.

Background - Analysis and Options

By-Law Requirements (203-92, as amended)

Section 6 – General Provisions For All Signs

- 6.1 (i) Limit on Number of Signs
One (1) ground sign per lot
- (iii) Where a lot abuts two or more streets an additional ground sign may be erected on each street frontage provided that said street has a minimum frontage of 15.0m.
- 6.2 Compliance with Site Development Agreements
 - (a) Where a site plan approved by the City provides standards for signage and the signs for the development comply therewith, such signs shall be deemed to comply with this By-law.

Conclusion

Applicant is requesting to install one (1) additional pylon sign that was not previously approved under site plan approval. The sign measures 7.82m² per sign face area and height measures 6.858m. Sign area and height complies to the sign by-law.

Attachments

1. Sketch of Sign

Report prepared by:

John Studdy, Manager of Customer & Administrative Services

Respectfully submitted,

John Studdy
Chair, Sign Variance Committee

/pa

HIGHWAY 7

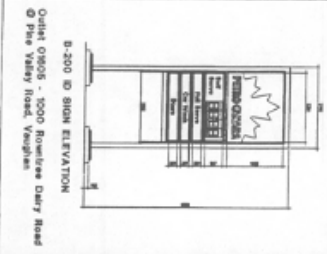
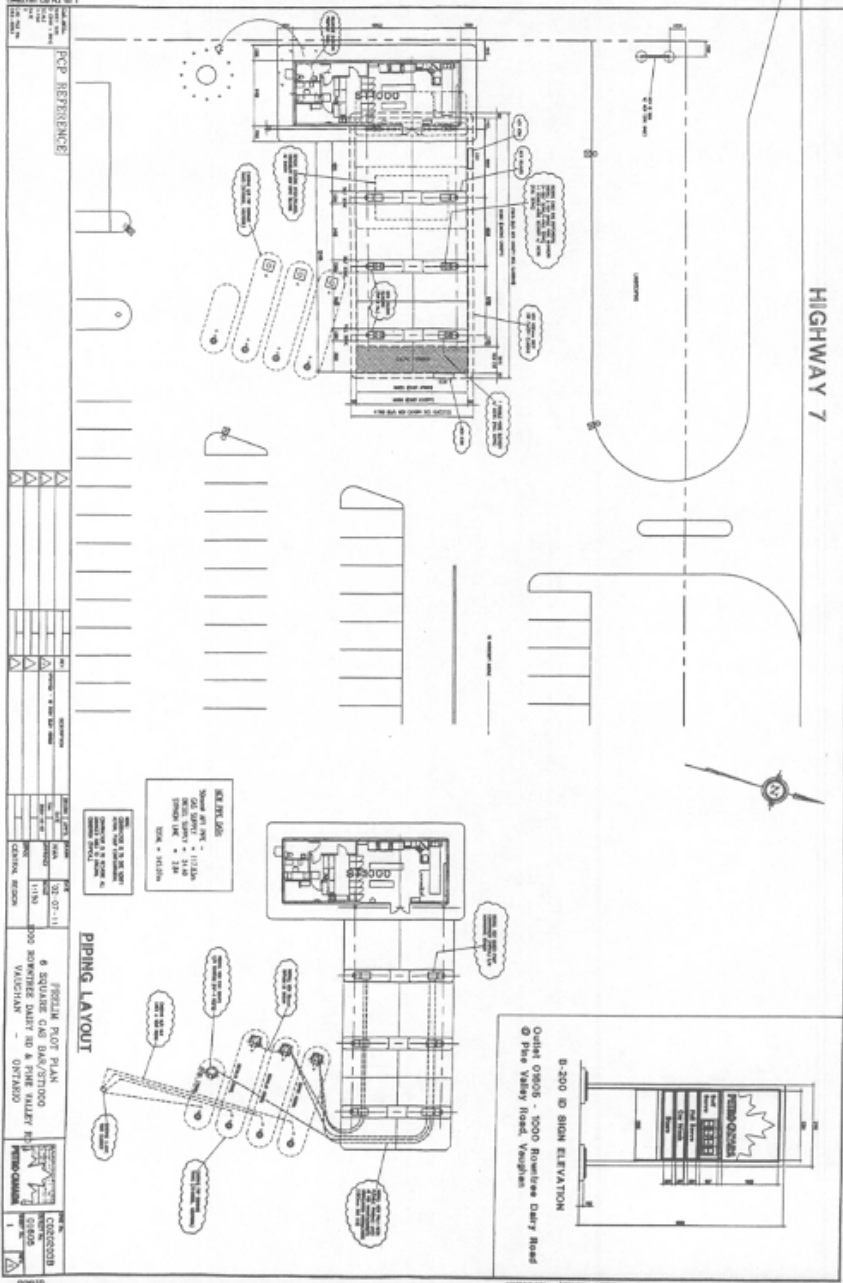

ELEV. JOB
 TOTAL OF PIPES - 1012.00
 GAS SERVICE - 1012.00
 3" DIA. PIPES - 13.00
 TOTAL - 1025.00

PIPING LAYOUT

PCP REFERENCE

NO.	DESCRIPTION	DATE	BY	CHECKED
1	ISSUED FOR PERMITS	07-11		
2	6 SQUARE GAS DUCT/STOVE			
3	2000 ROWEFLOW DAIRY RD & PINE VALLEY RD			
4	VAUGHAN - ONTARIO			

CONTRACT NO. 010005