

COMMITTEE OF THE WHOLE – JUNE 8, 2005

VELLORE WOODS PROPOSED ALL-WAY STOP CONTROL

Recommendation

Councillor Peter Meffe recommends:

THAT all-way stop controls be installed at the following intersections:

1. Ashberry Boulevard and Starling Boulevard;
2. Ashberry Boulevard and Fox Hound Crescent and Wheatfield Drive;
3. Vellore Woods and Wildberry Crescent;
4. Vellore Woods Boulevard and Bucksaw Drive; and
5. Vellore Woods Boulevard and Timerland Drive

AND THAT Staff establish a Neighbourhood Traffic Control Committee to convene in the fall of 2005 to further review traffic issues in Vellore Woods.

Purpose

To reduce speed and improve traffic safety in the Vellore Woods area.

Background - Analysis and Options

The Vellore Woods Ratepayers together with a number of residents met at my office with regards to speeding and accident concerns in the Vellore Woods area. Currently there are stop signs located along Vellore Woods Boulevard at Johncrest Way, Hawkview Boulevard and Ashberry Boulevard which is an almost two kilometre distance. As well currently there are no stop signs located along Ashberry Boulevard which is the main east-west roadway. As this subdivision is now built out installation and review of traffic control measures is appropriate.

Relationship to Vaughan Vision 2007

This report is consistent with the priorities previously set by Council and the necessary resources have been allocated and approved.

Conclusion

The installation of these all-way stop controls will improve community safety and control speeding vehicles.

Attachments

Map indicating proposed all way stop control locations.

Report prepared by:

Respectfully submitted,
Councillor Peter Meffe

A

B C8

C

- A3 X HIGH CRESCENT
- A2 X LOUKE STREET
- C3 W LOVE RUN ROAD
- A3 X MORRIS DRIVE
- C1 X NATIONAL PINE DRIVE
- B2 Z MINACOR AVENUE
- B4 Y OSPREY DRIVE
- B4 W OXGOW COURT
- B4 Y FENNERICK CRESCENT
- B3 Z PIKAKE COURT
- C2 Z PLANTER CRESCENT
- B4 W REDFINCH CRESCENT
- B3 Z REDTAIL DRIVE
- A3 X REINDEER CRESCENT
- B4 Y ROBINS NEST DRIVE
- A3 Z ROMMA DRIVE
- B4 Y ROYVIEW CRESCENT
- B1 X RUSTY TRAIL
- B1 Z SCARLETT TRAIL
- A3 Z SEDGEWAY HEIGHTS
- A1 Z SHADE TREE CRESCENT
- A1 Z SIGNET WAY
- B4 Y SILMAR DRIVE
- A4 Z SKYLARK DRIVE
- B3 Z STARLING BOULEVARD
- A4 X SUNVIEW DRIVE
- B4 W SWEE TRAVEL BOULEVARD
- A4 X TACC TRAIL
- B4 W TEAL CRESCENT
- C1 Z TERECAR DRIVE
- A3 X TERN DRIVE
- B1 W THROTTET TRAIL
- B3 Y TIMBERLAND DRIVE
- A4 Z TOPPER COURT
- B4 W VERA BOULEVARD
- A1 W VELLORE WOODS BOULEVARD
- A3 Z VIREO WAY
- B4 W WESTCREEK DRIVE
- B3 Y WEAFFIELD DRIVE
- B3 Y WILDBERRY CRESCENT
- A3 X WREN DRIVE
- B3 Z WOODS DRIVE
- B3 Z KOWARA ROAD
- B3 Y LEDGE ROCK DRIVE
- A3 Z LEVY COURT

W	X
Y	Z

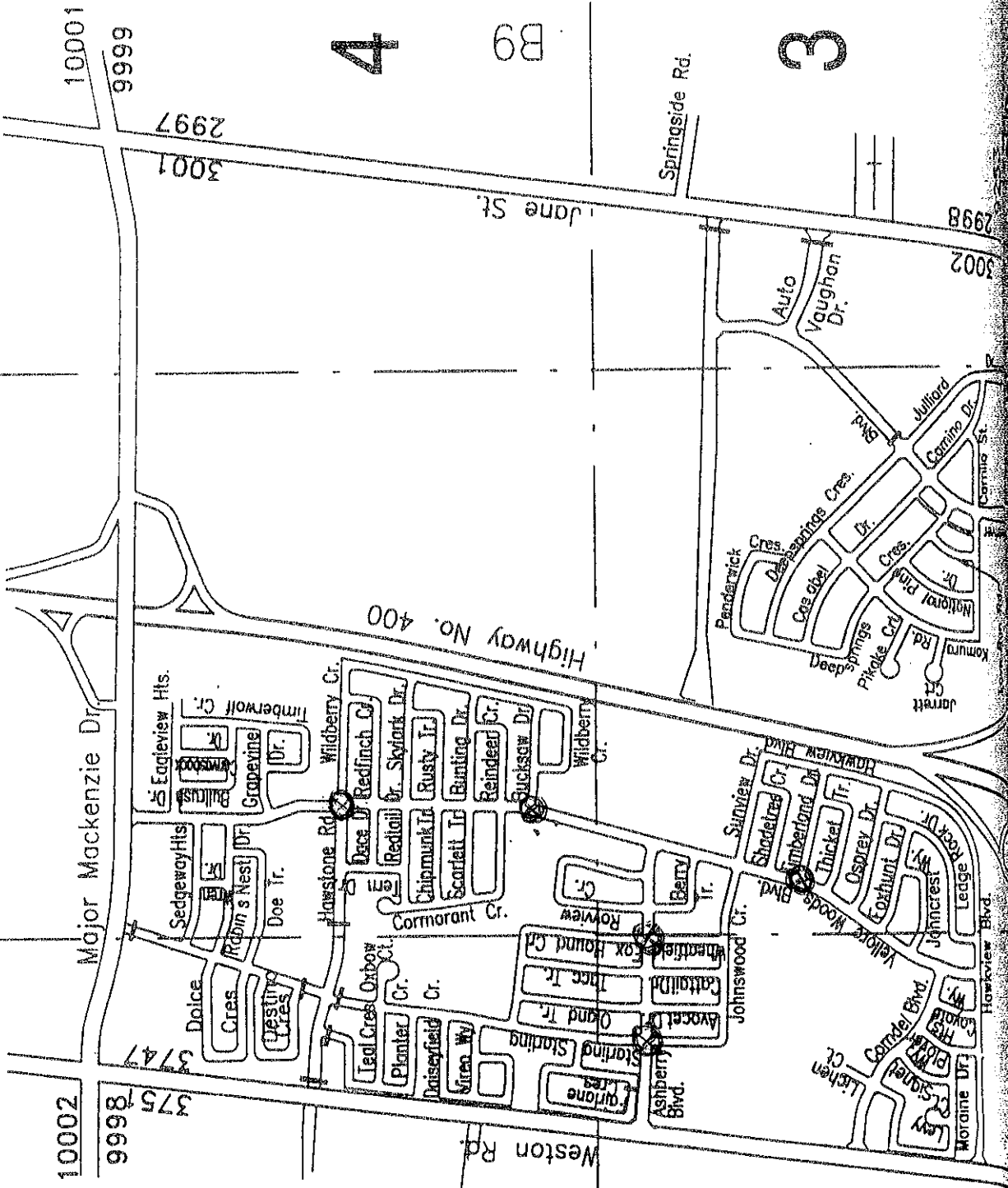

10002

9998

375

10001

9999

2997

3001

4

B7

4

B9

3

3

9248

9249

9250

9251

9252

9253

9254

9255

9256

9257

9258

9259

9260

9261

9262

9263

9264

9265

9266

9267

9268

9269

9270

9271

9272