

COMMITTEE OF THE WHOLE - JUNE 8, 2005

MUNICIPAL WATER SERVICE CONNECTIONS FOR 5859 AND 5830 RUTHERFORD ROAD EAST OF HIGHWAY NO. 27

Recommendation

The Commissioner of Engineering and Public Works recommends:

1. That Council agree in principle to assume the existing 600mm diameter PD5 Regional watermain on Rutherford Road between Highway No. 27 and Vaughan Mills Road in the future, when the Region of York declares it surplus; and,
2. That the Regional Municipality of York be so advised by copy of Council's direction.

Economic Impact

The economic impact to the City will include operating and maintenance costs and future replacement cost, as applicable, associated with this type of infrastructure, once added to the City's watermain system inventory. The watermain will however, generate the usual revenue associated with water consumption customer charges.

Purpose

To seek Council's agreement in principle to assume the existing 600 diameter PD5 Regional watermain on Rutherford Road between Highway No. 27 and Vaughan Mills Road in the future, when the Region of York declares it surplus.

Background - Analysis and Options

Staff has recently been approached by the owners at 5859 and 5830 Rutherford Road regarding the possibility of obtaining a municipal water service to these properties. One of the owners claims that their existing well water supply has been adversely impacted as a result of roadworks and watermain construction associated with the Region's project along Rutherford Rd. in the Highway 27 area. The other owner is simply interested in obtaining Municipal water supply. The City does not have a local watermain in this section of Rutherford Road, however the Region of York has an existing 600mm diameter PD5 feeder main along Rutherford Road, between Highway 27 and Vaughan Mills Road, fronting the subject properties.

This Regional watermain currently conveys water from the Toronto water system, south along Highway No. 27 to the West Woodbridge PD4 and PD5 service areas. In the future the PD5 watermain will be interconnected with the PD6 York-Peel feedermain at the intersection of Highway 27 and Rutherford Road, at which time the portion of watermain on Rutherford Road will no longer form an integral part of the Regional water supply system. Consequently, the Region would be prepared to transfer it to the City at that time. The transfer would be subject to the usual terms and conditions, with the watermain and appurtenances being in a good state of operation and repair at the time of transfer. The exact limits and timing of the transfer will be reviewed with the Region in detail as part of ongoing discussions regarding the update of the Region's Policy on watermain and sewer transfer/jurisdiction.

The Region indicated that although they normally do not allow individual private connections to their watermains, they have no objections to allowing these connections now, in anticipation of the subject PD5 watermain being transferred to the City in the near future. However, the City would have to agree in principle to this future transfer before any connections can be made. This

would ensure that properties on Rutherford Road fronting the subject watermain would have access to a safe, potable water supply without unnecessary delay.

The cost of the lateral connections and water meters would be the responsibility of the individual property owners. Because this section of watermain is already metered by the Region as part of the general water supply to this area of the City, water use charges would be collected and retained by the City in the usual manner.

Relationship to Vaughan Vision 2007

This report is consistent with Vaughan Vision 2007 in that the proposed works develop and implement innovative alternatives for service delivery (1.3.1), and to ensure that municipal operations are undertaken in an environmentally responsible manner (4.4.4.).

This report is consistent with the priorities previously set by Council. The necessary resources have not been allocated and approved for this undertaking.

Conclusion

To allow for private water service connections to the existing 600mm diameter Regional watermain on Rutherford Road between Highway No. 27 and Vaughan Mills Road and to ensure a safe potable water supply to fronting properties, it is necessary for Council to agree in principle to assume this section of watermain in the future, once the Region declares it 'surplus'.

Attachments

1. Location Map

Report prepared by:

John Zanchettin, Senior Engineering Assistant, ext. 3113
Tom Ungar, P. Eng. – Design Engineer, ext. 3110

Respectfully submitted,

Bill Robinson, P. Eng.
Commissioner of Engineering and Public Works

Gary Carroll, P. Eng.
Director of Engineering Services

JZ:mc

ATTACHMENT No. 1

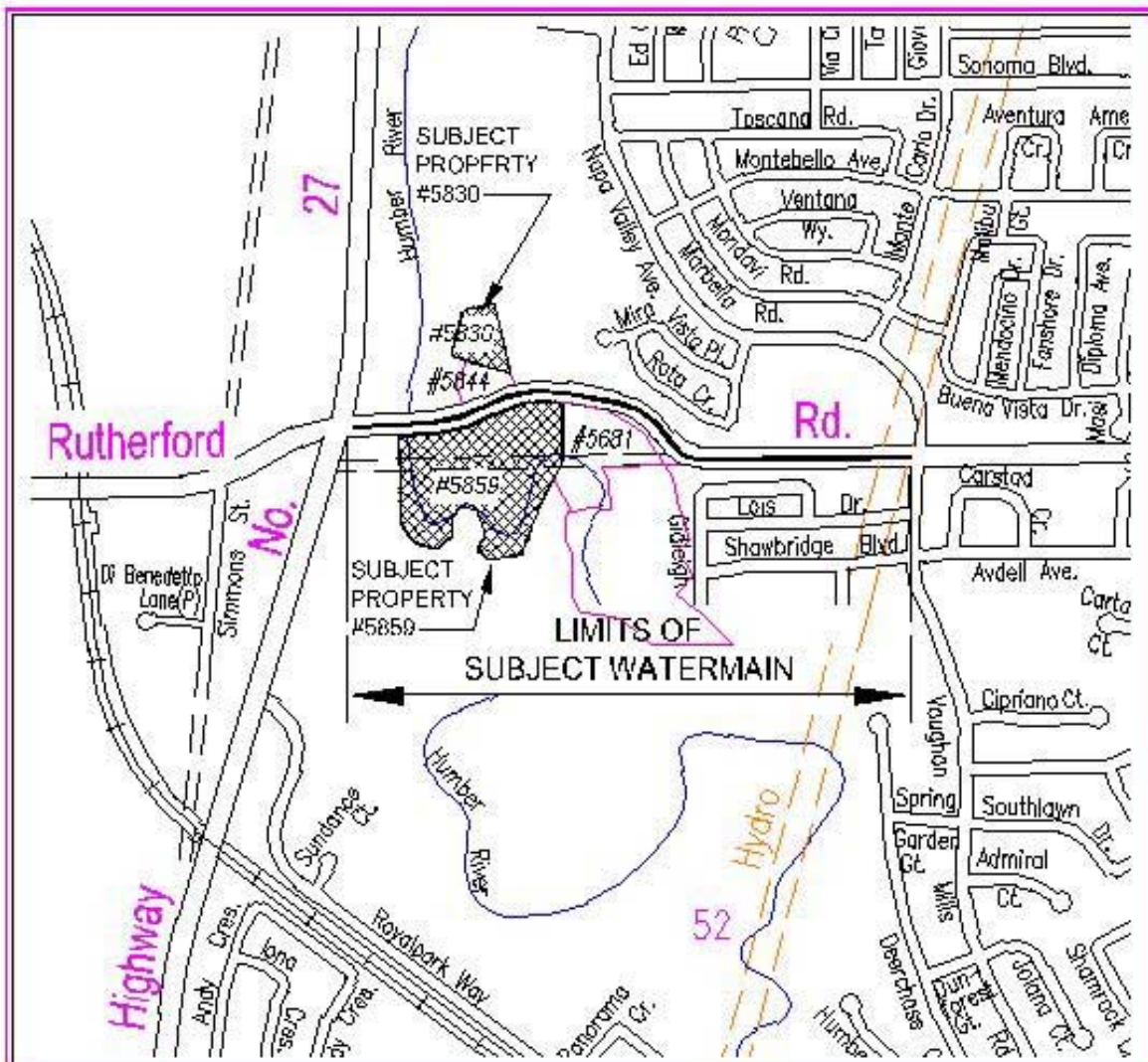

MUNICIPAL WATER SERVICE CONNECTIONS FOR #5859 AND #5830 RUTHERFORD ROAD

LEGEND



SUBJECT LANDS



EXIST. 600mm REGIONAL WATERMAIN LOCATION

LOCATION : Part of Lots 15 & 16
Concession 8



NOT TO SCALE

