

BUDGET COMMITTEE – FEBRUARY 27, 2007

**VELLORE WOODS BOULEVARD AND FOXHUNT DRIVE
PROPOSED SCHOOL CROSSING GUARD**

Recommendation

The Commissioner of Engineering and Public Works in consultation with the Commissioner of Legal and Administrative Services and the Commissioner of Finance and Corporate Services recommends:

1. That subject to funding approval, a school crossing guard be approved on the north side of the intersection of Vellore Woods Boulevard and Foxhunt Drive; and
2. That funds, in the amount of \$9,420 be referred to the 2007 Operating Budget for the additional school crossing guard.

Economic Impact

The cost to implement one additional school crossing guard would have an impact to the 2007 Operating Budget. The annual cost of the additional Crossing Guard will be an increase of \$9,420 commencing with the 2007 Operating Budget.

Communications Plan

That upon approval by Council, the York Region District School Board, York Catholic Separate School Board, St. Emily Catholic Elementary School Principal, and School Community Council be notified of Council's decision in this matter.

Purpose

To review the feasibility of implementing a school crossing guard for the Vellore Woods Boulevard and Foxhunt Drive intersection, in response to a request from the Principal of St. Emily's Catholic Elementary School.

Background - Analysis and Options

Staff received a request from the Principal of St. Emily's Catholic Elementary School for a school crossing guard crossing children living on the east side of Vellore Woods Boulevard in front of St. Emily's Catholic Elementary School. St. Emily's Catholic Elementary School is located on the north-west corner of Vellore Woods Boulevard and Comdell Drive. See Attachment No. 1 for the area network.

A pedestrian study was conducted on Thursday, December 14, 2006. Students were counted crossing Vellore Woods Boulevard from Hawkview Drive to Foxhunt Drive (south zone), and from north of Foxhunt Drive to Sunview Drive / Johnswood Crescent (north zone). On the day of the study, the weather was clear and sunny. The results are summarized below:

Time	South Zone	North Zone	Total
8:25 a.m. – 9:05 a.m.	33	12	45
3:25 p.m. – 4:00 p.m.	38	14	52

A school crossing guard is recommended in accordance with the Council approved warrant when the number of unassisted children crossing the road exceeds 50 in the peak hour. The majority of

students were using the intersection of Foxhunt Drive and Vellore Woods Boulevard, as this leads directly into the school yard. Based on the traffic study and warrant, staff recommends that a new school crossing guard be implemented on the north side of the Vellore Woods Boulevard and Foxhunt Drive intersection. In addition, that funds be approved in the 2007 Operating Budget in the amount of \$9,420 for the hiring of the guard.

Relationship to Vaughan Vision 2007

This traffic study is consistent with Vaughan Vision 2007 as to identify and implement innovative traffic management alternatives to improve general traffic safety (1.1.3).

This report is consistent with the priorities previously set by Council.

Regional Implications

Not Applicable.

Conclusion

Based on our review, it is recommended that a school crossing guard be implemented on the north side of the Vellore Woods Boulevard and Foxhunt Drive intersection.

Attachments

1. Location Map

Report prepared by:

Leslie Winfrow, Traffic Analyst Ext. 3131
Mike Dokman, Supervisor, Traffic Engineering, Ext. 3118

Respectfully submitted,

Bill Robinson, P.Eng.
Commissioner of Engineering and Public Works

Gary Carroll, P.Eng.
Director of Engineering Services



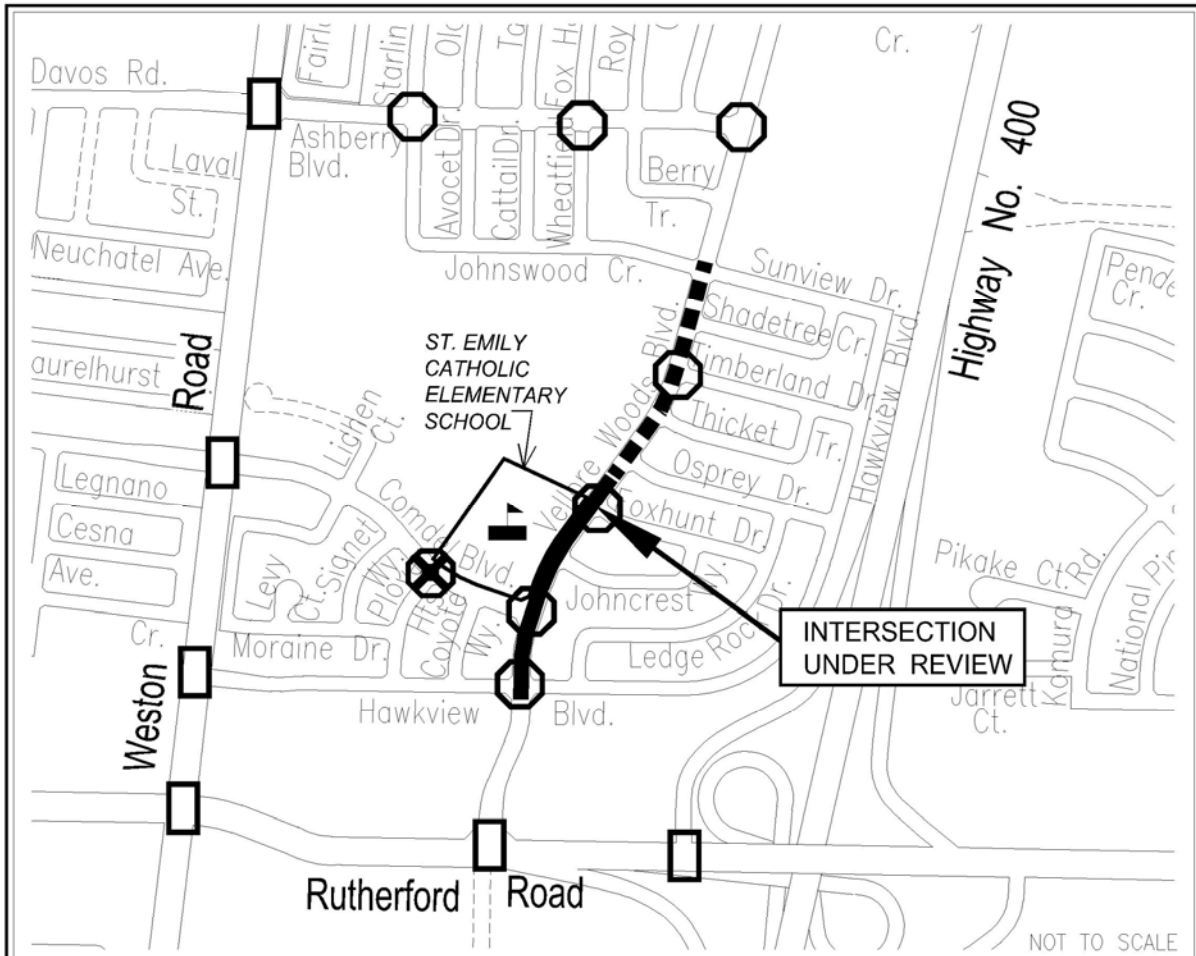

LW:mc

ATTACHMENT No. 1



VELLORE WOODS BOULEVARD PROPOSED SCHOOL CROSSING GUARD

LEGEND

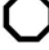
-  INTERSECTION UNDER REVIEW
-  NORTH ZONE
-  SOUTH ZONE
-  EXISTING SCHOOL CROSSING GUARD
-  EXISTING TRAFFIC SIGNALS
-  EXISTING ALL-WAY STOP CONTROL

