

COMMITTEE OF THE WHOLE SEPTEMBER 2, 2008

SIGN VARIANCE APPLICATION

FILE NO: SV.08-017

OWNER: GRAND & TOY LTD.

LOCATION: 200 AVIVA PARK DRIVE, BLOCK 6, REGISTERED PLAN 65M-2790

Recommendation

The Sign Variance Committee recommends:

That Sign Variance Application SV.08-017, Grand & Toy Ltd., be APPROVED.

Economic Impact

None.

Communications Plan

The results of this application will be communicated to the applicant through the Secretary to the Sign Variance Committee.

Purpose

Request to install two wall signs on each building face of the subject property as shown on the attached drawings.

Background - Analysis and Options

6.2 (a) Where a site plan approved by the City provides standards for signage and the signs for the development comply therewith, such signs shall be deemed to comply with this By-law.

The Sign By-Law permits only those signs shown on the approved site plan agreement.

Relationship to Vaughan Vision 2020

This report is consistent with the priorities previously set by Council and the necessary resources have been allocated and approved.

Regional Implications

Region of York Engineering approval is not required for the proposed signs.

Conclusion

The applicant is proposing to remove the existing signage and install new two wall signs on each building face as shown on the attached drawings.

Members of the Sign Variance Committee have no objections to the application as submitted, and are of the opinion that the intent and purpose of the Sign By-law is being maintained.

If Council finds merit in the application, a Sign Permit issued by the Building Standards Department is required.

Attachments

1. Site Plan
2. North Building Elevations
3. South Building Elevations

Report prepared by:

John Studdy, Manager of Customer & Administrative Services Ext 8232

Respectfully submitted,

John Studdy
Chair, Sign Variance Committee

/pa

HIGHWAY 407

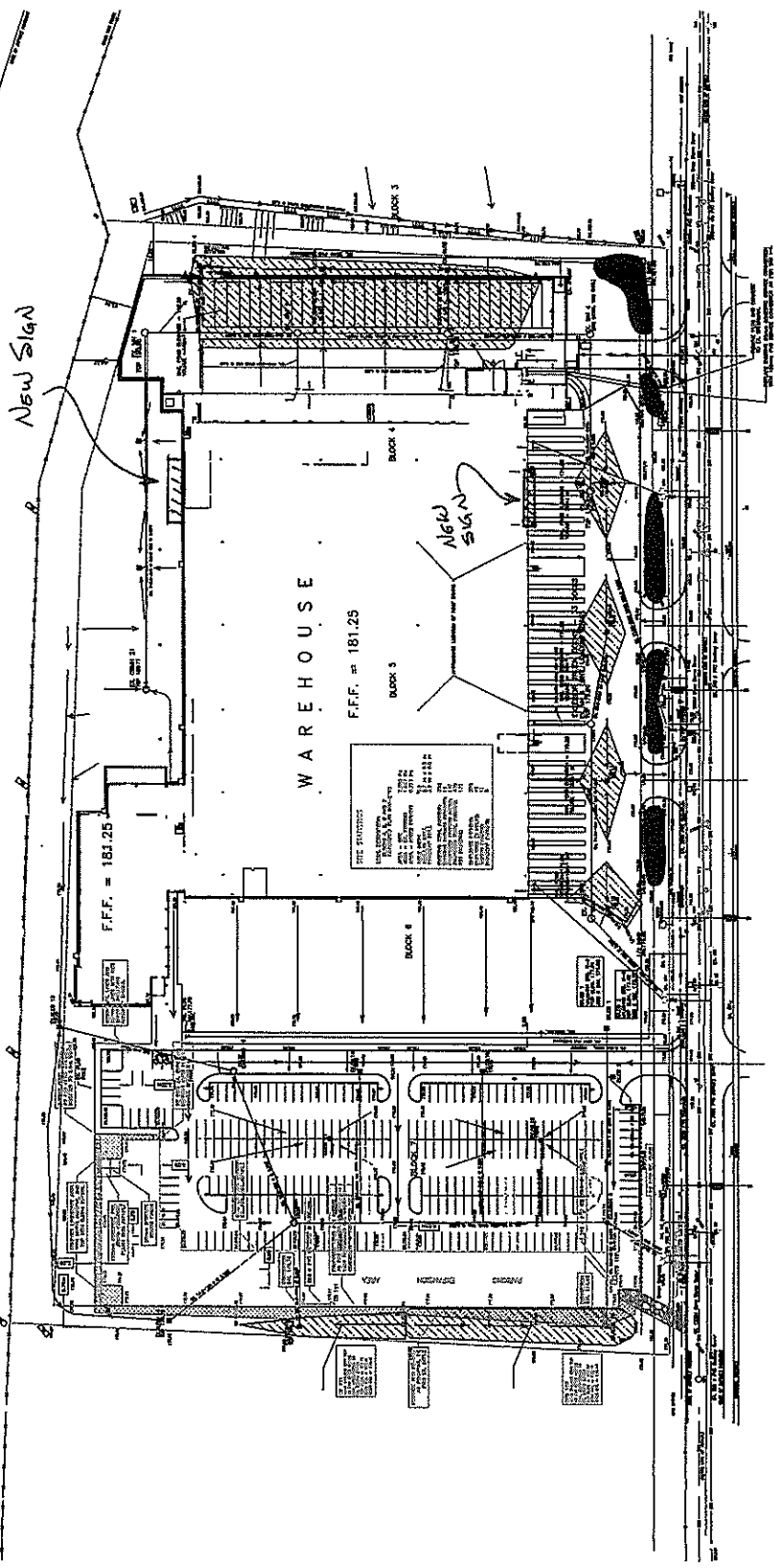

VAUGHAN PARKING LOT EXPANTION / GRADE PLAN
PREPARED BY: EARTHTECH ENGINEERS / DAVE KESSLER

NORTH ELEVATION

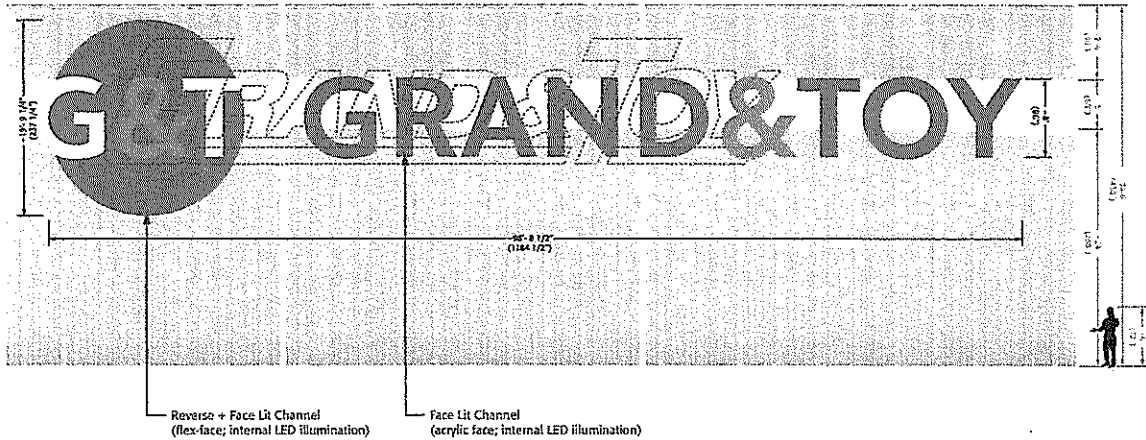

3M Scotchcal Translucent Film

Match for G&T Dark Green (Pantone 355C):
3630-156 Vivid Green

Match for G&T Light Green (Pantone 376C):
3630-106 Brilliant Green

Note: This combination of films requires testing.



Existing



Photo Mockup of Proposed Sign



Existing



Photo Mockup of Proposed Sign

SOUTH ELEVATION

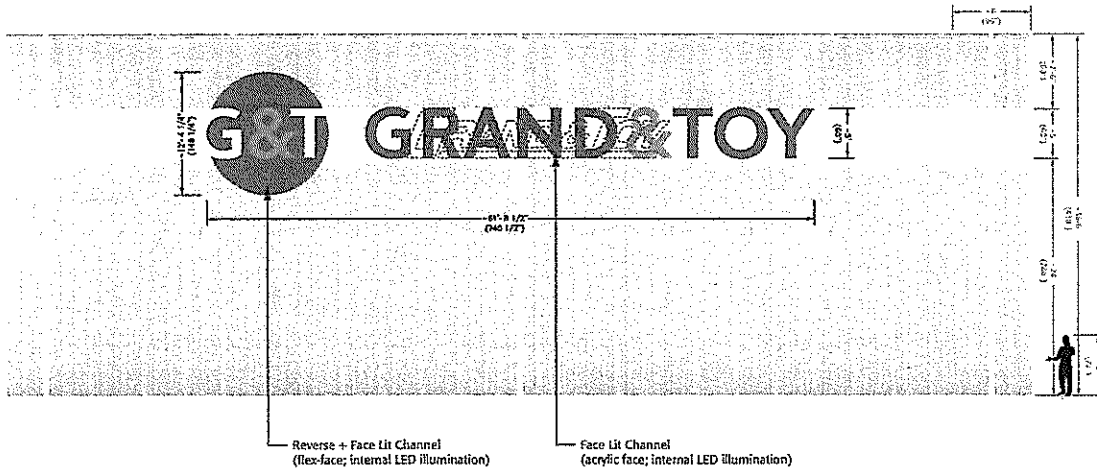

3M Scotchlcal Translucent Film

- Match for G&T Dark Green (Pantone 355C):
3630-156 Vivid Green
- Match for G&T Light Green (Pantone 376C):
3630-106 Brilliant Green

Note: This combination of films requires testing.



Existing

Photo Mockup of Proposed Sign

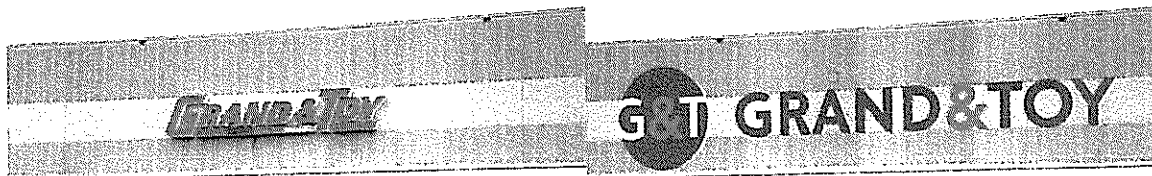

Existing

Photo Mockup of Proposed Sign