

## **COMMITTEE OF THE WHOLE – MARCH 23, 2010**

### **COMPREHENSIVE TRAFFIC BY-LAW 284-94 WARDS – 1-5**

#### **Recommendation**

The Commissioner of Engineering and Public Works in consultation with the Director of Public Works and the Director of Engineering Services recommends:

That consolidation be made to By-law 284-94, the Comprehensive Traffic By-Law to include an amendment to Schedule C - "Prohibit Heavy Trucks", to rescind the existing seasonal restrictions on the City's industrial roads.

#### **Contribution to Sustainability**

The current seasonal load restrictions on the City's urban industrial roads are of concern to the local businesses and may impact their economic sustainability due to increased shipping costs during the existing two month load restriction period.

#### **Economic Impact**

Although staff time will be required to remove the existing signs, there is no significant economic impact associated with implementing the recommendations in this report.

#### **Communications Plan**

Engineering Services staff have been in discussion with the Public Works Department to amend changes to the Comprehensive Traffic By-law 284-94, specifically to Schedule C "Prohibit Heavy Trucks".

Once the changes have been made, staff will advise those business owners that have requested additional information on this matter.

#### **Purpose**

To incorporate administrative amendments and consolidations in the City of Vaughan's Comprehensive Traffic By-Law 284-94.

#### **Background - Analysis and Options**

The City of Vaughan's Comprehensive Traffic By-Law has had various amendments over the years. These amendments would include approved by-laws and also would reflect updates to the Ontario Highway Traffic Act.

Public Works staff have received complaints from several area businesses with concerns to the seasonal restrictions imposed on industrial roads. Currently, these roads have load restrictions on them from March 1 to April 30 inclusive. The impact of having restricted loads, increases the shipping costs for the local businesses, and makes transporting some loads impossible during this time period.

The City's industrial roads are built to a higher standard than regular residential streets and can accommodate full loads on a year round basis.

With the assistance of Public Works staff, Traffic Engineering Services staff will update the by-law to rescind the seasonal truck restriction on industrial roads.

The existing heavy vehicle prohibition will not be amended and it is still intended to be year-round (refer to Attachments No. 1, 2, 3, and 4). It should also be noted that the by-law will still allow staff to post seasonal half loads on various roads, if there is a need to do so to avoid damage to the road infrastructure. The industrial roads that have seasonal load restrictions to be rescinded are indicated on Attachments No. 5, 6, 7 and 8.

### **Relationship to Vaughan Vision 2020/Strategic Plan**

This report is consistent with the priorities previously set by Council, and complies with the following Vaughan Vision 2020, Goals and Objectives:

Goal: Service Excellence  
Objective: "Pursue Excellence in Service Delivery"  
Objective: "Enhance and Ensure Community Safety, Health & Wellness"

Goal: Management Excellence  
Objective: "Maintain Assets & Infrastructure Integrity"

### **Regional Implications**

Not Applicable.

### **Conclusion**

It is recommended, that Council approve the amendments and consolidations to the Comprehensive Traffic By-Law 284-94 to rescind the seasonal load limits on the designated industrial roads.

### **Attachments**

1. City Map, Northwest quadrant - Heavy truck, Load Restrictions, Seasonal Load Restrictions
2. City Map, Southwest quadrant - Heavy truck, Load Restrictions, Seasonal Load Restrictions
3. City Map, Northeast quadrant - Heavy truck, Load Restrictions, Seasonal Load Restrictions
4. City Map, Southeast quadrant - Heavy truck, Load Restrictions, Seasonal Load Restrictions
5. City Map, Northwest quadrant - City Rescinded Existing Seasonal Restrictions
6. City Map, Southwest quadrant - City Rescinded Existing Seasonal Restrictions
7. City Map, Northeast quadrant - City Rescinded Existing Seasonal Restrictions
8. City Map, Southeast quadrant - City Rescinded Existing Seasonal Restrictions

### **Report prepared by:**

Shawn McKenzie, Senior Environment and Technical Assistant, ext. 6177  
Mike Dokman, Supervisor Traffic Engineering, ext. 3118

Respectfully submitted,

Bill Robinson, P. Eng.  
Commissioner of Engineering and Public Works

Jack Graziosi, P. Eng., M.Eng.  
Director of Engineering Services

Brian T. Anthony, CRS-S, C. Tech  
Director of Public Works

# ATTACHMENT No. 1

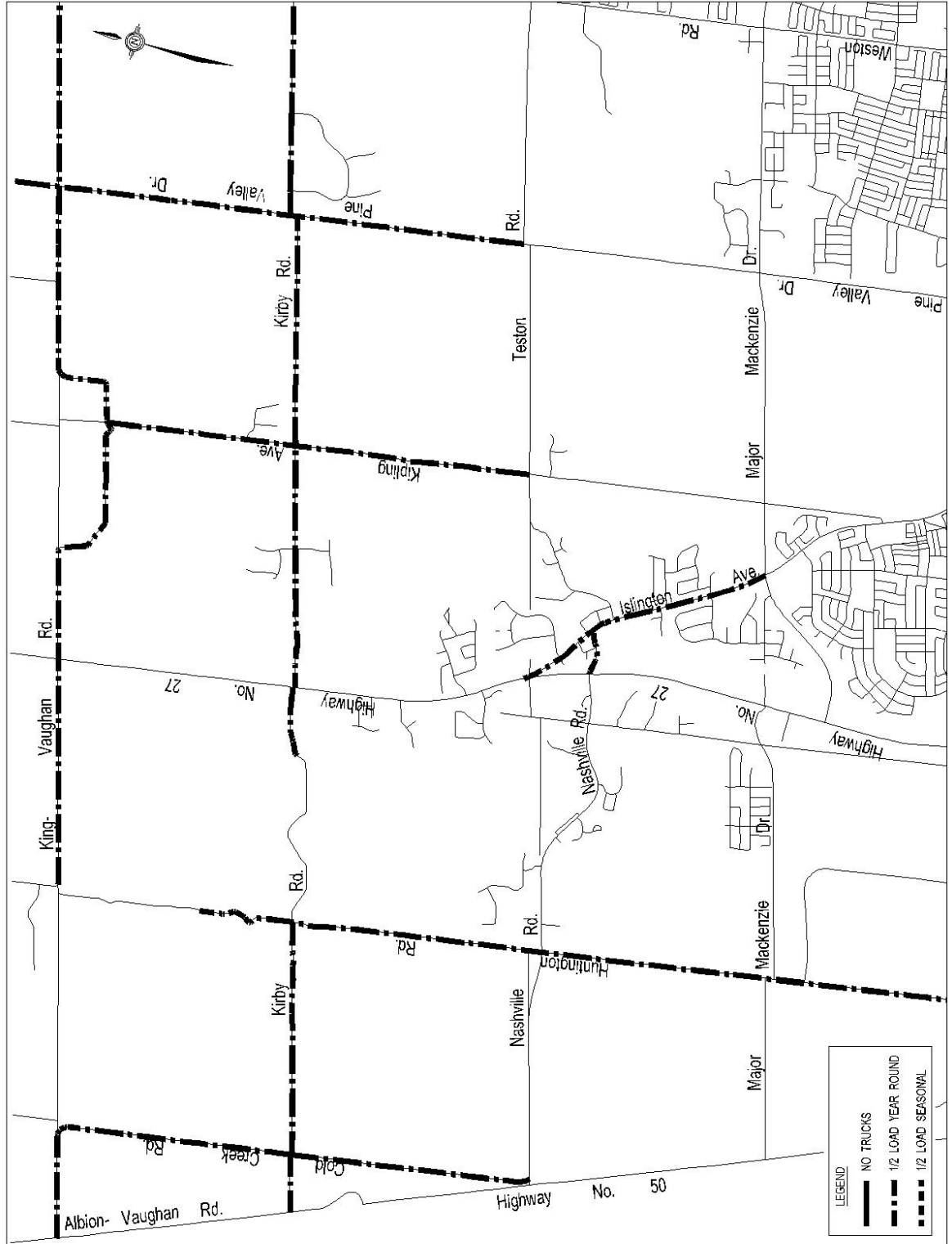

# LOAD CAPACITY - NW QUADRANT

DRAFTSPERSON: G.S.

Drawing name: D:\Engineering Services\Design Services\Design Drafting\TRAFFIC\Load Restrictions\Road Load Restrictions.dwg

# ATTACHMENT No. 2

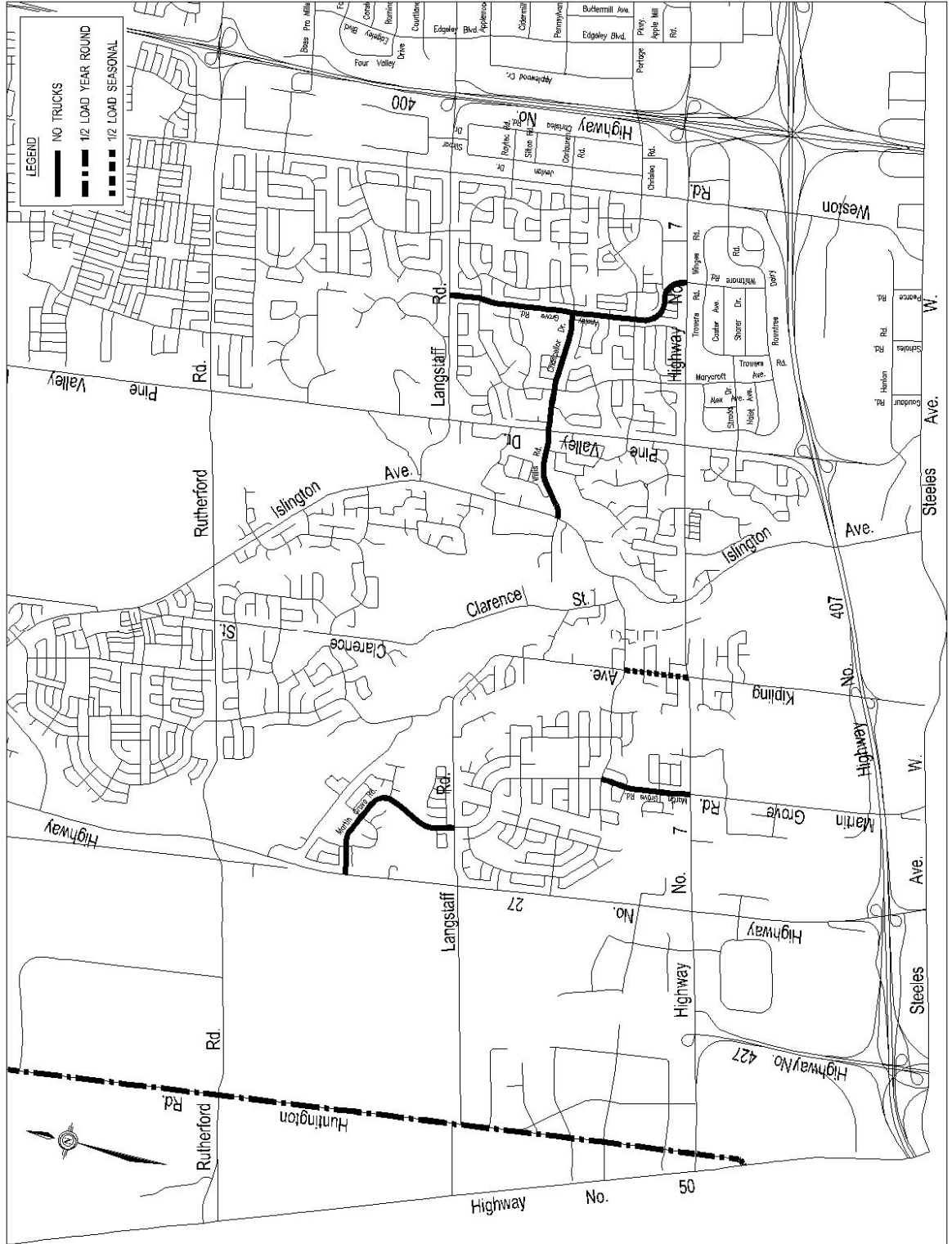

DRAFTSPERSON: G.S.

Drawing name: O:\Engineering Services\Design Services\Design Drafting\TRAFFIC\Load Restrictions\Road Load Restrictions.dwg

# LOAD CAPACITY - SW QUADRANT

# ATTACHMENT No. 3

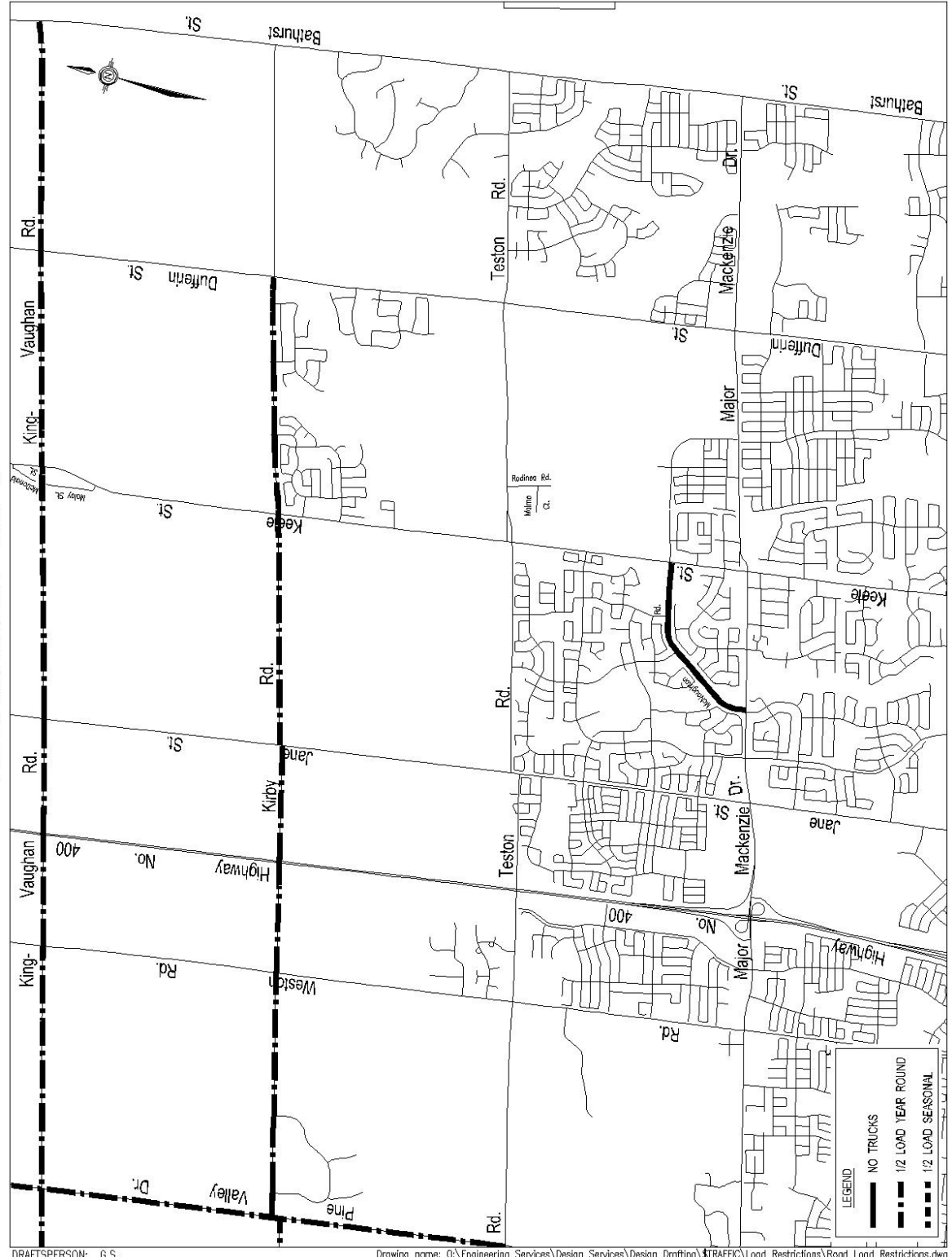

# LOAD CAPACITY - NE QUADRANT

DRAFTSPERSON: G.S.

Drawing name: O:\Engineering Services\Design Services\Design Drafting\TRAFFIC\Load Restrictions\Road Load Restrictions.dwg

# ATTACHMENT No. 4

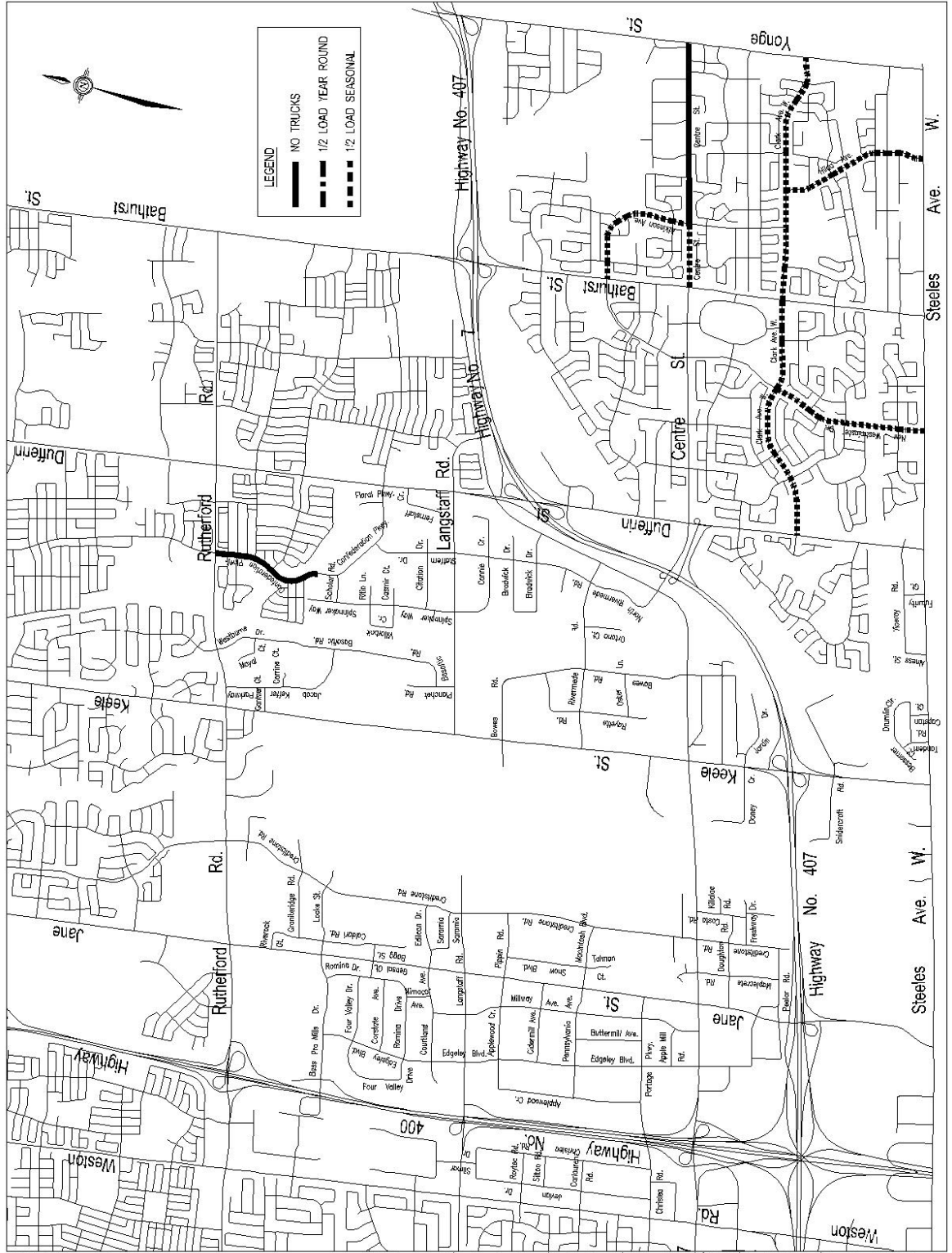

# LOAD CAPACITY - SE QUADRANT

DRAFTSPERSON: G.S.

Drawing name: O:\Engineering Services\Design Services\Design Drafting\TRAFFIC\Load Restrictions\Road Load Restrictions.dwg

# ATTACHMENT No. 5

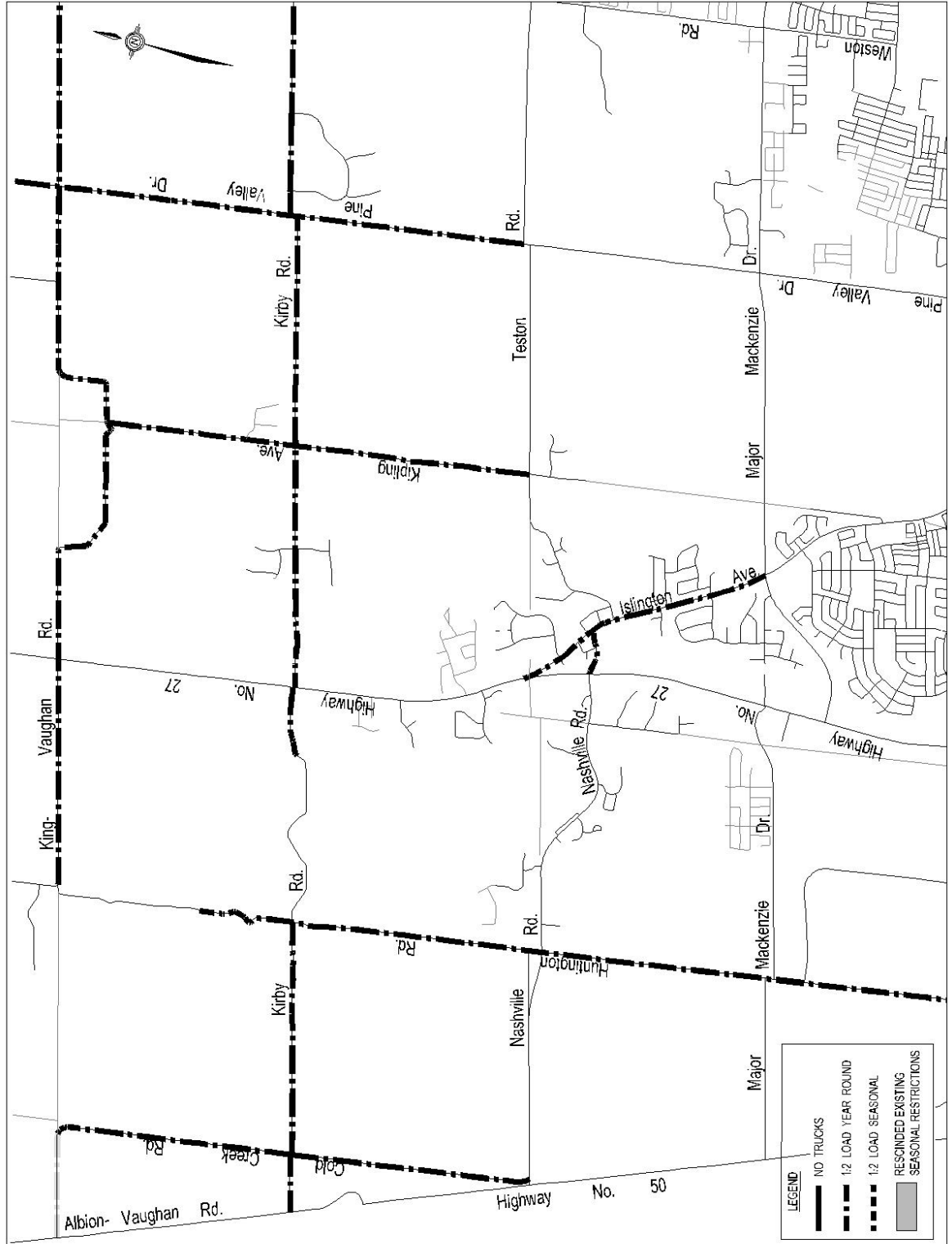

# LOAD CAPACITY - NW QUADRANT

DRAFTSPERSON: G.S.

Drawing name: O:\Engineering Services\Design Services\Design Drafting\TRAFFIC\Load Restrictions\MARGARET-Road Load Restrictions.dwg



# ATTACHMENT No. 6

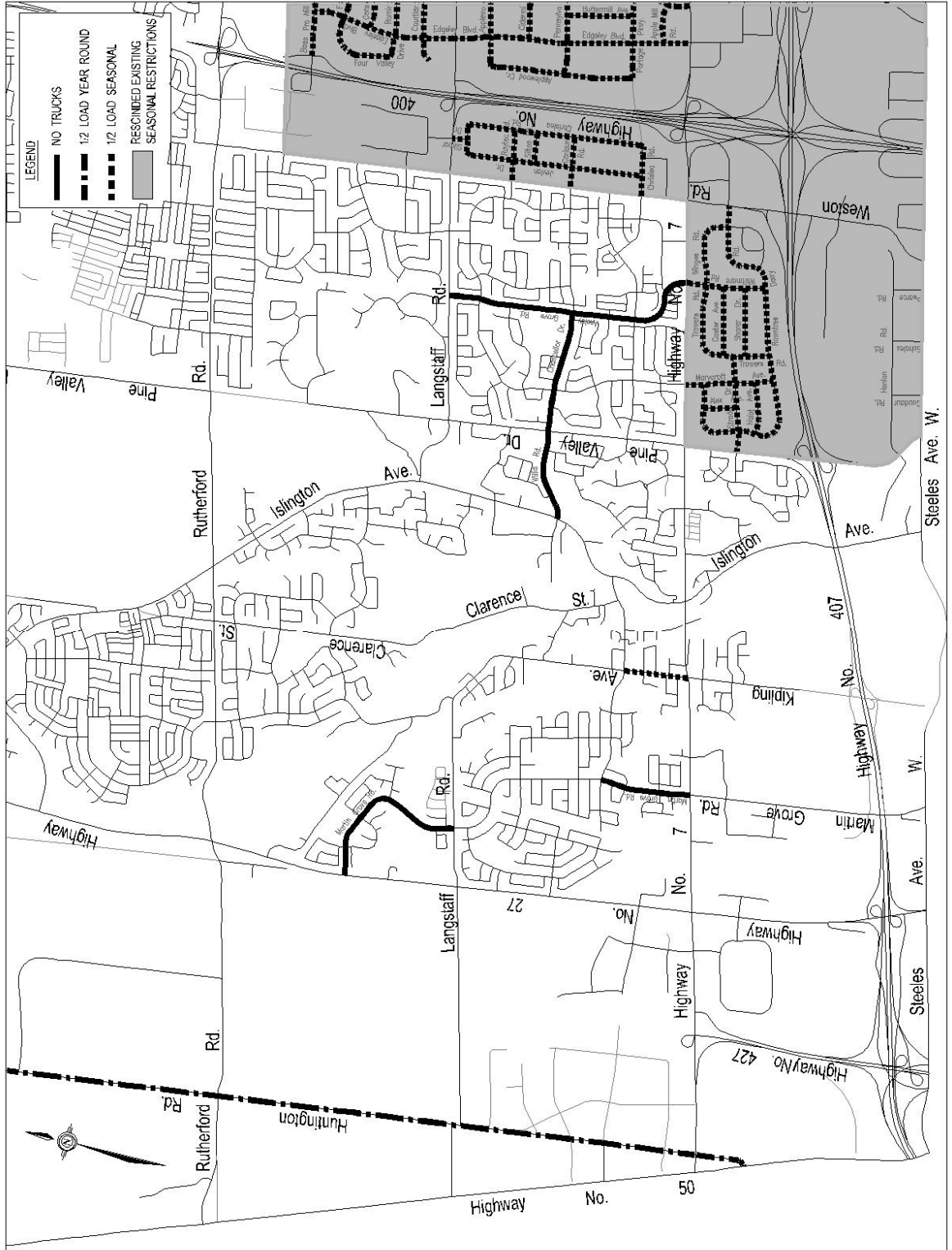

DRAFTSPERSON: G.S.

Drawing name: O:\Engineering Services\Design Services\Design Drafting\TRAFFIC\Load Restrictions\MARGARET-Road Load Restrictions.dwg

# LOAD CAPACITY - SW QUADRANT

# ATTACHMENT No. 7

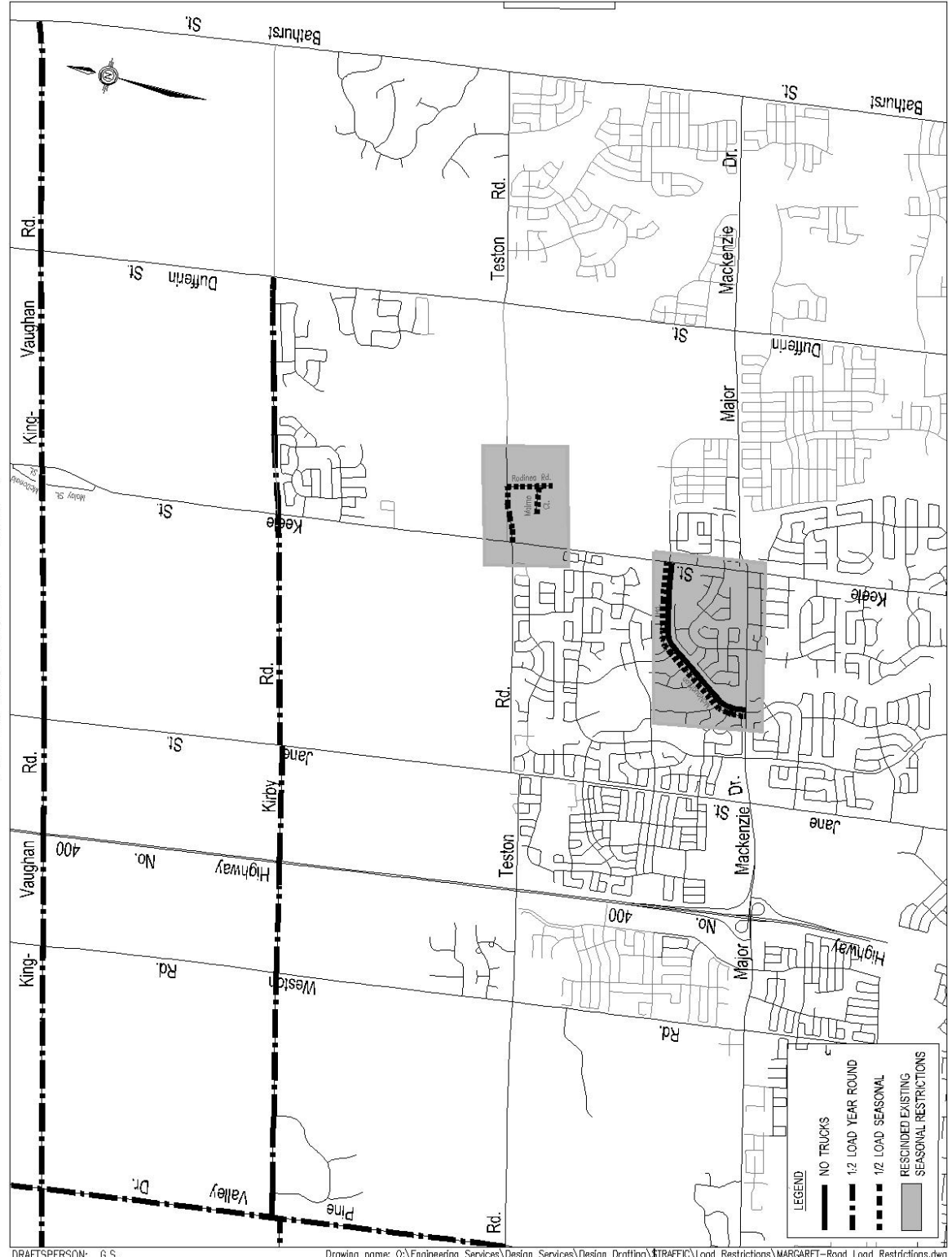

# LOAD CAPACITY - NE QUADRANT

DRAFTSPERSON: G.S.

Drawing name: O:\Engineering Services\Design Services\Design Drafting\TRAFFIC\Load Restrictions\MARGARET-Road Load Restrictions.dwg

ATTACHMENT No. 8

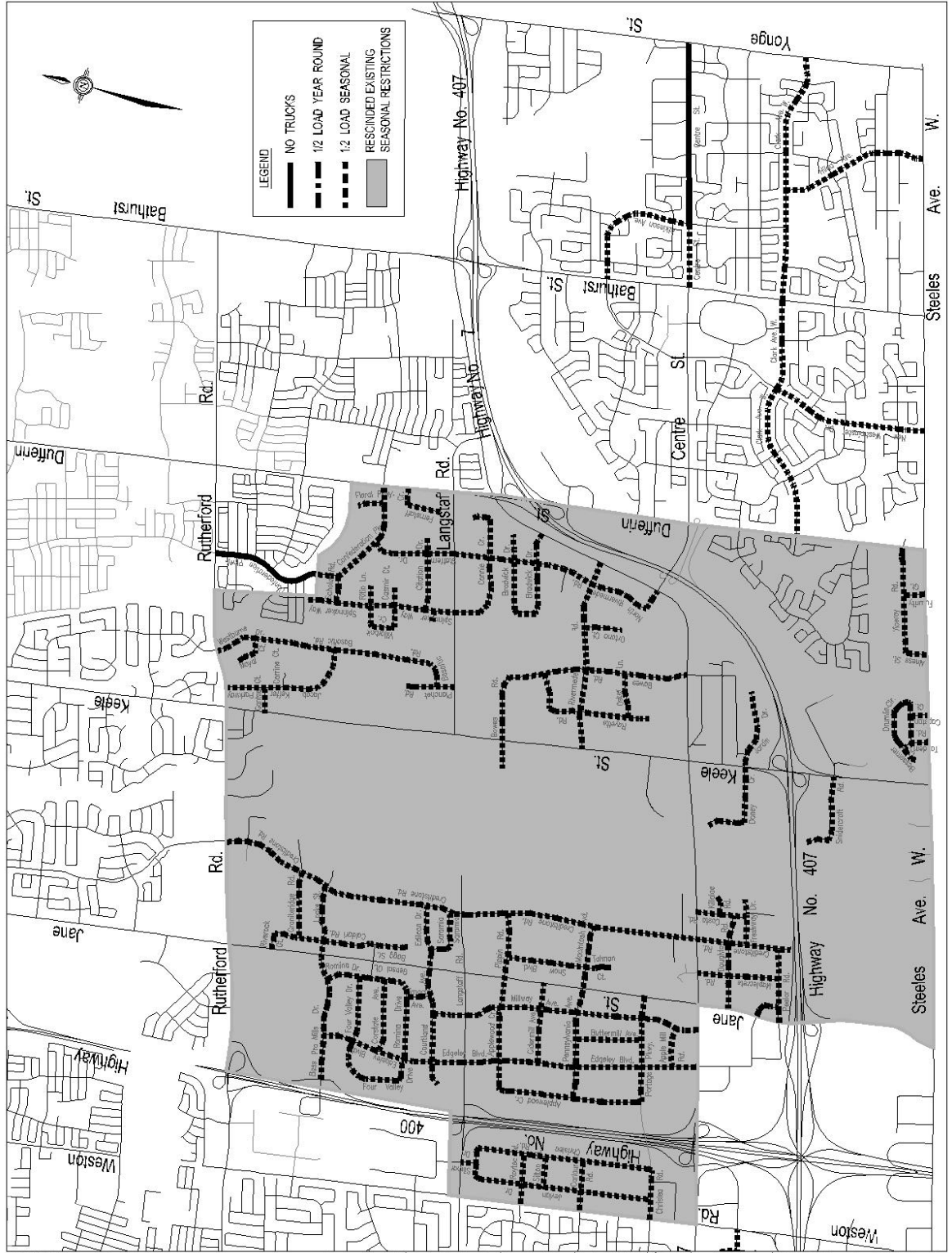

DRAFTSPERSON: G.S.

Drawing name: O:\Engineering Services\Design Services\Design Drafting\TRAFFIC\Load Restrictions\MARGARET-Road Load Restrictions.dwg

LOAD CAPACITY - SE QUADRANT