

COMMITTEE OF THE WHOLE – MAY 10, 2011

INTERSECTION STOP CONTROL CHARMAINE ROAD AND SARRACINI CRESCENT INTERSECTIONS REGENCY ESTATES SUBDIVISION 19T-08V07 WARD 2

Recommendation

The Commissioner of Engineering and Public Works recommends:

THAT Council enact the necessary by-law to establish stop controls on the north and south leg of Charmaine Road at the two new three way intersections of Charmaine Road and Sarracini Crescent. Said by-law to come into effect after the Regency Estates Plan of Subdivision, 19T-08V07, has been registered.

Contribution to Sustainability

The installation of a stop sign on Charmaine Road at the new intersections of Sarracini Crescent will regulate traffic flow and promote pedestrian safety.

Economic Impact

The cost associated with the supply and placement of the necessary advisory signage and the installation of the two new stop signs on Charmaine Road will be borne by the developer of the Regency Estates Subdivision 19T-08V07. Accordingly, there is no immediate economic impact resulting from the adoption of this report.

Communications Plan

A communication plan will be implemented in connection with the proposed implementation of stop controls at the intersections of Charmaine Road and Sarracini Crescent in accordance with the procedures outlined in the Ontario Traffic Manuals. In particular, the appropriately worded road side signage will be installed for a prescribed period of time in order to inform motorists of the new stop controls at the intersections before the changes actually takes place.

Purpose

The purpose of this report is to seek Council's approval to implement stop controls at the new three way intersections of Charmaine Road and Sarracini Crescent.

Background – Analysis and Options

Charmaine Road is a two lane local roadway that extends between Kiloran Avenue and Dorengate Drive in Woodbridge. Stop controls are located on Charmaine Road at the intersections of Kiloran Avenue and Dorengate Drive. Charmaine Road has an unsigned speed limit of 50 kilometres per hour and a sidewalk exists on one side of the road.

In conjunction with the development of the Regency Estates Subdivision 19T-08V07, a new local crescent road, named Sarracini Crescent, will be constructed and connected to Charmaine Road creating two new three way intersections as shown on Attachment No.1. To clearly define the right-of-way and to regulate traffic flow, it is recommended that stop controls be implemented on the north and south legs of Charmaine Road at the two new three way intersections of Charmaine Road and Sarracini Crescent. This traffic control configuration is consistent with a typical three way intersection. In addition, the stop control on Charmaine Road will also enhance pedestrian

safety. All-way Stop Control is not recommended at these locations as the intersections do not meet minimum requirements of the Provincial Warrant for All-way Stop Control.

Relationship to Vaughan Vision 2020/Strategic Plan

In consideration of the strategic priorities related to Vaughan Vision 2020, the recommendations of this report will assist in:

- The pursue of excellence in service delivery;
- Enhancing and ensuring Community Safety;
- To advocate for, protect and enhance community safety, health and wellness through education, design and enforcement;
- Promoting effective governance; and
- Planning and managing growth, and economic vitality.

This report is therefore consistent with the priorities previously set by Council.

Regional Implications

Not applicable

Conclusion

To clearly define the right-of-way and to regulate traffic flow, it is recommended that stop controls be implemented on the north and south legs of Charmaine Road at the two new three way intersections of Charmaine Road and Sarracini Crescent, which are being constructed in conjunction with the Regency Estates Subdivision.

Attachments

1. Attachment No. 1 – Location Plan

Report prepared by:

Joe Landolfi, Senior Engineering Assistant, ext. 8257
Tony Magliocchi, Manager of Development Services, ext. 8253

Respectfully submitted,

Bill Robinson, P. Eng.
Commissioner of Engineering and Public Works

Andrew Pearce, C.E.T.
Director of Development/
Transportation Engineering

ATTACHMENT No. 1

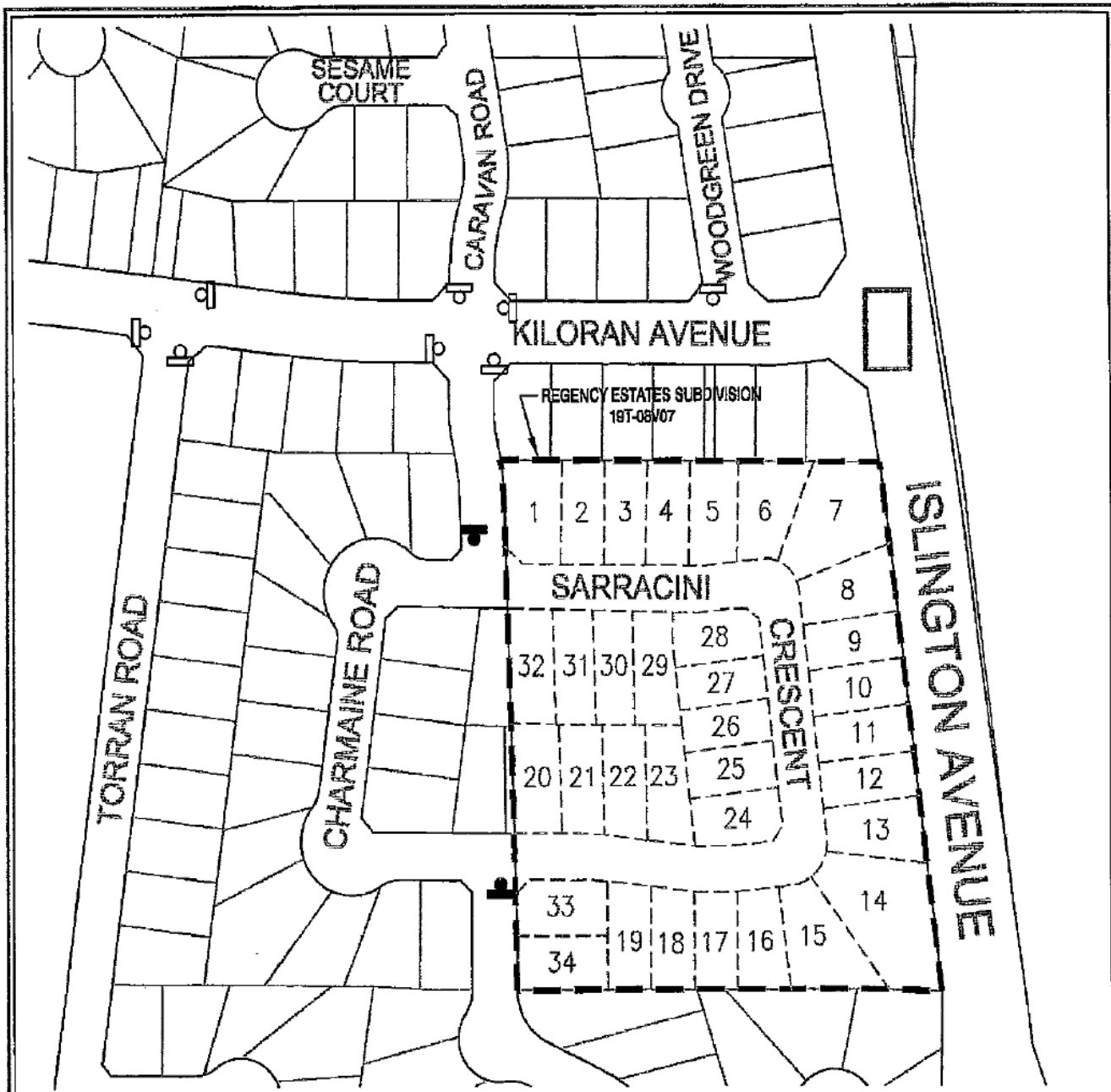

STOP CONTROL ADDITION CHARMAINE ROAD/ SARRACINI CRESENT INTERSECTION

LEGEND



PROPOSED STOP SIGN



EXISTING TRAFFIC SIGNAL



EXISTING STOP SIGN



NOT TO SCALE

Drawing name: C:\Engineering Services\Design Services\Drawings\2010 Attachments\191-08V07-SARRACINI CRESCENT.dwg