

SIGN VARIANCE APPLICATION

FILE NO: **SV.11-037**
OWNER: **RIOCAN MANAGEMENT INC.**
LOCATION: **7575 WESTON ROAD, UNIT NO. 118**
 LOTS 4-5, CONCESSION 5
 WARD 3

Recommendation

The Sign Variance Committee recommends:

That Sign Variance Application SV.11-037, Riocan Management Inc., be APPROVED subject to the following conditions:

- i) that sign be constructed with cut-out letters and the black sign backing be removed.

Contribution to Sustainability

N/A

Economic Impact

None.

Communications Plan

The results of this application will be communicated to the applicant through the Secretary to the Sign Variance Committee.

Purpose

To permit the installation of one (1) sign 7.7 sqm. wall sign on the rear of the building as shown on the attached drawings.

Background - Analysis and Options

Sign Bylaw Requirements (By-Law 203-92, as amended):

- 6.2 (a) Where a site plan approved by the City provides standards for signage and the signs for the development comply therewith, such signs shall be deemed to comply with this By-Law.

Noting the above, where the property is regulated by a site plan agreement approved by the City, only those wall signs and pylon signs approved under the site plan agreement are deemed to be permitted by the City's Sign By-Law.

Relationship to Vaughan Vision 2020/Strategic Plan

This report is consistent with the priorities previously set by Council and the necessary resources have been allocated and approved.

Regional Implications

Region of York Engineering approval is not required for the proposed signs.

Conclusion

The applicant has applied to the Committee to allow for the construction a 7.7 sqm wall sign as shown on the attached drawings. The site plan approved with the development does not show the proposed sign.

Members of the Sign Variance Committee have reviewed the application and have no objections to the approval subject to the type/style of the proposed sign being reconfigured to match the existing signs located on the building's elevation.

Accordingly, Members of the Committee are recommending that the proposed sign be constructed with cut-out letters and the proposed black sign backing be removed.

If Council finds merit in the application, a Sign Permit issued by the Building Standards Department is required.

Attachments

1. Site Plan
2. Sketch of Sign
3. Photo of Rear Elevation - Sign Location

Report prepared by:

John Studdy, Manager of Customer & Administrative Services Ext 8232

Respectfully submitted,

John Studdy
Chair, Sign Variance Committee

/as

SU.11-037

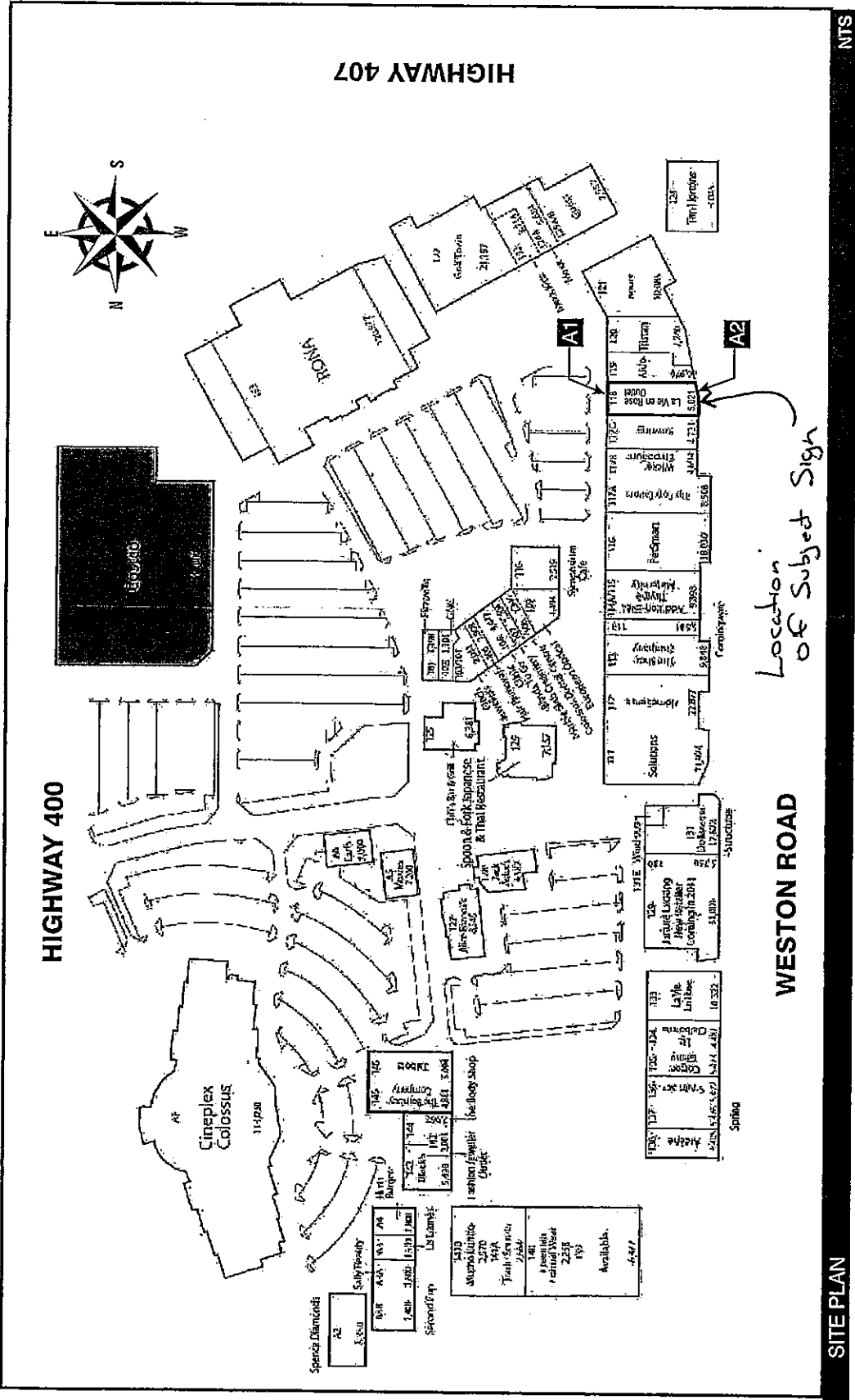

NTS

SITE PLAN

la Vie en Rose
 Acc. Rep.: Tammi Derksen
 Designer: N. Tremblay
 UL: #E188093
 Request: #4227
 Date: 2011-07-21
 Page: 7/7

Revisions	Date
New dimensions sign-A2 (JVA)	2011-08-15
New dimensions sign-A (JVA)	2011-08-11
New dimensions sign-A (JVA)	2011-08-10

CUSTOMER APPROVAL

Signature: _____
 Printed name please: _____

This artwork is protected by copyright.
 All rights reserved by Access Signs Inc.
 WER11_ColossusCentre_Vaughan_ON_rev003

PRELIMINARY
FINAL

ACCESS
 Your Sign Department
 2351 Fernmount-Lafontaine Blvd, Longwood, ON L4H 1H7
 Tel: 450.674.3333 / 888.455.0664 / Fax: 450.674.4088

28' - 3"

laVie en Rose

OUTLET

6'-0"

A1 A2 SIGN ELEVATION

Scale: 1/4" = 1'-0"

(2) SETS OF ILLUMINATED CHANNEL LETTERS ON RACEWAY

28' - 3"

22' - 1 3/8"

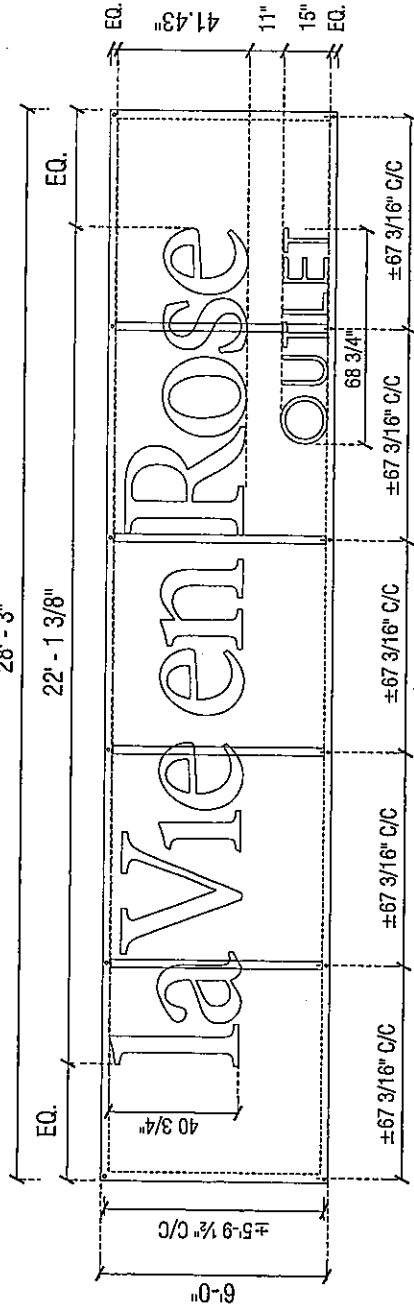

A1 A2 STRUCTURE ELEVATION

Scale: 1/4" = 1'-0"

SURVEY REQUIRED BEFORE PRODUCTION

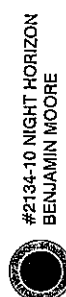

#2134-10 NIGHT HORIZON
BENJAMIN MOORE

SK-11-037

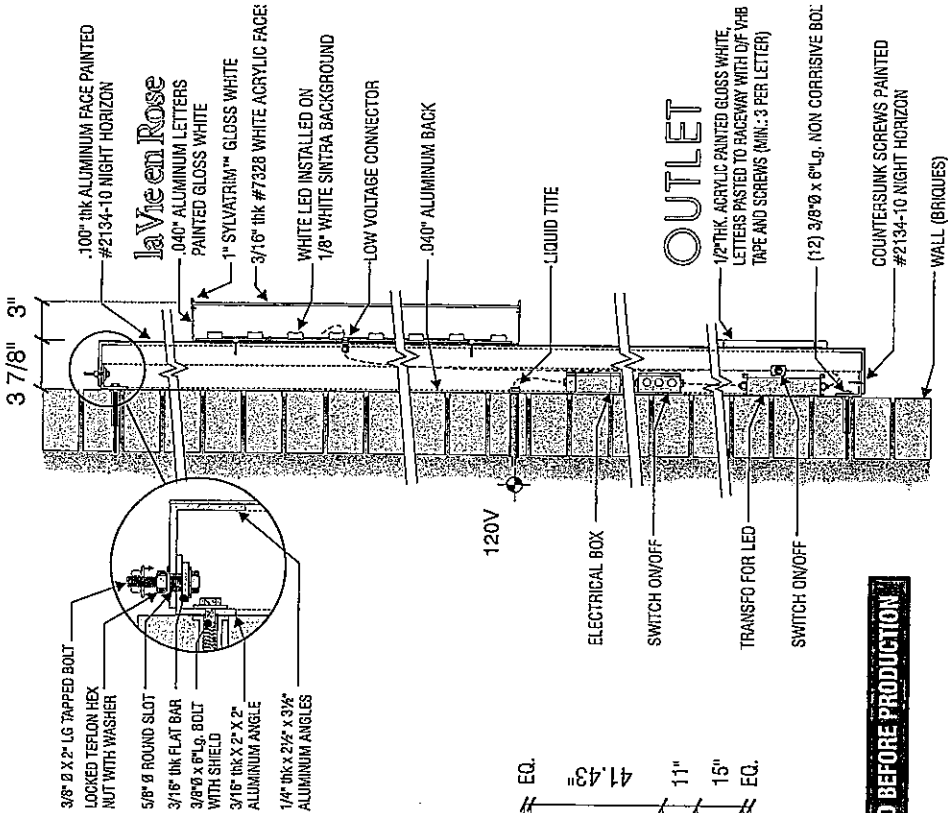

A Typical Cross Section Scale: 1" = 1'-0"

Access
Your Sign Department
www.accesssigns.com
2351 Fernside-Lafontaine Blvd, Longueville, QC J4H 1R7
tel: 450.674.3333 / 888.655.6866 / fax: 450.674.4098

laVie en Rose - COLLOSSUS CENTRE
7575 Weston Road,
Vaughan ON - L4L 9J9
Date: 2011-07-21
Request #4227 Page: 3/7

Revisions	Date
New dimensions sign-A2 (IVA)	2011-09-15
New dimensions sign-A (IVA)	2011-08-11
New dimensions sign-A (IVA)	2011-08-10

CUSTOMER APPROVAL

Signature _____

Printed name please _____

#2134-10 NIGHT HORIZON
BENJAMIN MOORE

This artwork is protected by copyright.
All rights reserved by Access Signs Inc.
LVRT11_ColossusCentre_Vaughan_ON_rev05

PRELIMINARY

FINAL

A2

CHANNEL LETTERS
WITH CUT-OUT LETTERS
ON RACEWAY

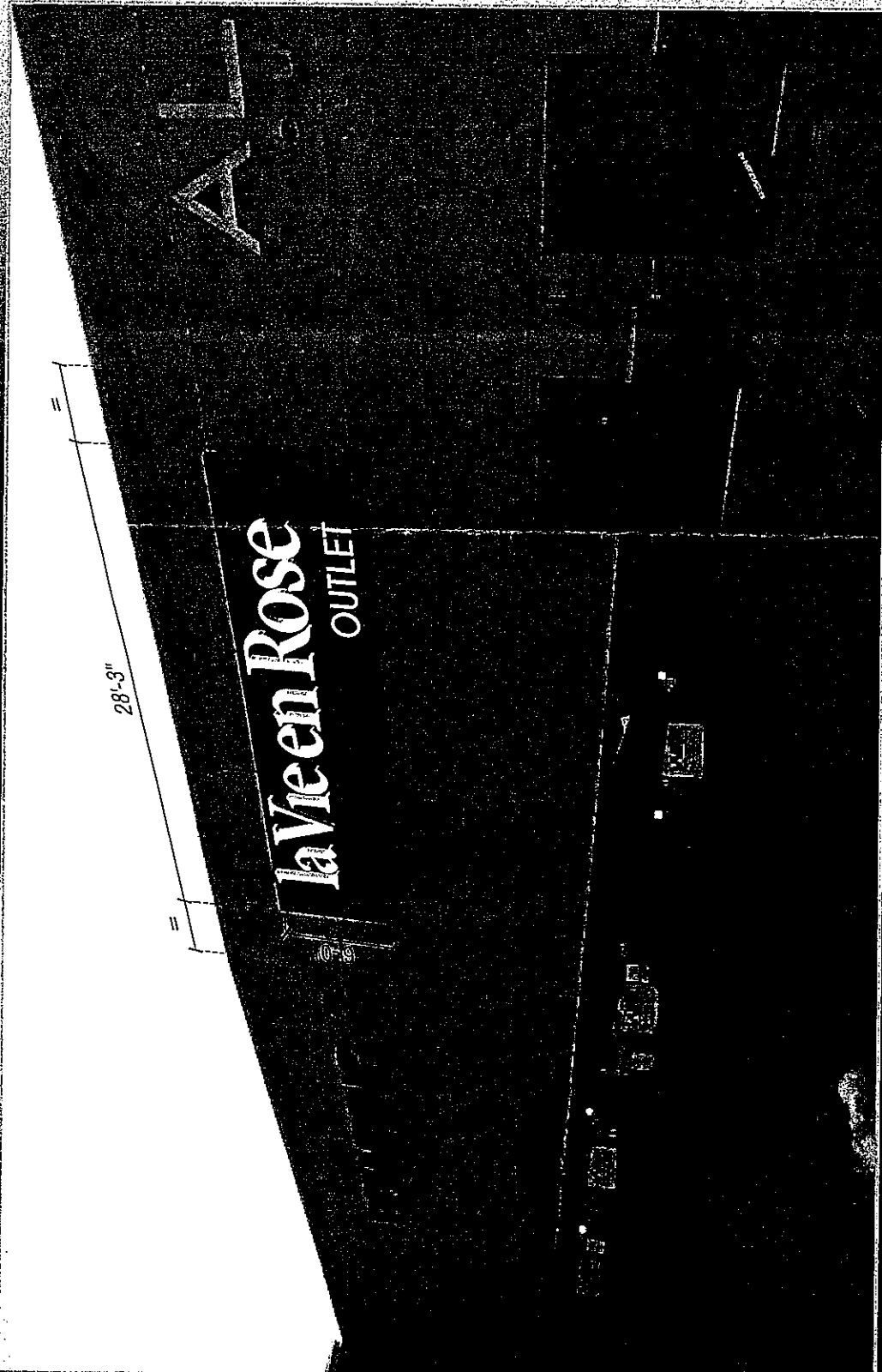

SV-11-037

REAR ELEVATION - SIGN LOCATION

This artwork is protected by copyright.
All rights reserved by Access Signs Inc.

WER11_ColossusCentre_Vaughn ON_rev05

PRELIMINARY
 FINAL

CUSTOMER APPROVAL

Signature _____
Printed name please _____

Revisions	Date
New dimensions sign-A2 (JVA)	2011-09-15
New dimensions sign-A (JVA)	2011-08-11
New dimensions sign-A (JVA)	2011-08-10

laVeenRose
 LA VEE EN ROSE Outlet - COLOSSUS CENTRE
 4575 Weston Road,
 Vaughn ON - L4L 9J9
 Designer: M. Tremblay
 Acc. Rep: Tammi Derison, U.I. #E183093
 Date: 2011-07-21
 Request #4227 Page: 2/7

ACCESS
 Your Sign Department
 www.accesssigns.com
 2351 Fernside-Lafontaine Blvd, Longueville, QC L4H 1W7
 Tel: 450.674.5553 / 888.655.6666 / Fax: 450.674.4098