

COMMITTEE OF THE WHOLE – JUNE 19, 2012

PROPOSED STORM WATER MANAGEMENT POND NAMES

Recommendation

The Commissioner of Engineering and Public Works recommends:

That subject to any amendments or changes that Council may wish to make, the attached list of storm water management pond names be approved.

Contribution to Sustainability

Storm water management ponds are vital in mitigating the threat of flooding by slowing the flow of water into local creeks and rivers. They also serve to improve downstream water quality by allowing suspended materials to settle out of the water over time.

In many locations, these ponds are a dominant feature in the area that attracts the attention of the public. By naming and signing these ponds, a sense of place will be created.

Economic Impact

The necessary funds to place the appropriate pond name signage have been approved as part of the 2012 Water / Wastewater Budget.

Communications Plan

Public Works will work with Corporate Communications to develop a communications strategy to advise the public, and map producers and providers, of this initiative, once the pond names have been approved.

Purpose

To present Council with the list of proposed pond names for approval.

Background - Analysis and Options

At its meeting of May 15, 2012, Committee of the Whole recommended:

- 1) *That the recommendations contained in the following report of the Commissioner of Engineering and Public Works, dated May 15, 2012, be approved;*
- 2) *That the following recommendations, in accordance with Communication C9, memorandum from the Commissioner of Engineering and Public Works, dated May 8, 2012, be approved; and*
- 3) *That, where staff deem appropriate, additional pond name signage be placed close to the life saving stations; and*
- 4) *That the revised Additional Resource Request concerning the installation of signage at the City's storm water management ponds be approved; and*
- 5) *That no naming occur until staff report back to the June 5, 2012 Committee of the Whole meeting with a list of proposed names.*

In response to recommendation No. 5, staff have reviewed documentation to find any existing names that may exist for storm water management ponds, and compiled a list of proposed names, based on the draft naming policy put forward at the May 15, Committee of the Whole meeting.

In compiling the list of pond names, dry ponds, were not included. As their name implies, most of the time, these ponds contain no water. As such, placing signage indicating them to be a "pond" may be inappropriate.

The proposed names are attached to this report for Council consideration and approval. Should Council wish to amend the list of proposed names, staff will incorporate the changes prior to placing the order for the signs and finalizing the communications plan.

Relationship to Vaughan Vision 2020/Strategic Plan

This report is consistent with the priorities previously set by Council and ties into the following Vaughan Vision 20/20 Goals and Objectives:

Goal: Organizational Excellence
Objective: Manage Corporate Assets

Regional Implications

There are no Regional implications as a result of the recommendations contained in this report.

Conclusion

In accordance with the direction given at the May 15, 2012 Committee of the Whole meeting, staff has prepared the list of proposed pond names for approval. Should Council wish to amend the list of proposed names, staff will incorporate the changes prior to placing the order for the signs and finalizing the communications plan.

Attachments

Attachment 1 – List of Proposed Pond Names

Attachment 2 – Proposed Pond Name Location Maps

Report prepared by:

Robert Meek, CET, Manager of Environmental & Technical Services, Ext 6100
Brian T. Anthony, Director of Public Works, Ext 6116

Respectfully submitted,

Paul Jankowski, P. Eng.
Commissioner of Engineering & Public Works

Brian T. Anthony, CRS-S, C. Tech
Director of Public Works

Attachment 1

List of Proposed Pond Names

| BLOCK | PROPOSED POND NAME |
|--------------|-----------------------------------|
| 2 | OAKBANK POND |
| 9 | SADOT POND |
| 9 | RACCO PARKWAY POND |
| 9 | SUGARBUSH POND |
| 10 | DUFFERIN / APPLE BLOSSOM POND |
| 10 | AUTUMN HILL POND |
| 10 | SAGECREST POND |
| 11 | GEORGE KIRBY POND N. |
| 11 | THOMAS COOK / WOLFCREEK POND |
| 11 | CRIMSON FOREST / APPLE GROVE POND |
| 11 | MARC SANTI POND W. |
| 11 | MARC SANTI POND E. |
| 11 | THOMAS COOK / RANDOLPH POND |
| 11 | UPPER POST POND |
| 11 | RUTHERFORD / ILAN RAMON POND |
| 11 | GEORGE KIRBY POND S |
| 11 | SOUTHVALE POND |
| 12 | HEINTZMAN POND |
| 12 | LADY VALENTINA POND S. |
| 12 | MAJOR MACKENZIE / SIR BENSON POND |
| 12 | DUFFERIN / QUEEN FILOMENA POND |
| 12 | VIA ROMANO POND |
| 12 | LADY FENYROSE POND |
| 12 | LADY VALENTINA POND N. |
| 12 | DUFFERIN / LADY NADIA POND |
| 12 | SIR STEVENS POND |
| 12 | VANDA / ZORAN POND |
| 13 | WOODLAND ACRES POND |
| 15 | MARYTA PAYNE POND |
| 15 | GREAT GULF POND |
| 16 | AUDIA NORTH POND |
| 16 | AUDIA SOUTH POND |
| 16 | NORTH RIVERMEDE / 7 POND |
| 16 | RIVERMEDE POND |
| 17 | BASALTIC POND |
| 17 | FLORAL PARKWAY POND |
| 18 | FIELDGATE POND |
| 18 | RUTHERFORD / BARHILL POND |
| 18 | PETER RUPERT / GOLDEN FOREST POND |
| 18 | IVY GLEN POND |
| 18 | DUFFERIN / FREEDOM TRAIL POND |
| 18 | DUFFERIN / MAURIER POND |
| 18 | RUTHERFORD / PETER RUPERT NW POND |

| | |
|----|-----------------------------------|
| 18 | RUTHERFORD / PETER RUPERT NE POND |
| 20 | KEELE / PEAK POINT POND |
| 20 | MAPLEDOWN POND E. |
| 20 | MAPLEDOWN POND W. |
| 20 | VISTA POND |
| 20 | LAURENTIAN POND |
| 23 | LANGSTAFF / CREDITSTONE POND |
| 23 | JANE / 7 POND |
| 24 | TIGI POND |
| 24 | GRANITERIDGE POND |
| 25 | PARKTREE POND |
| 25 | SPRINGSIDE POND |
| 25 | BEVAN POND |
| 25 | J.O.C POND |
| 25 | LARISSA POND |
| 25 | YORK REGION POND |
| 26 | MCNAUGHTON POND |
| 26 | SOLWAY POND |
| 26 | SANDWAY POND |
| 26 | KETTLE POND |
| 26 | GLENKINDIE POND |
| 26 | SIERRA POND |
| 26 | CUNNINGHAM POND |
| 26 | MAJOR MACKENZIE / MELVILLE POND |
| 26 | MAJOR MACKENZIE / JANE POND |
| 26 | WILLOW TREE POND |
| 26 | FLETCHER POND N. |
| 26 | FLETCHER POND S. |
| 26 | SILMORO POND |
| 26 | ST JOAN OF ARC POND |
| 29 | EXCHANGE WAY POND |
| 29 | COLOSSUS POND |
| 29 | PIONEER POND |
| 31 | FOUR VALLEY POND |
| 31 | CREDITVIEW POND |
| 32 | SUNVIEW POND |
| 32 | DEEPSPRINGS POND |
| 32 | WILDBERRY POND |
| 33 | TIERRA POND |
| 33 | DEL FRANCISCO POND |
| 33 | WESTON / RETREAT POND |
| 33 | CITYVIEW POND |
| 34 | MATTUCCI POND |
| 36 | AVIVA PARK POND |
| 39 | RUTHERFORD / FOSSIL HILL POND |
| 43 | VENETO POND |
| 45 | CROFTERS POND |
| 46 | RUTHERFORD / PINE VALLEY POND |

| | |
|----|-------------------------------|
| 46 | RUTHERFORD / KEEGAN POND |
| 50 | REGINA POND |
| 51 | ASHBRIDGE POND |
| 52 | AVDELL POND |
| 52 | VAUGHAN MILLS POND |
| 53 | NAPA VALLEY / MONTEBELLO POND |
| 53 | CHALONE POND |
| 53 | RUTHERFORD / NAPA VALLEY POND |
| 54 | LESTER B PEARSON POND |
| 54 | WESTRIDGE / JOHN KLINE POND |
| 55 | RAINBOWS POND |
| 57 | ROYAL GROUP POND |
| 57 | HWY 27 / HWY 427 POND |
| 58 | VAUGHAN VALLEY POND |
| 58 | NEW ENTERPRISE POND N. |
| 58 | HUNTINGTON / LANGSTAFF POND |
| 58 | NEW ENTERPRISE POND S. |
| 62 | FOREST HEIGHTS POND |

CITY BLOCK NUMBER 2

Not To Scale

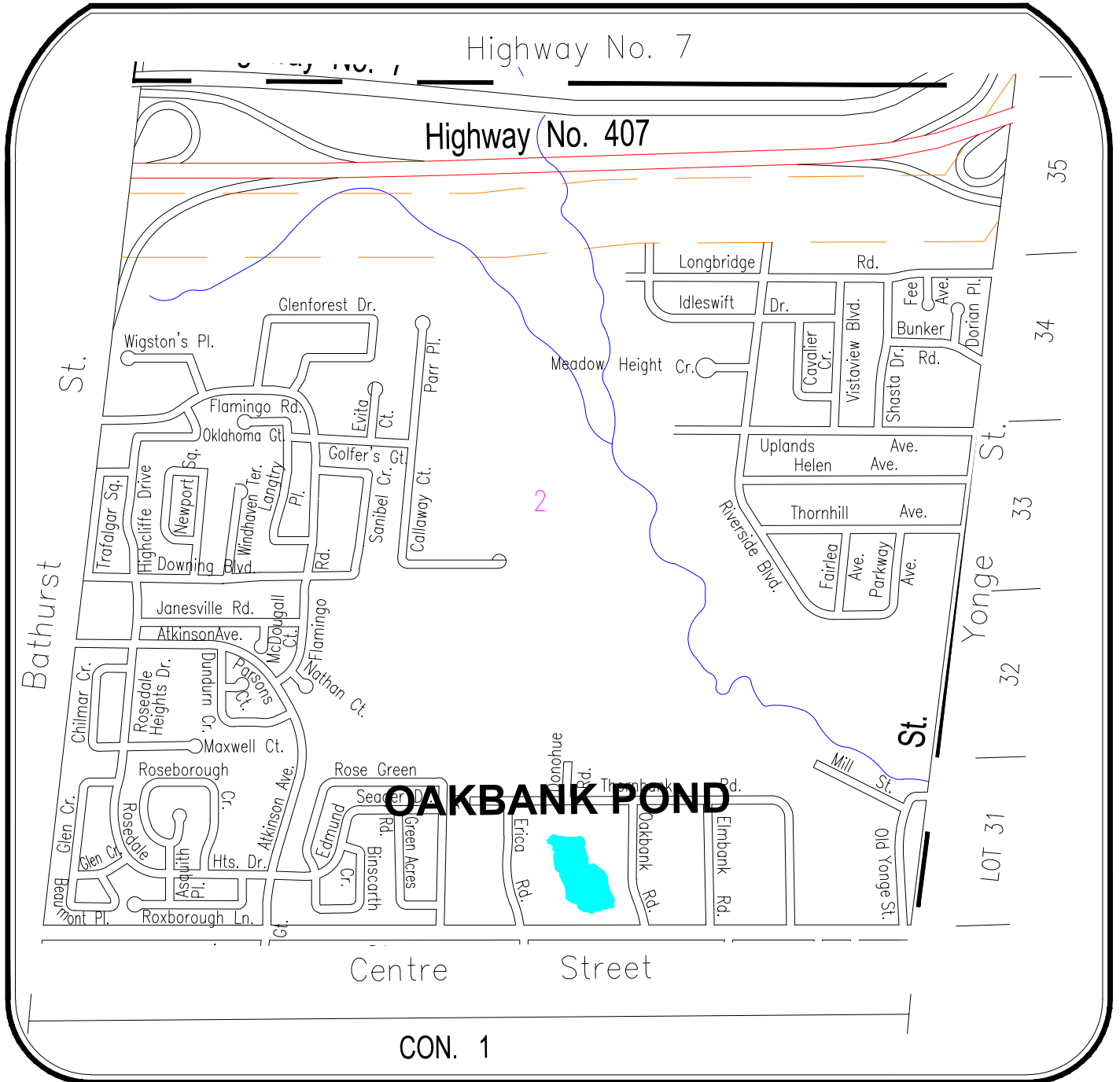
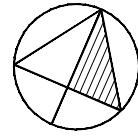

CITY BLOCK NUMBER 9

Not To Scale

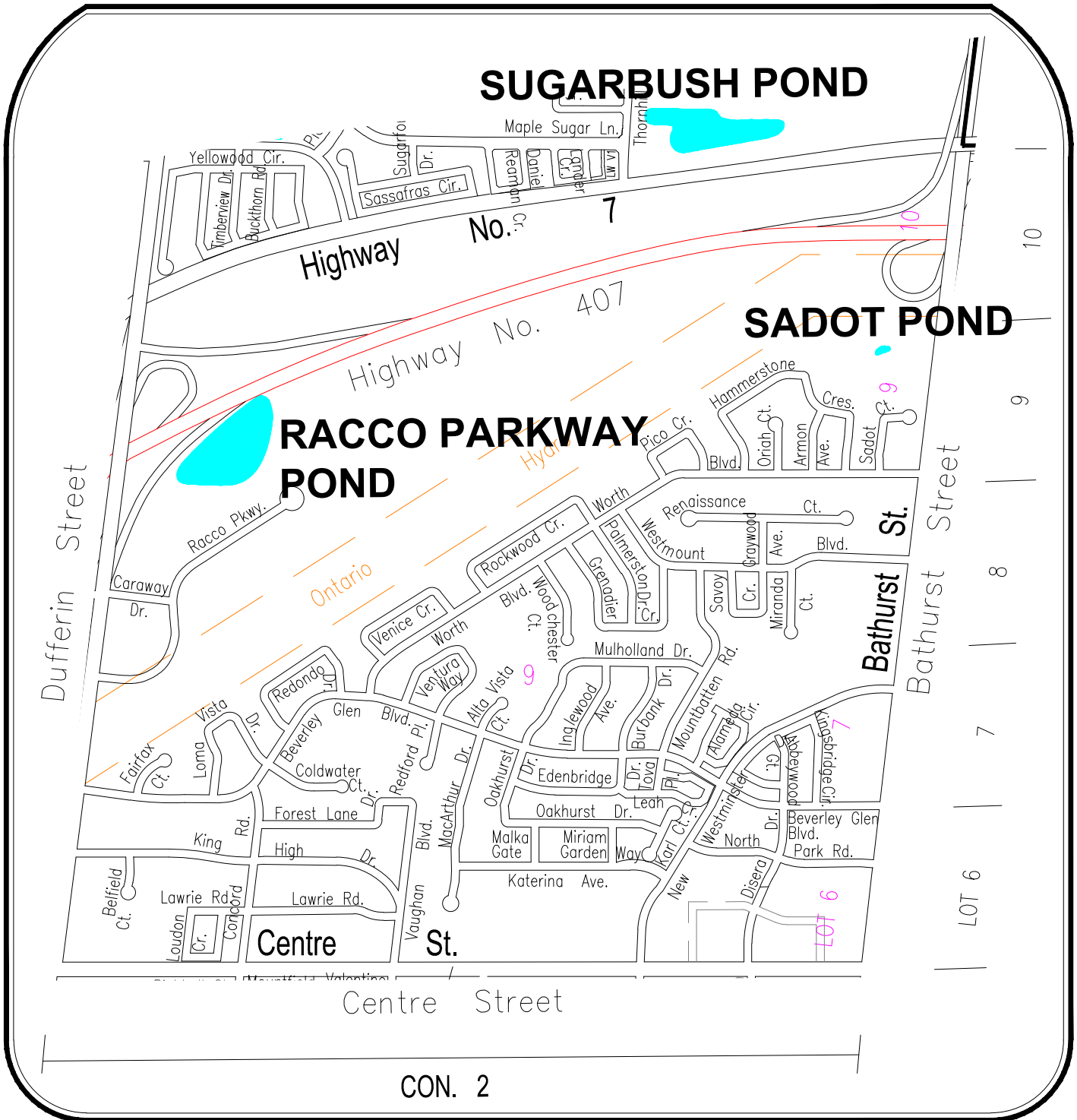
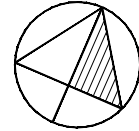

CITY BLOCK NUMBER 10

Not To Scale

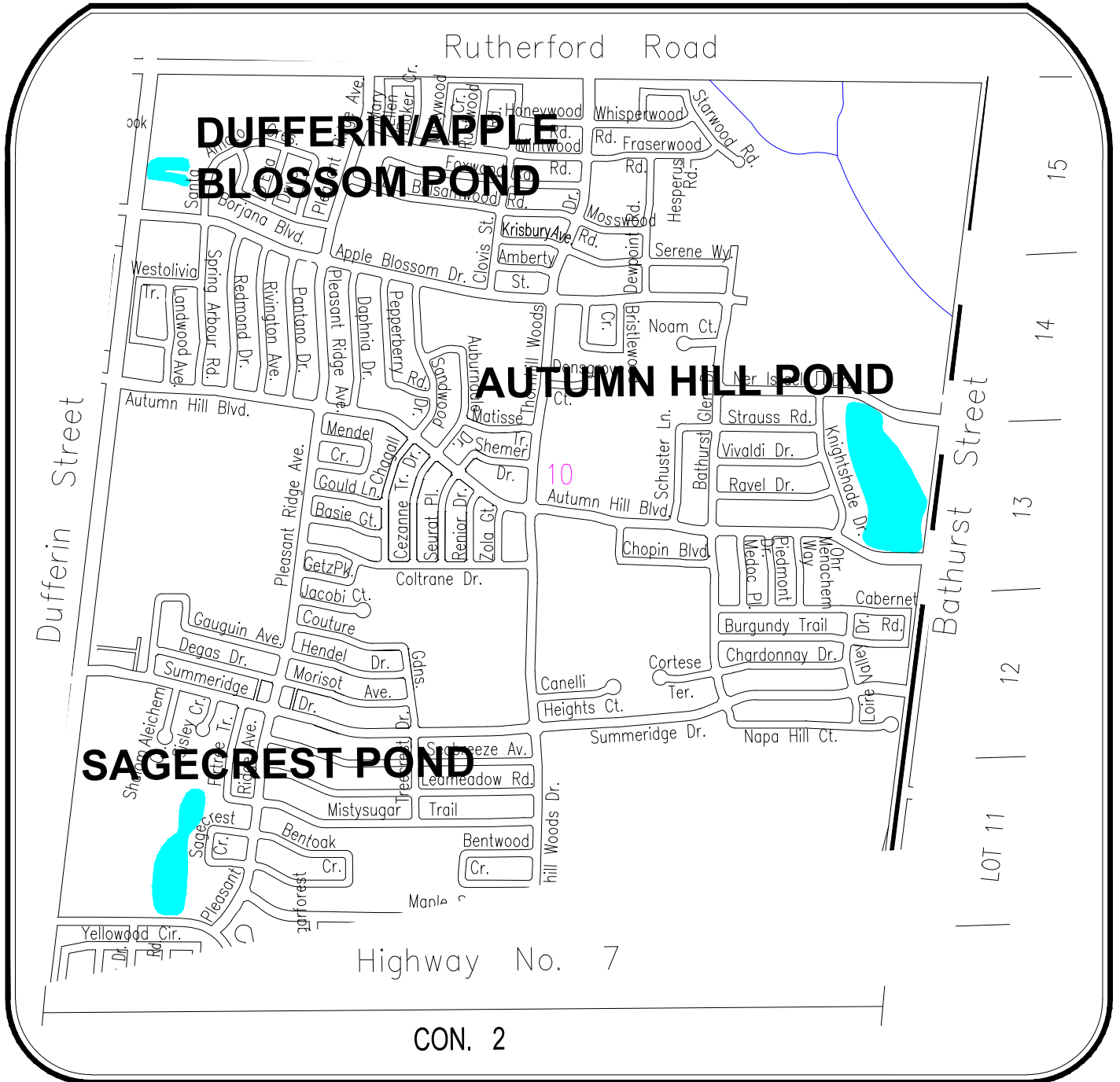
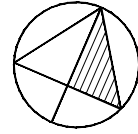

SAGECREST POND

DUFFERIN/APPLE BLOSSOM POND

AUTUMN HILL POND

Highway No. 7

CON. 2



Public Works
... Working For You!

CITY BLOCK NUMBER 11

Not To Scale

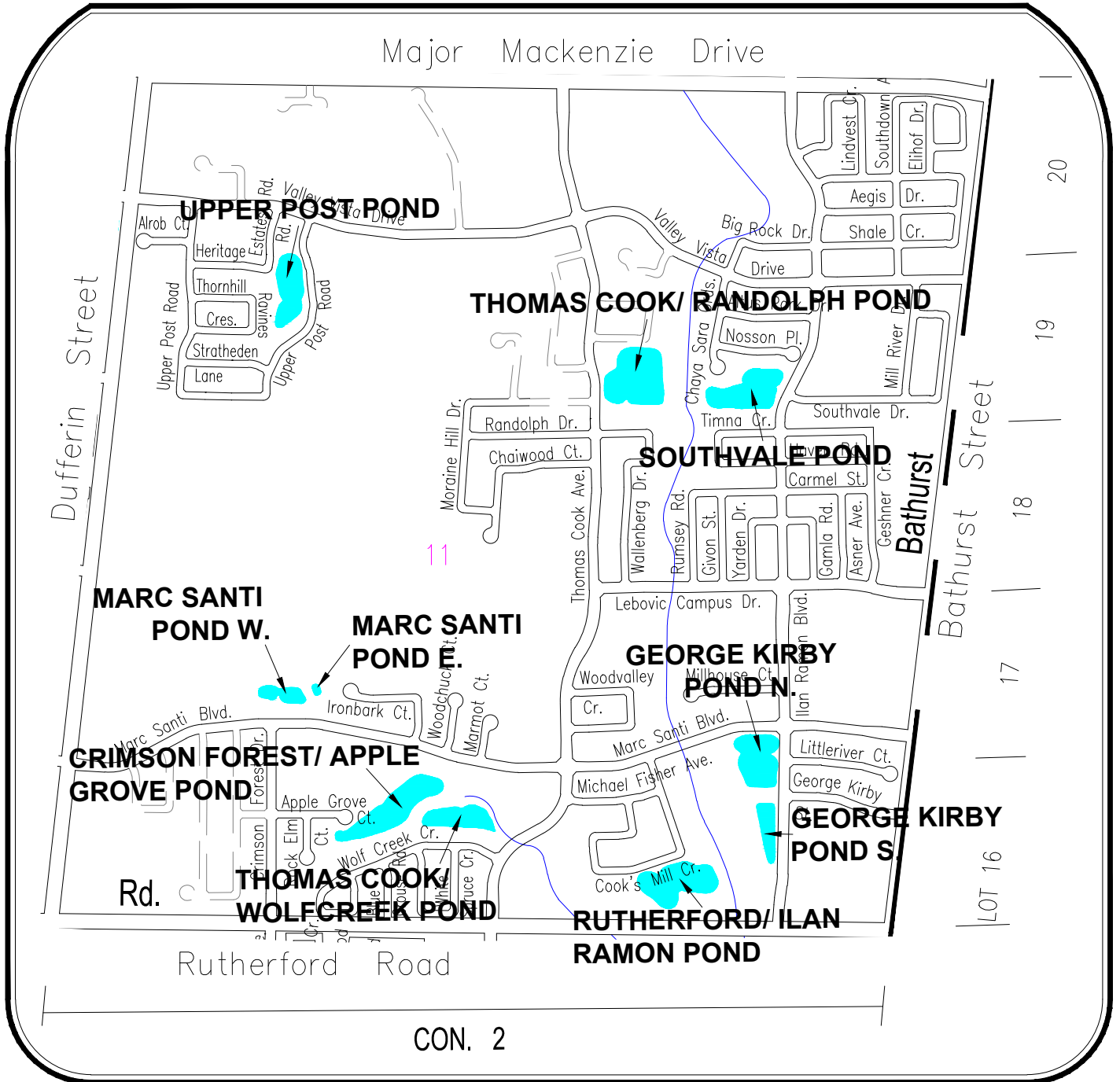
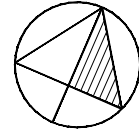

CITY BLOCK NUMBER 12

Not To Scale

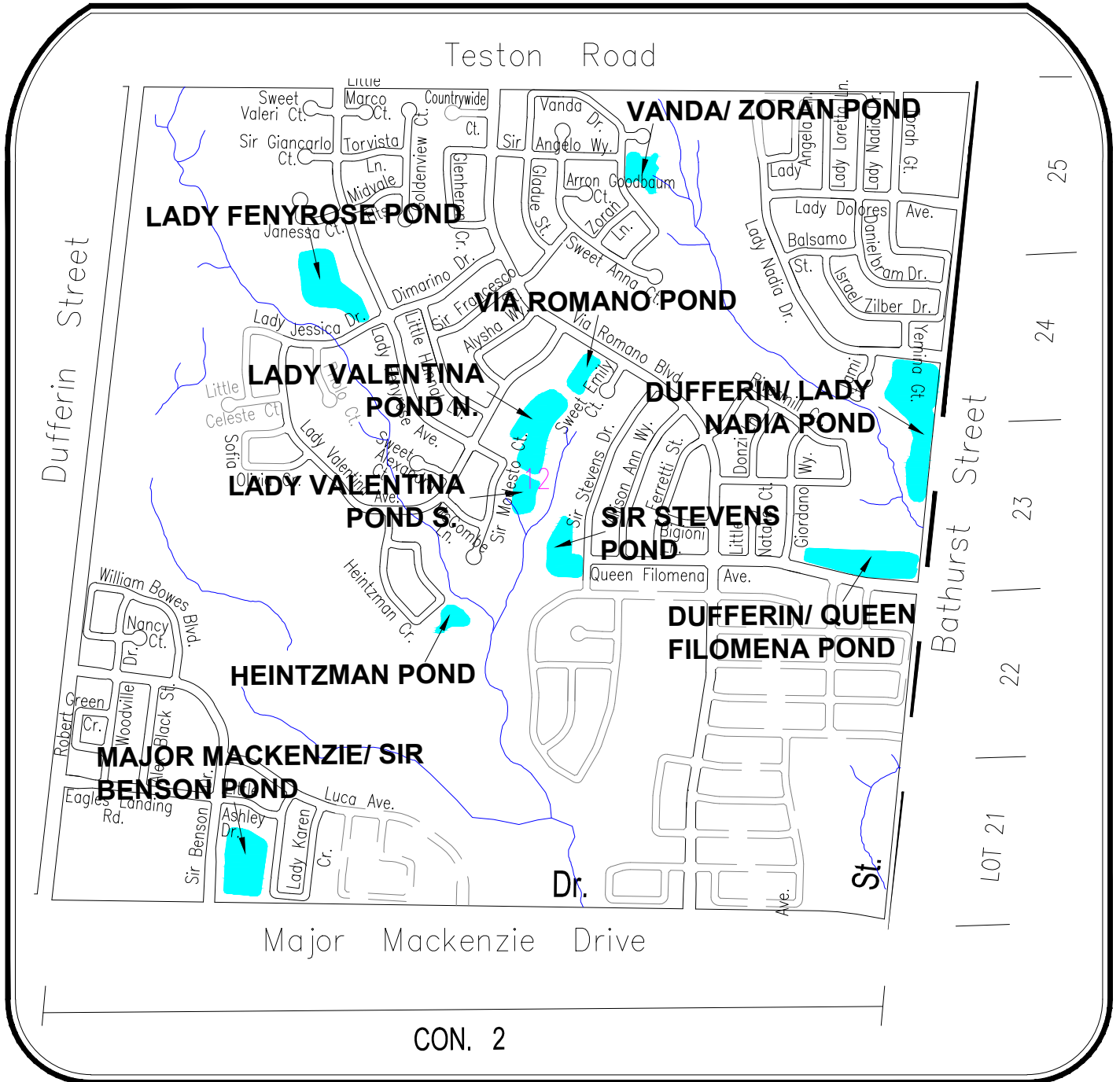
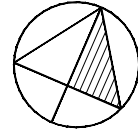

CON. 2

CITY BLOCK NUMBER 13

Not To Scale

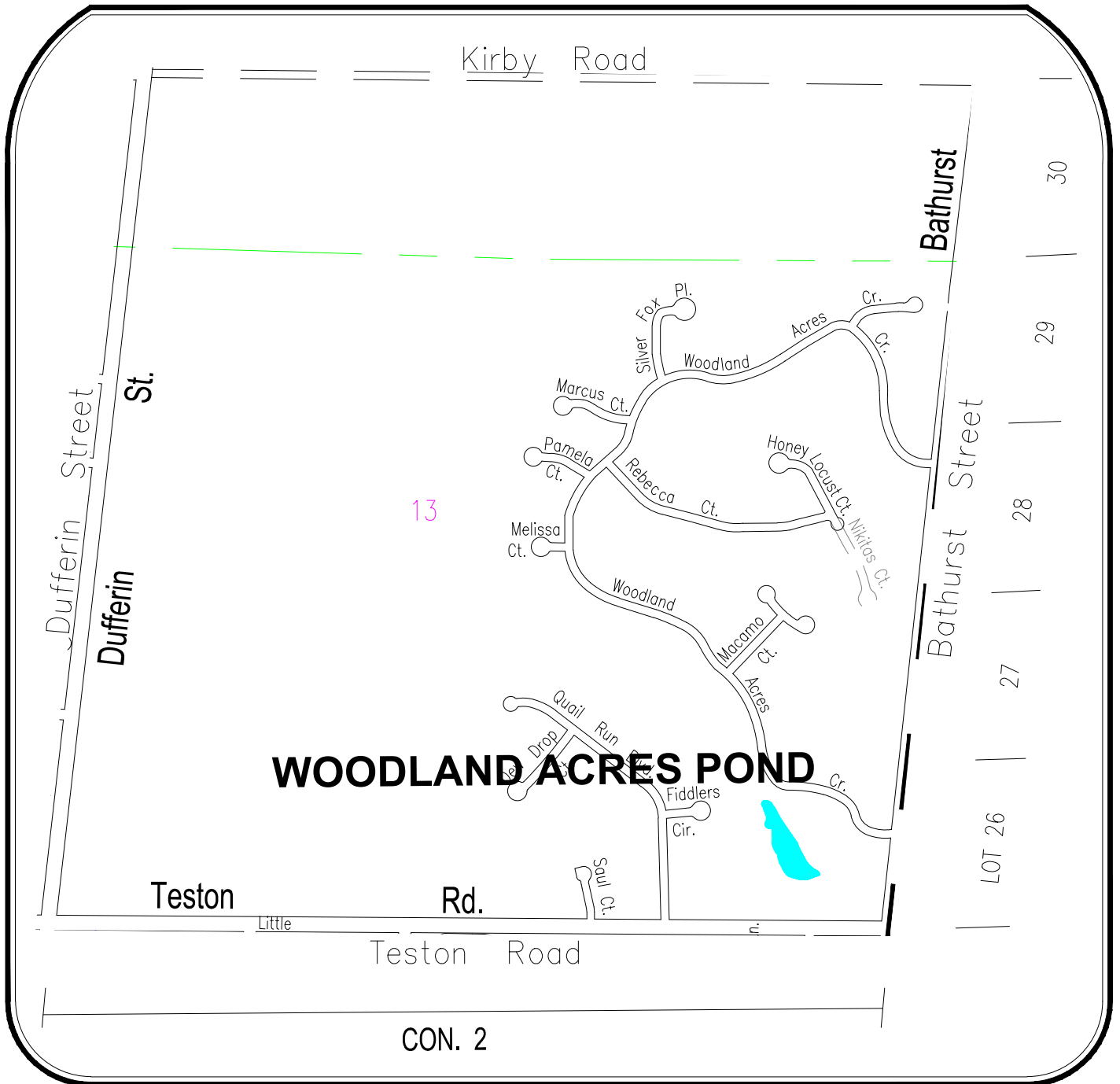
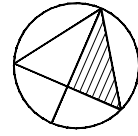

CITY BLOCK NUMBER 15

Not To Scale

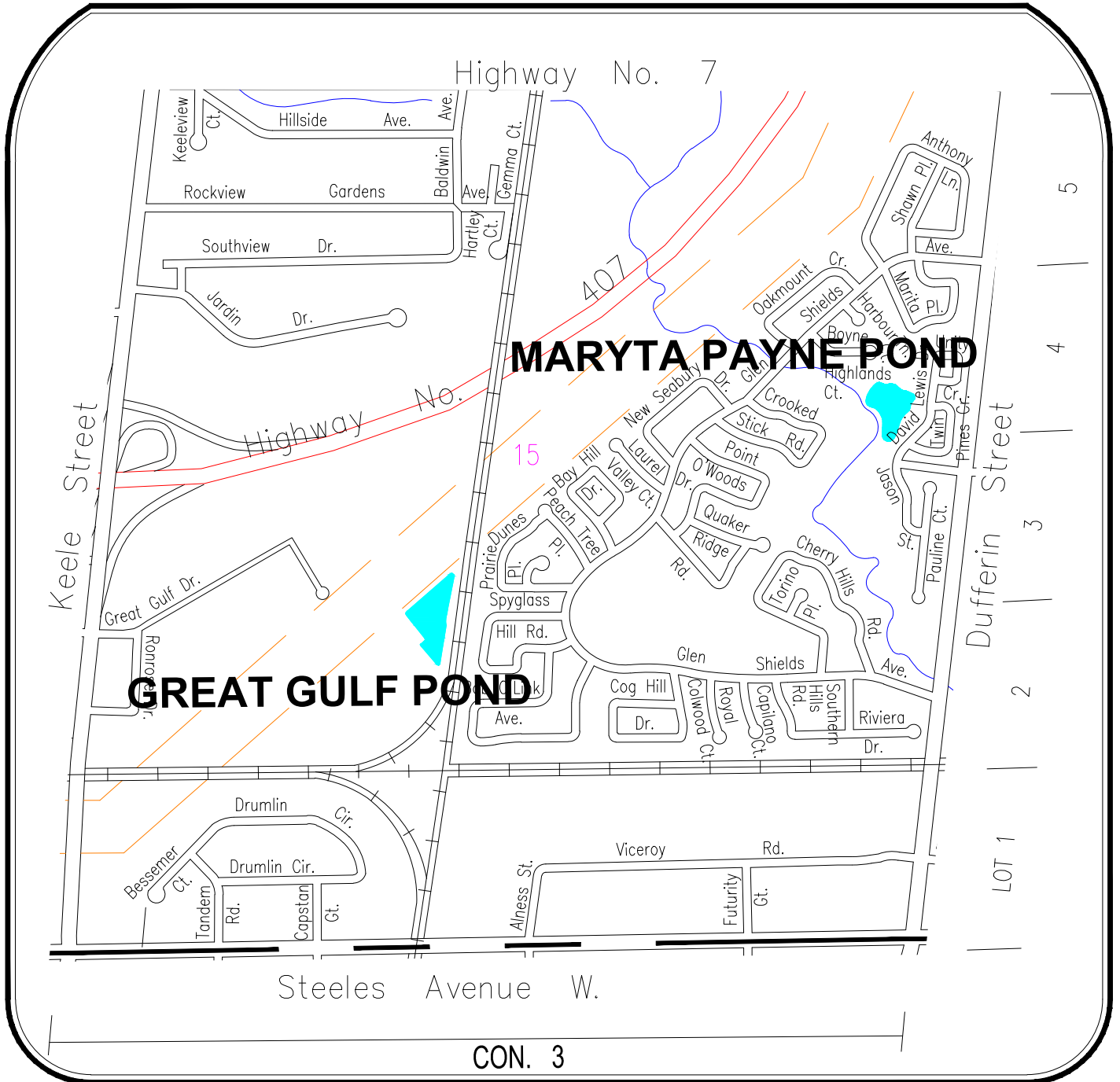
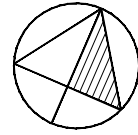

CITY BLOCK NUMBER 16

Not To Scale

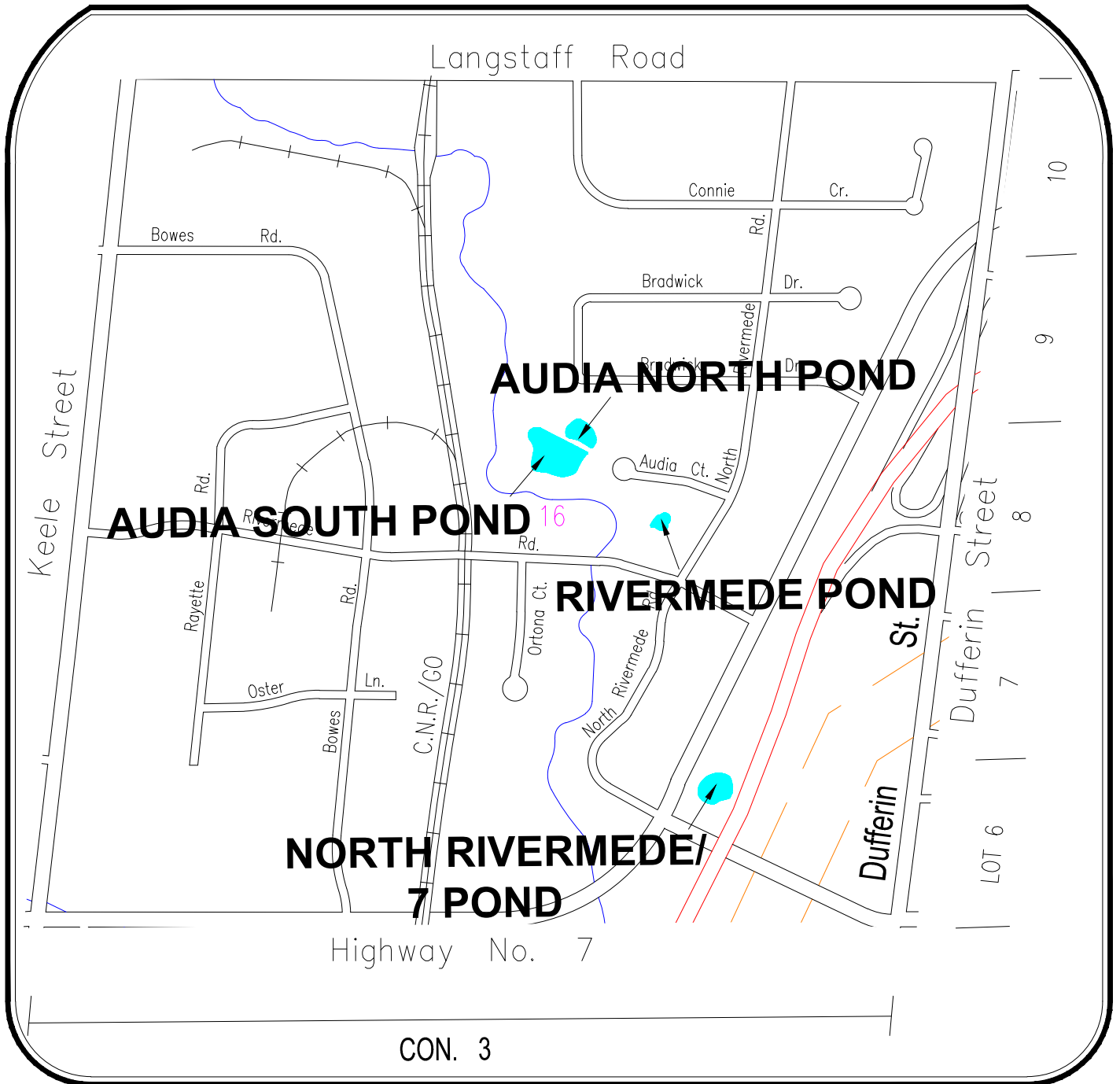
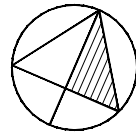

CITY BLOCK NUMBER 17

Not To Scale

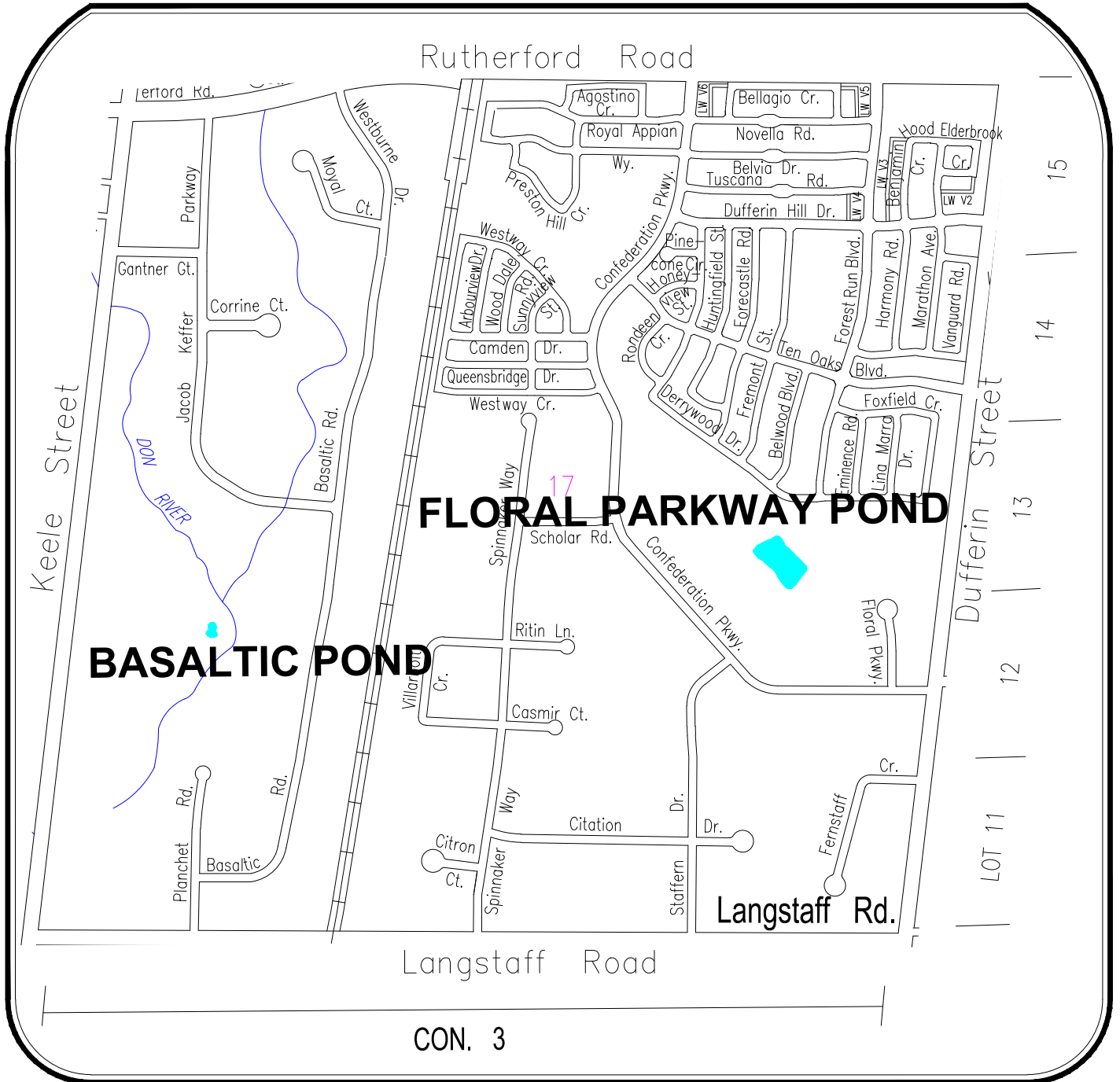
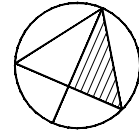

CITY BLOCK NUMBER 18

Not To Scale

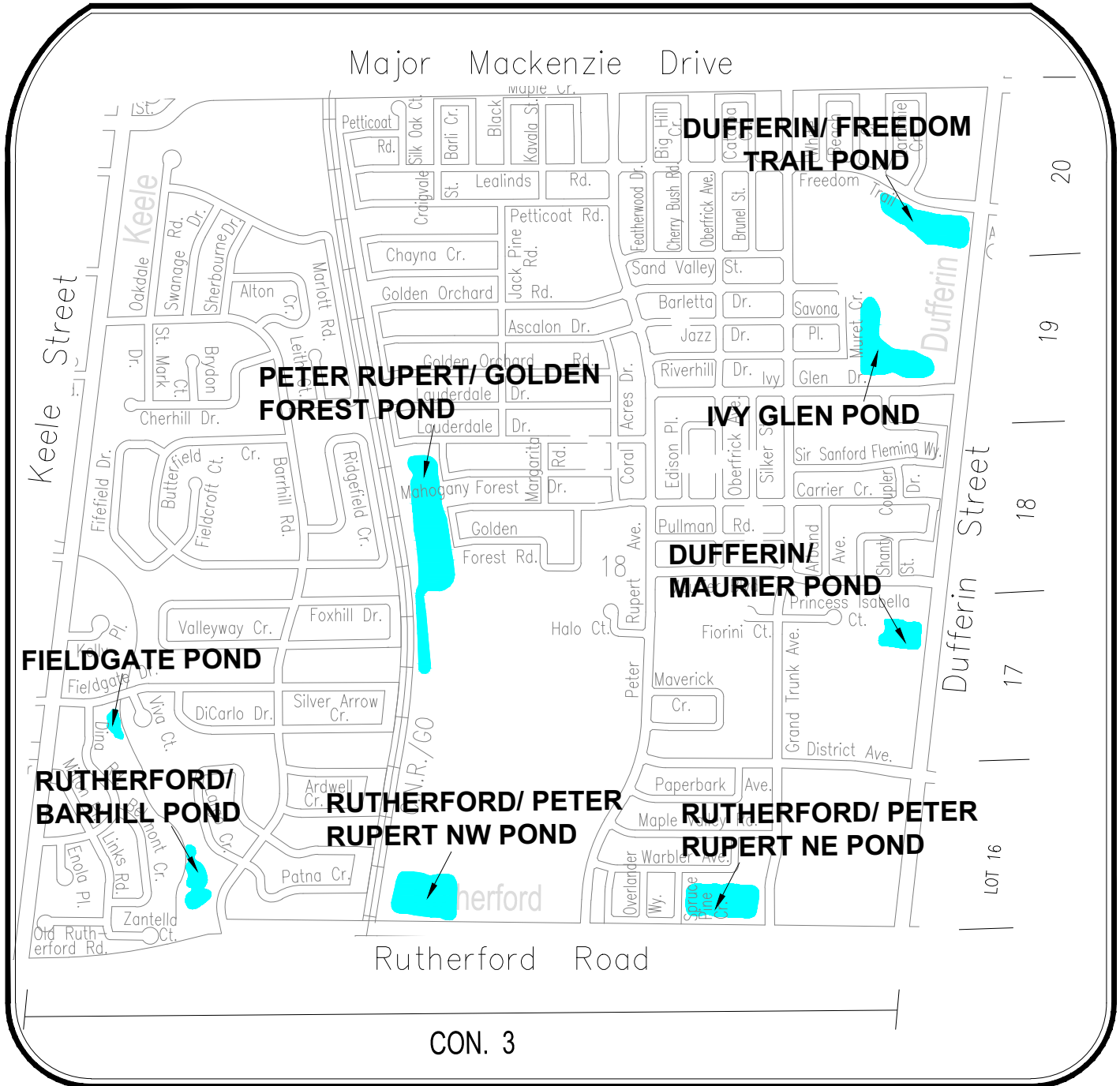
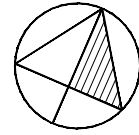

CITY BLOCK NUMBER 20

Not To Scale

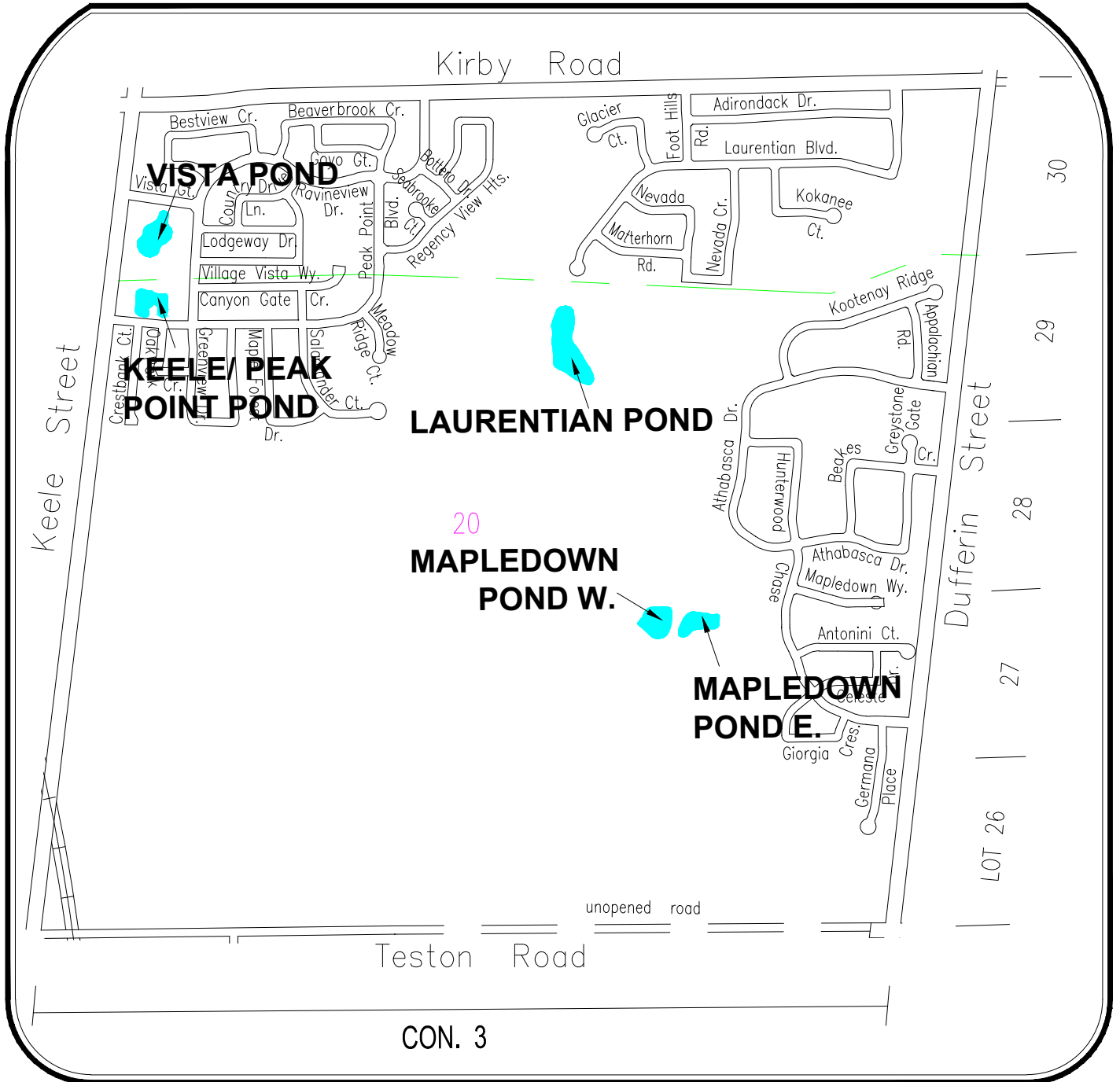
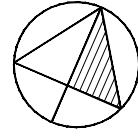

CITY BLOCK NUMBER 23

Not To Scale

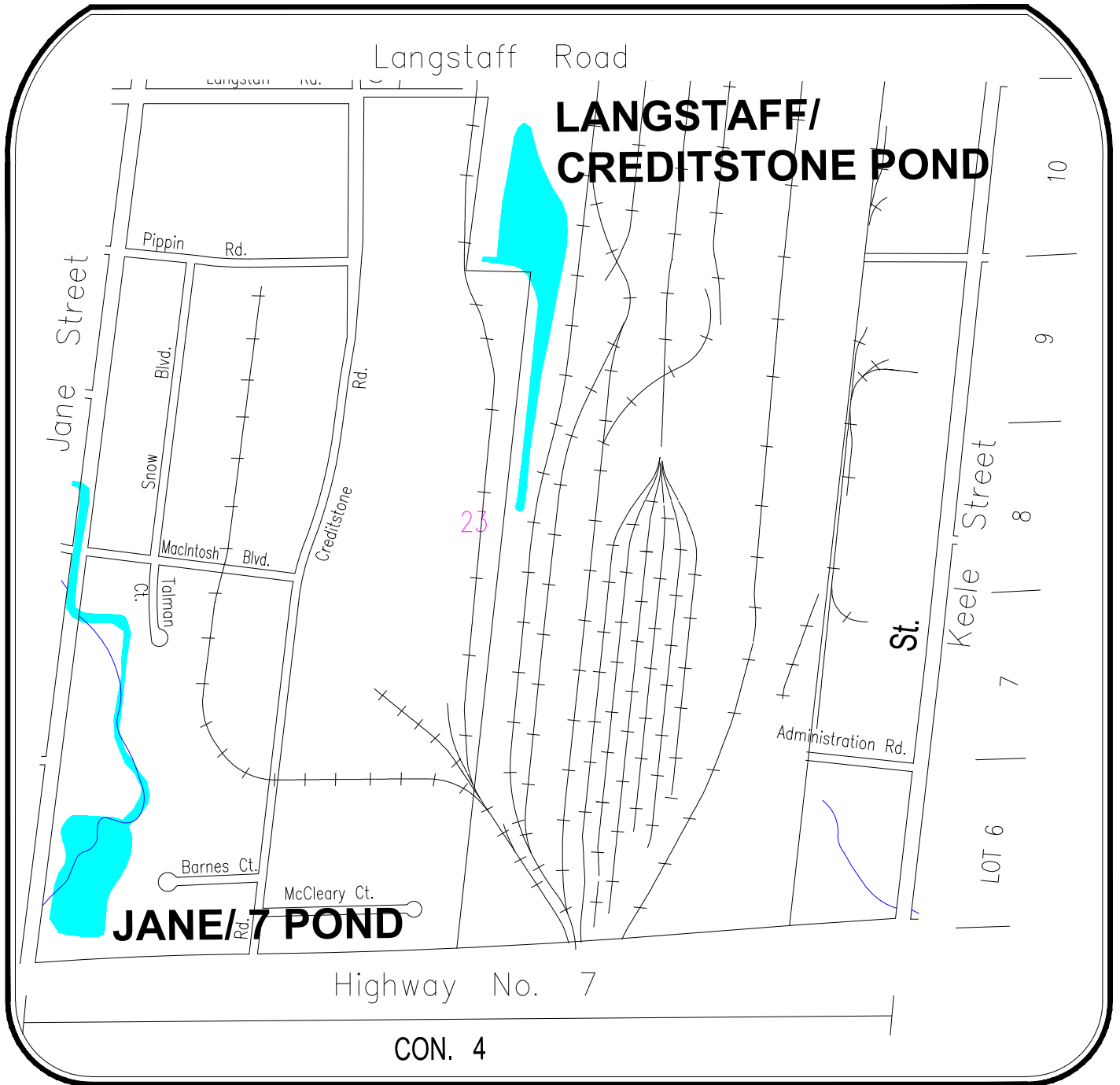
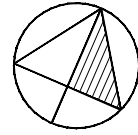

CITY BLOCK NUMBER 24

Not To Scale

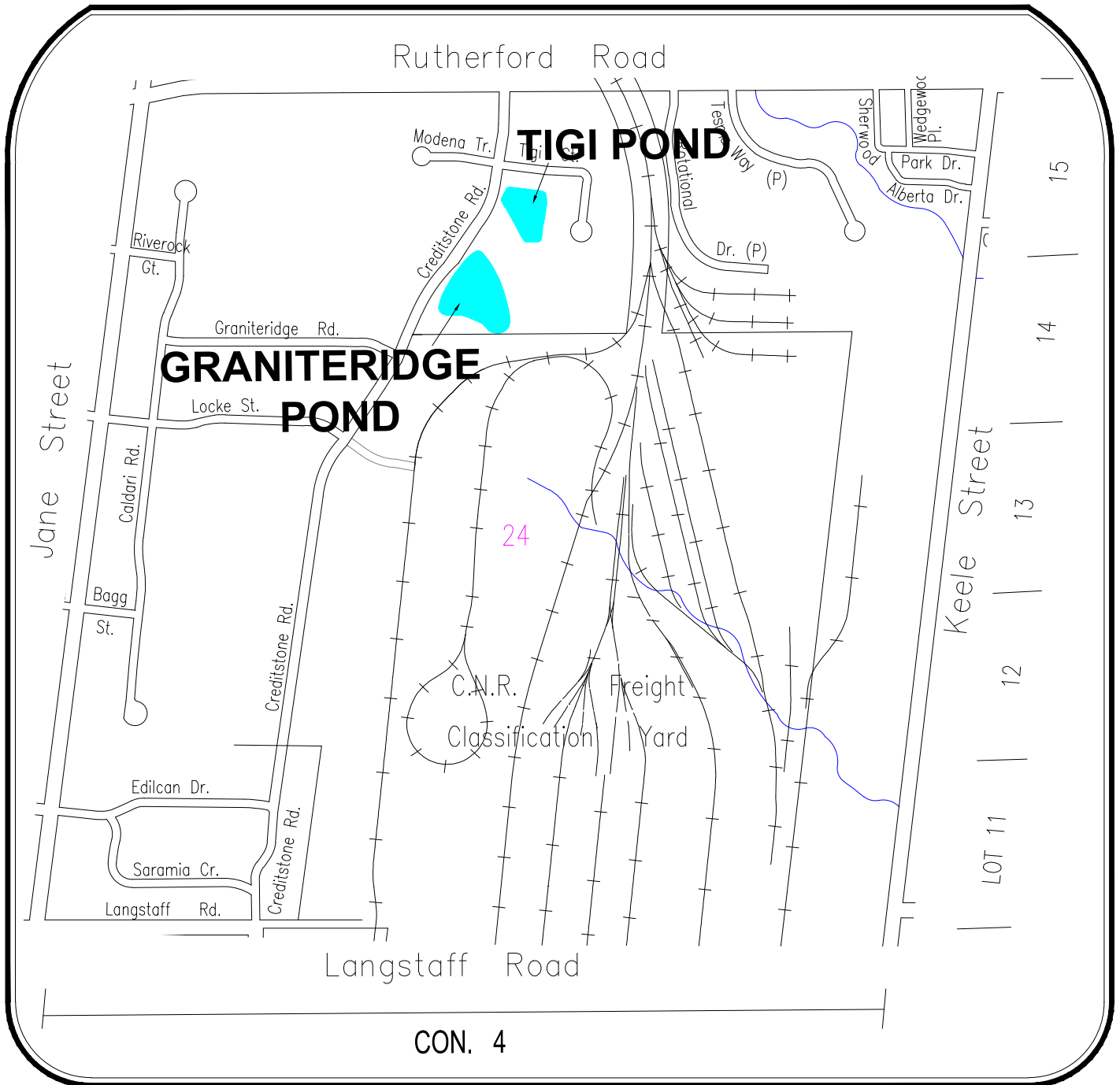
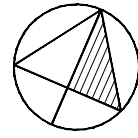

CITY BLOCK NUMBER 25

Not To Scale

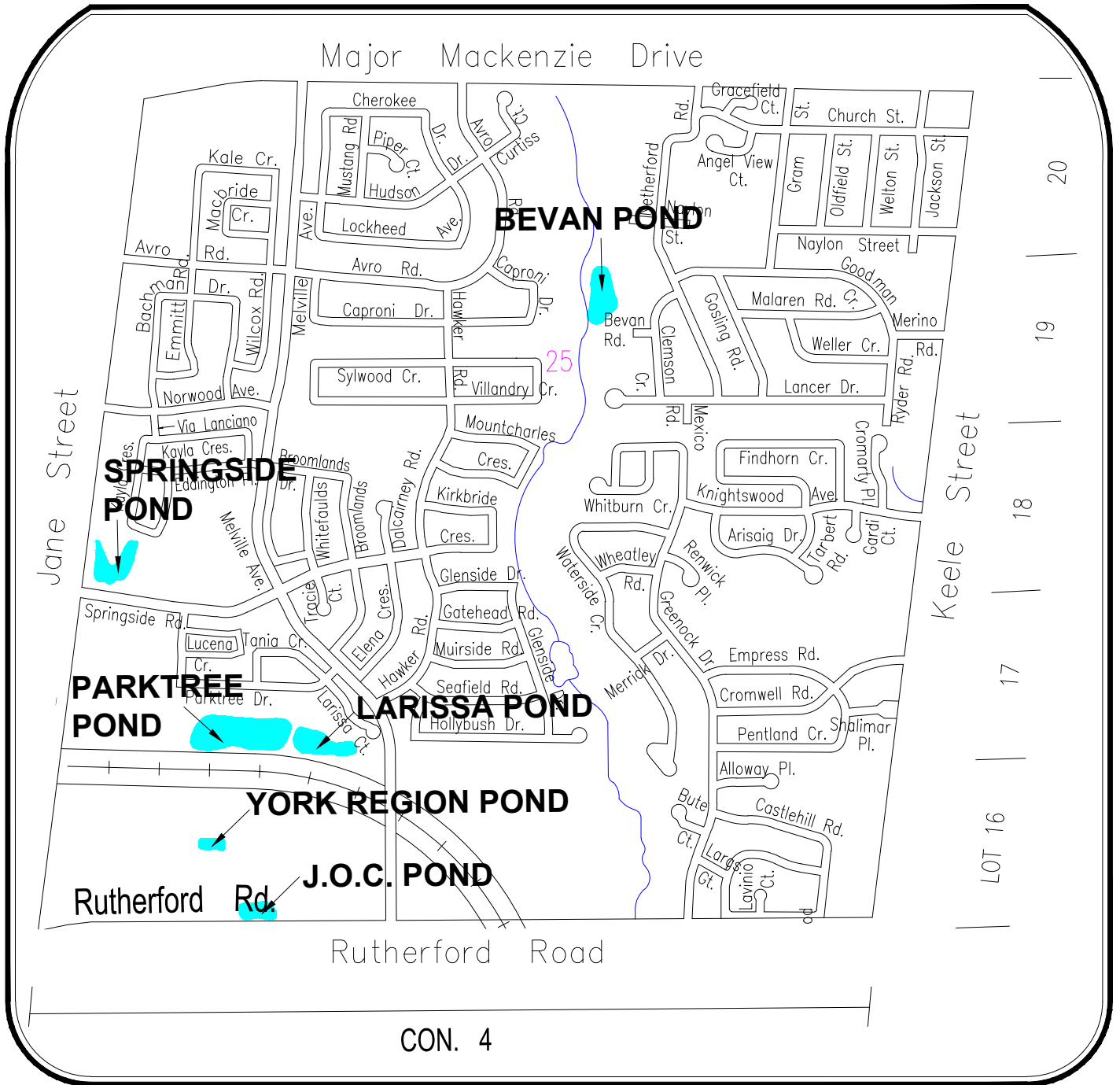
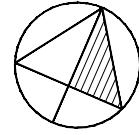

CITY BLOCK NUMBER 26

Not To Scale

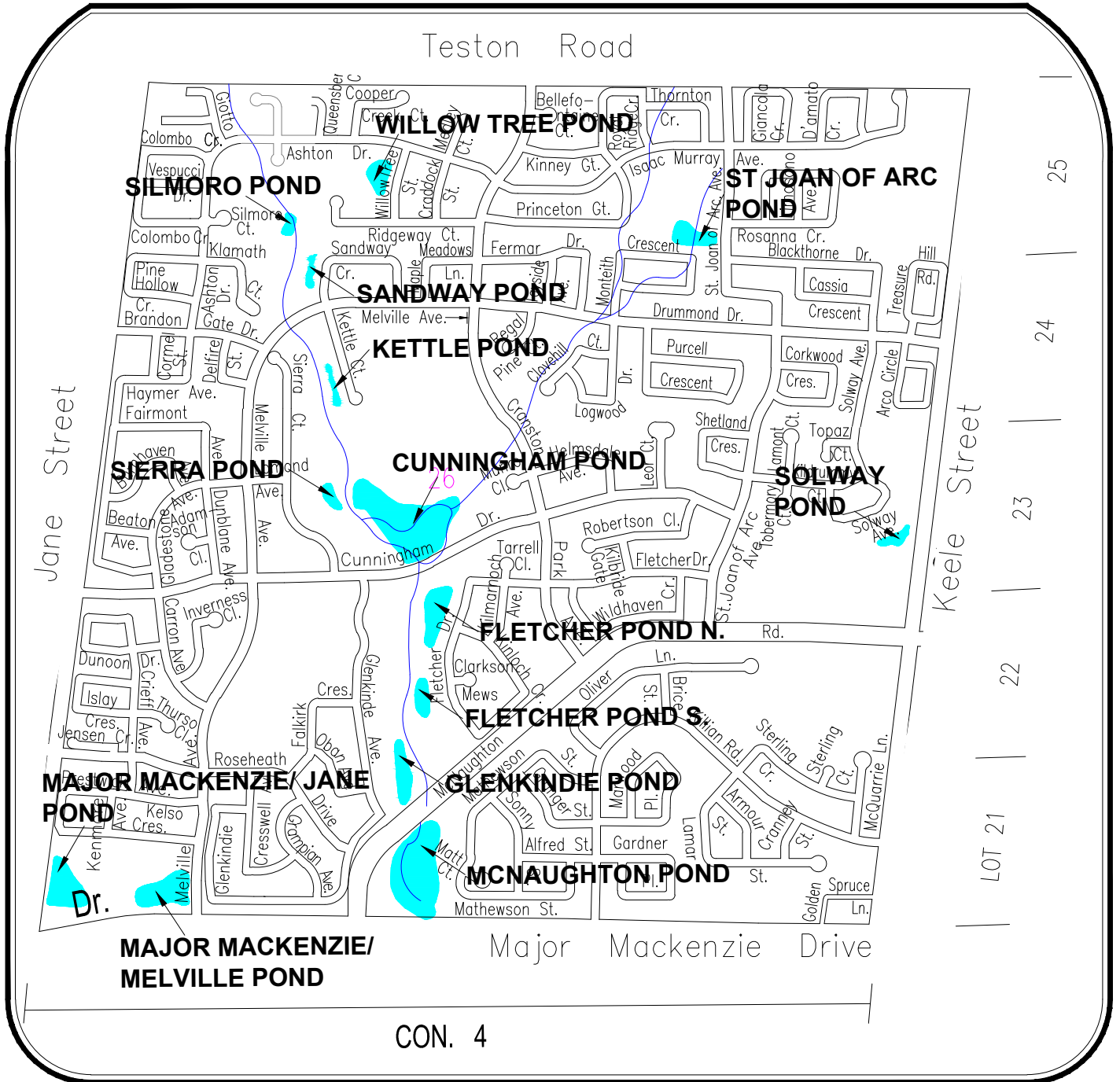
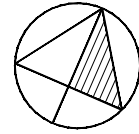

CON. 4

CITY BLOCK NUMBER 29

Not To Scale

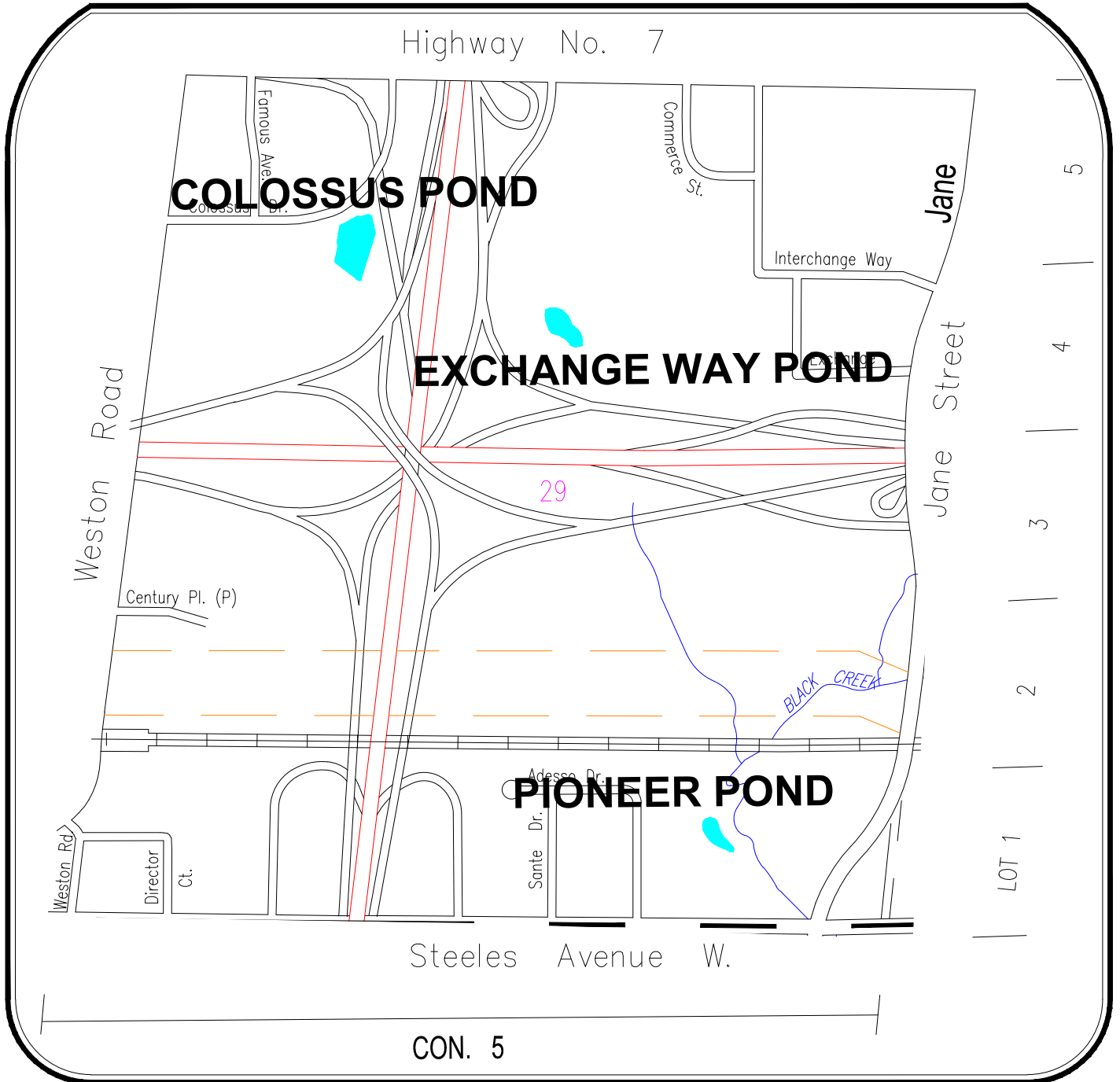
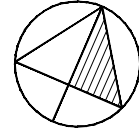

CITY BLOCK NUMBER 31

Not To Scale

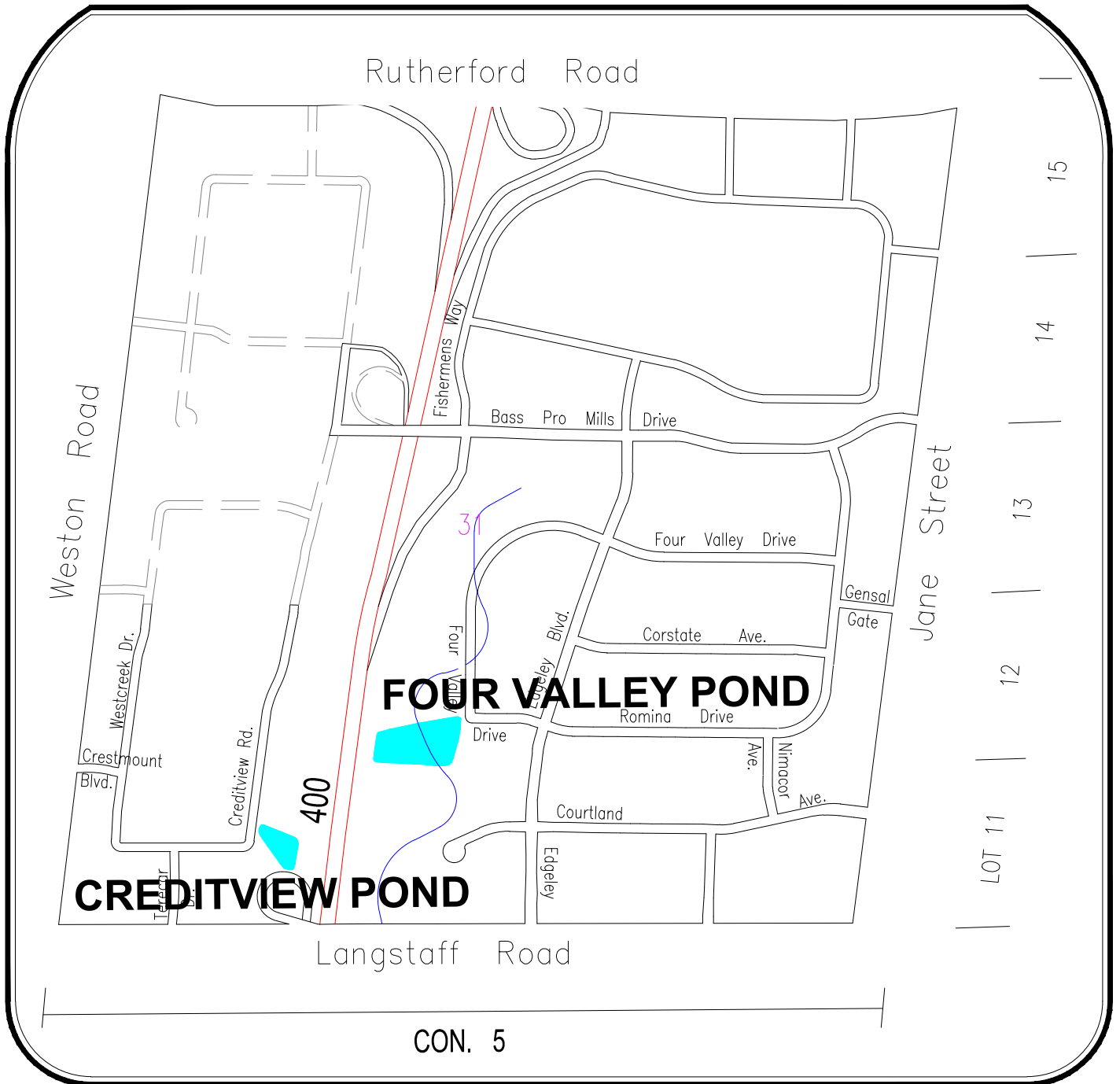
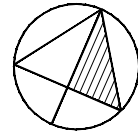

Public Works

... Working For You!

CITY BLOCK NUMBER 32

Not To Scale

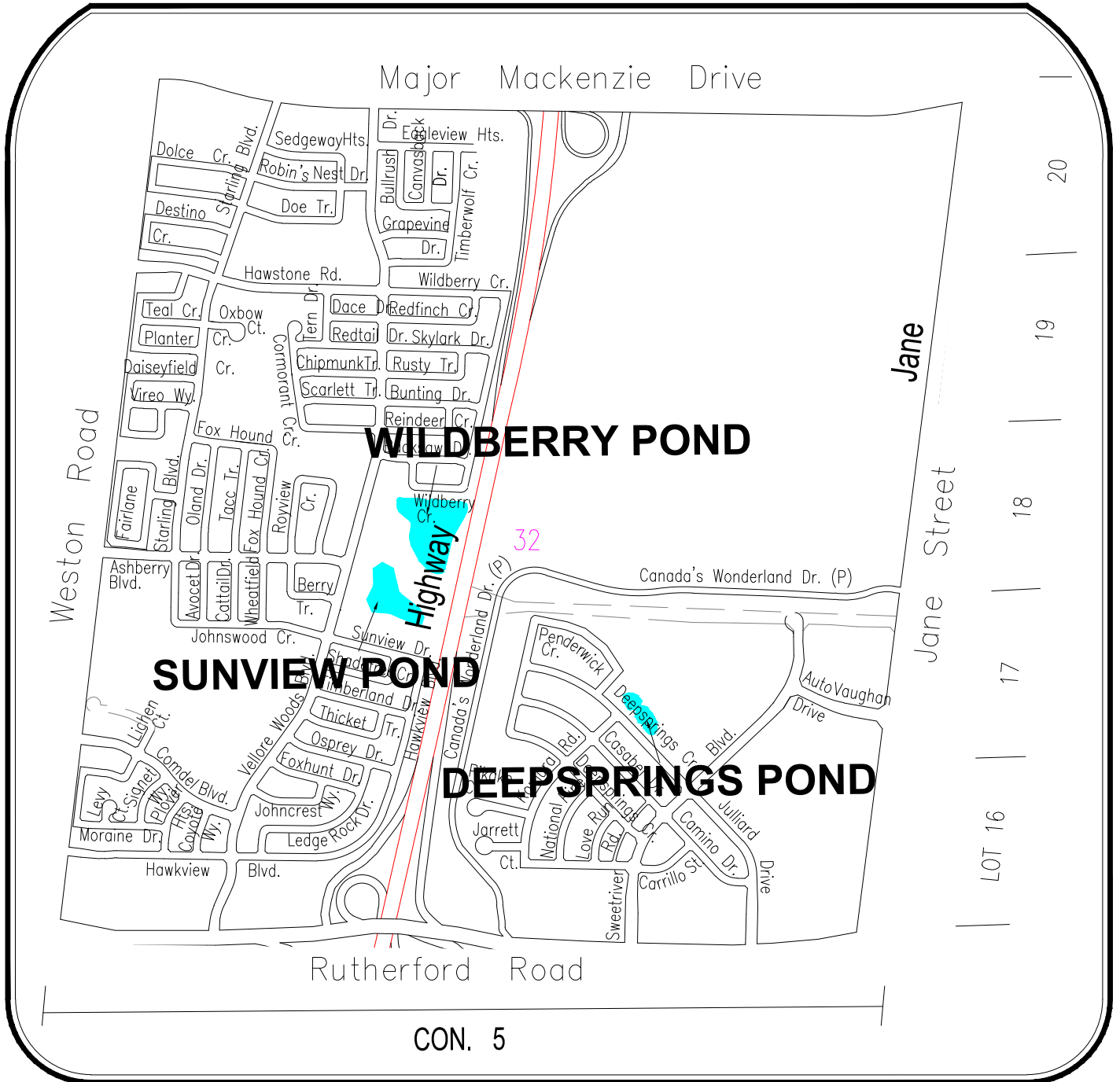
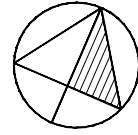

CITY BLOCK NUMBER 33

Not To Scale

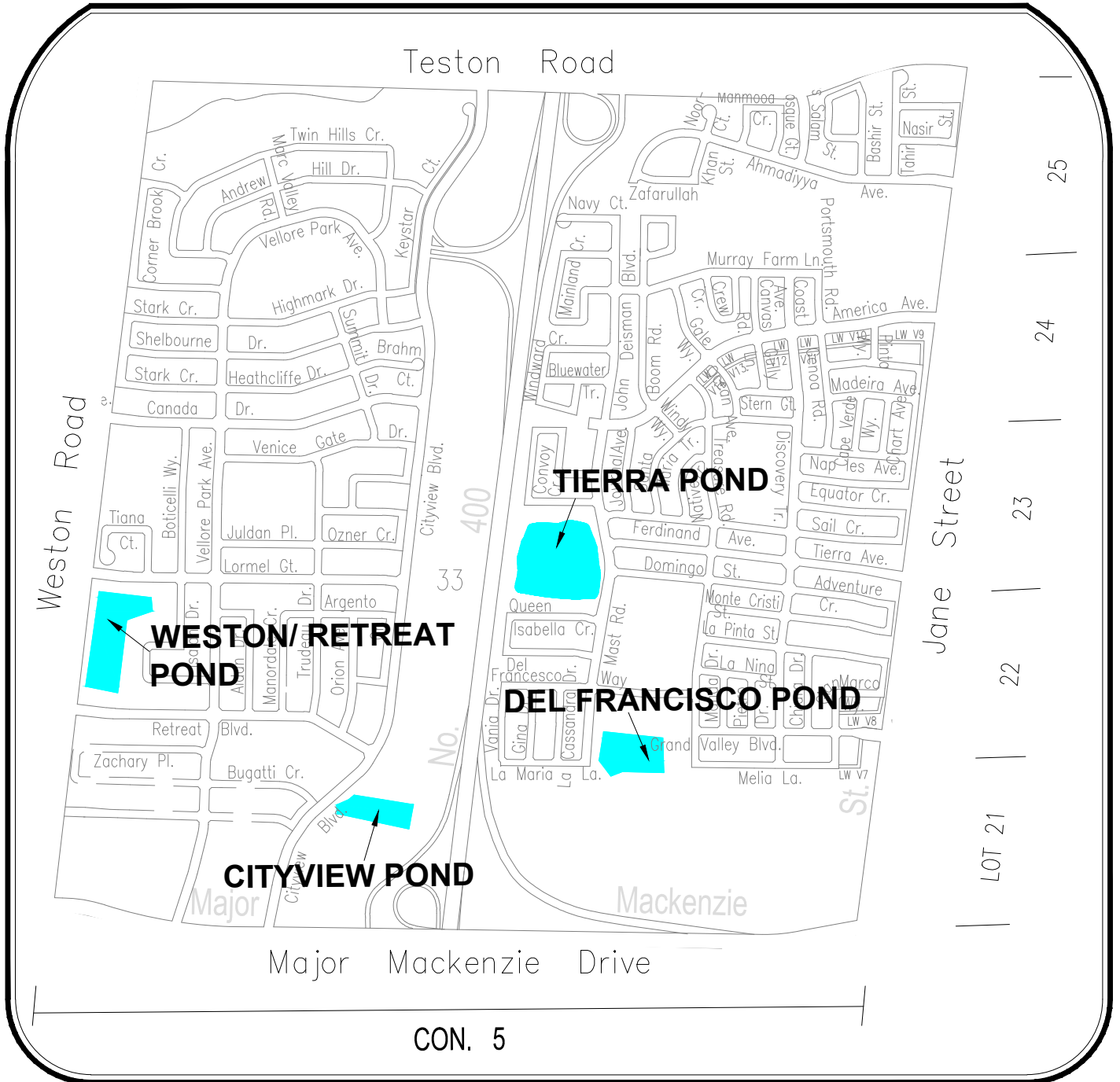
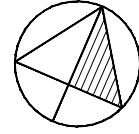

CITY BLOCK NUMBER 34

Not To Scale

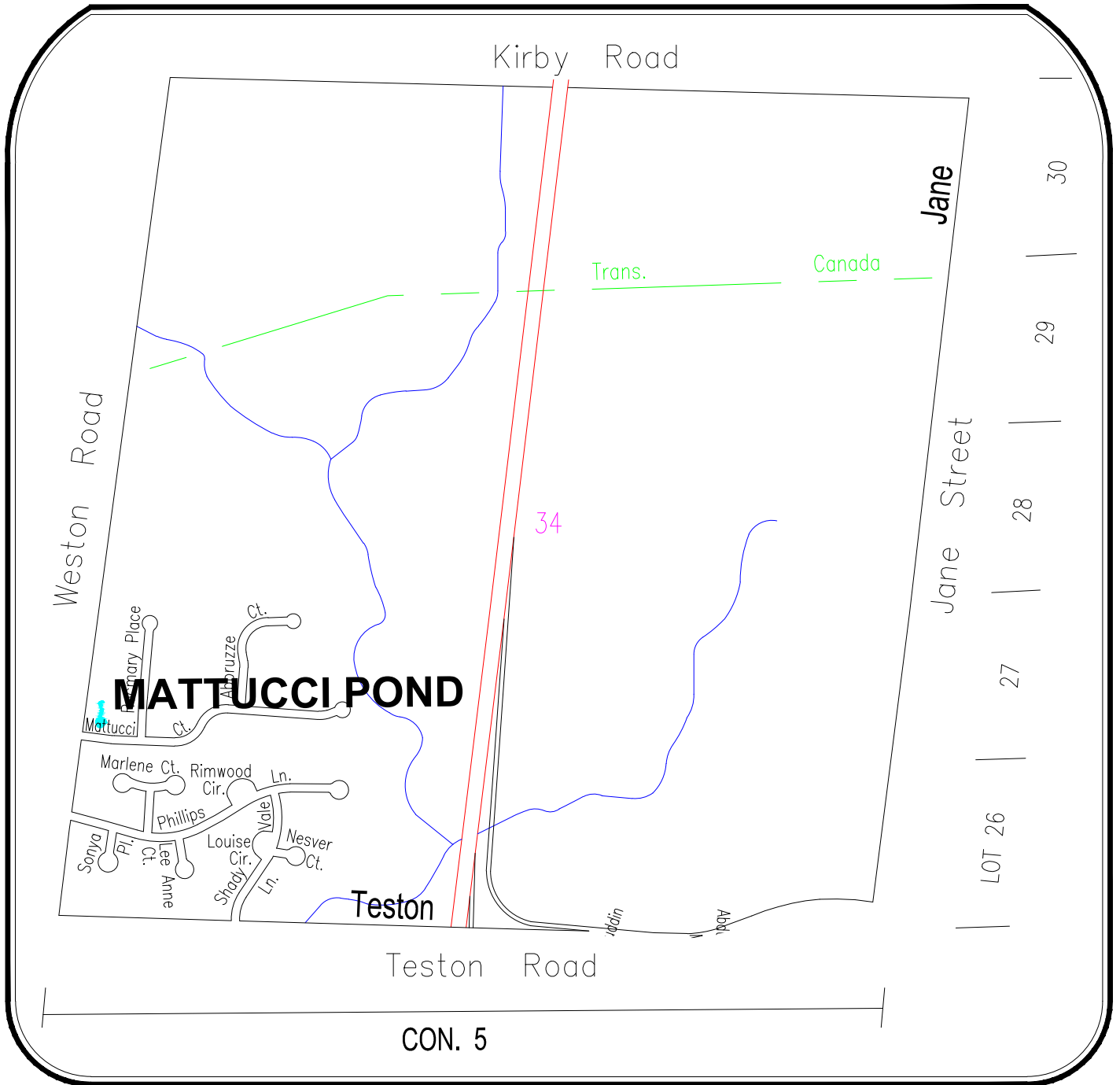
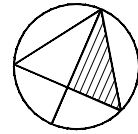

CITY BLOCK NUMBER 36

Not To Scale

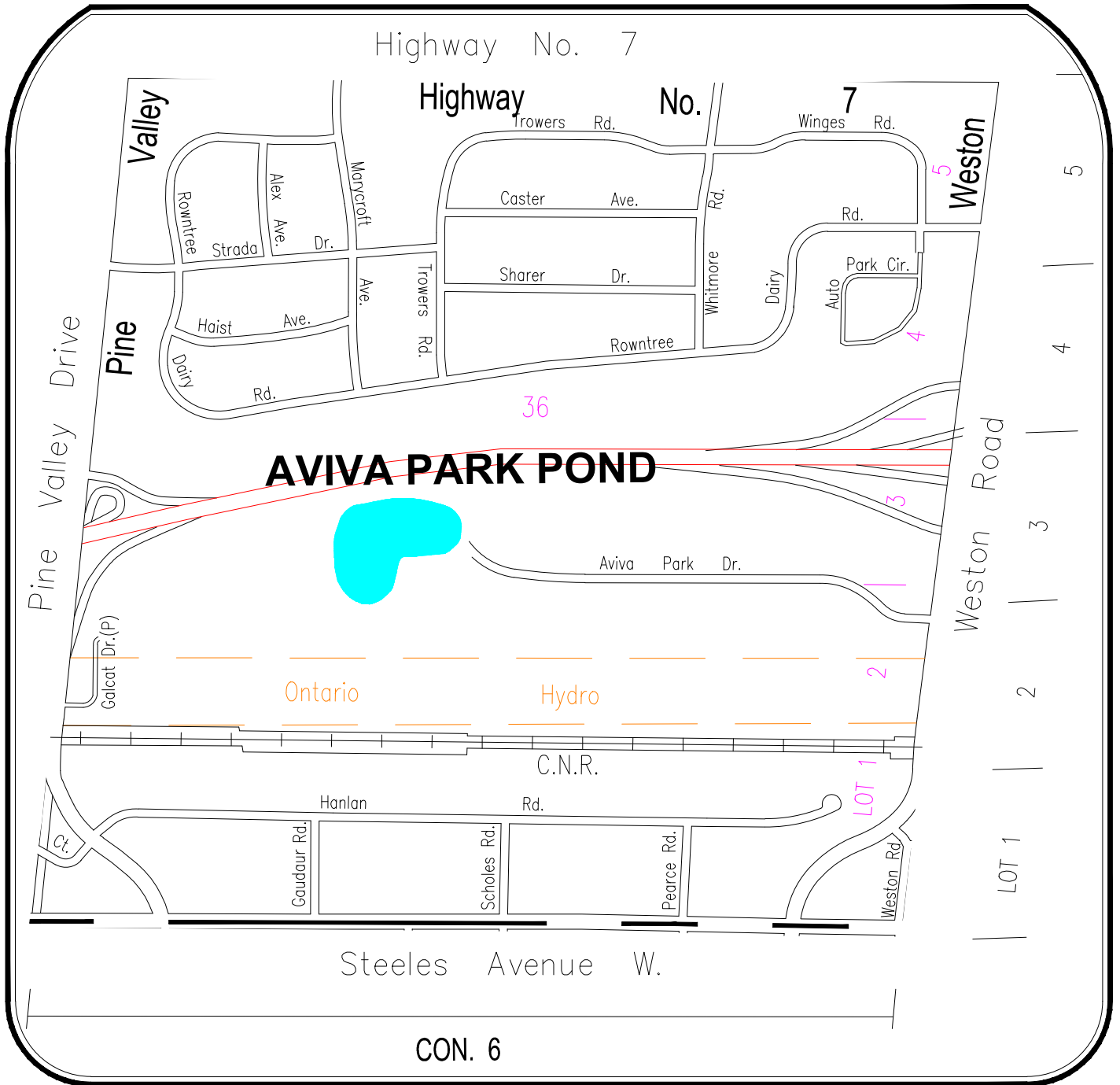
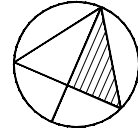

CITY BLOCK NUMBER 39

Not To Scale

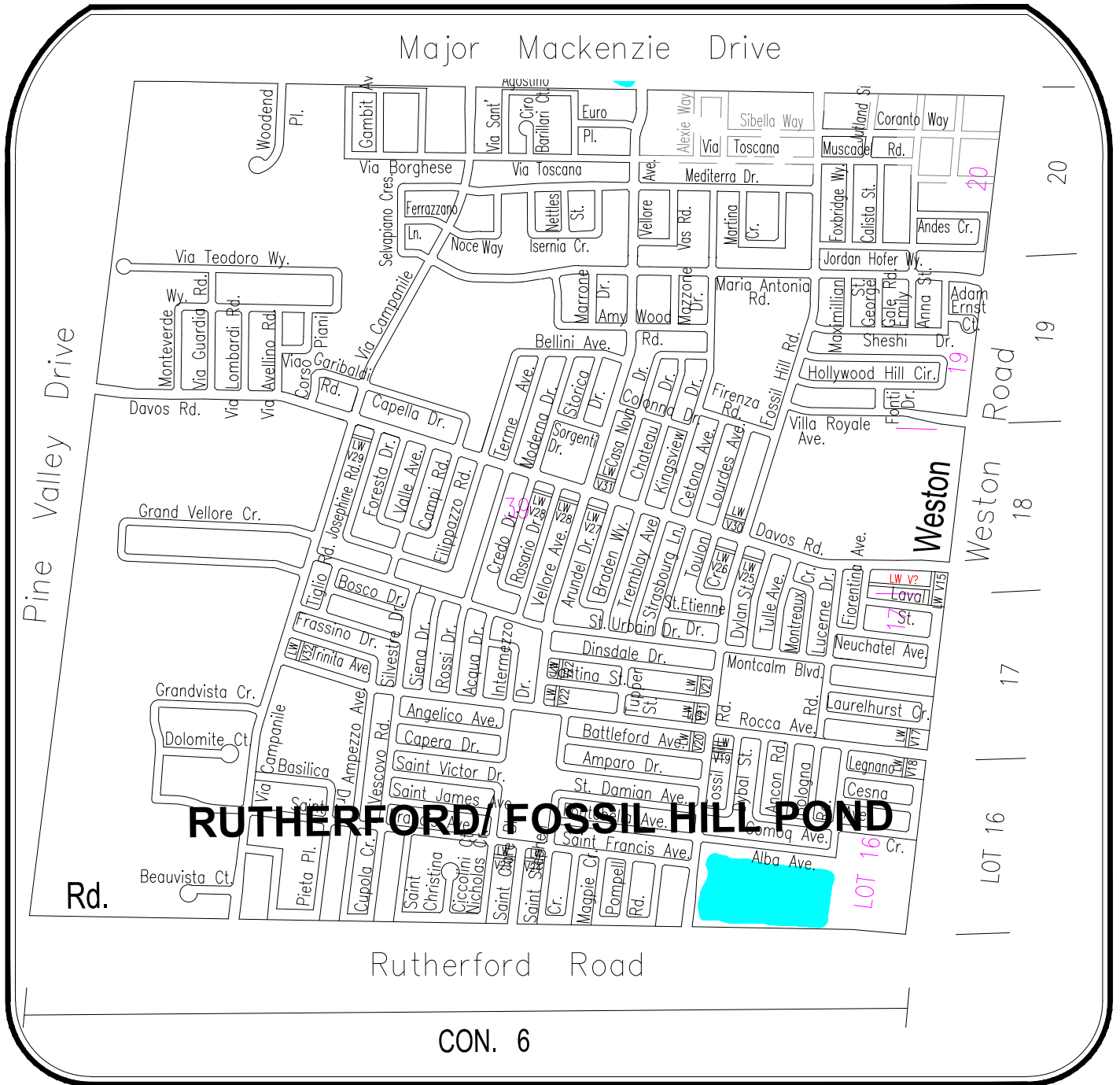
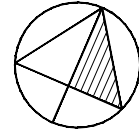

CITY BLOCK NUMBER 43

Not To Scale

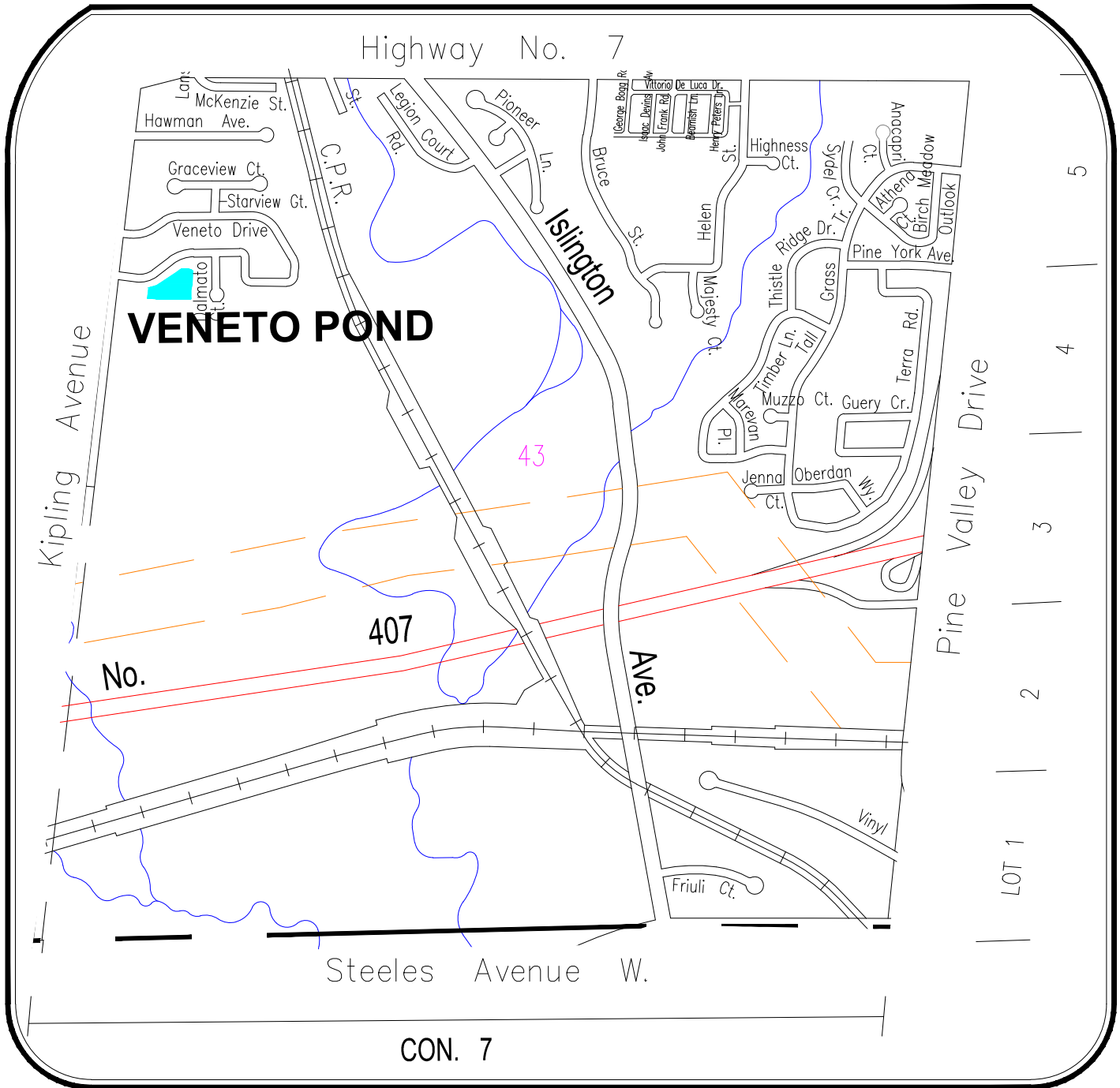
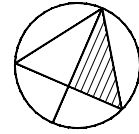

CITY BLOCK NUMBER 45

Not To Scale

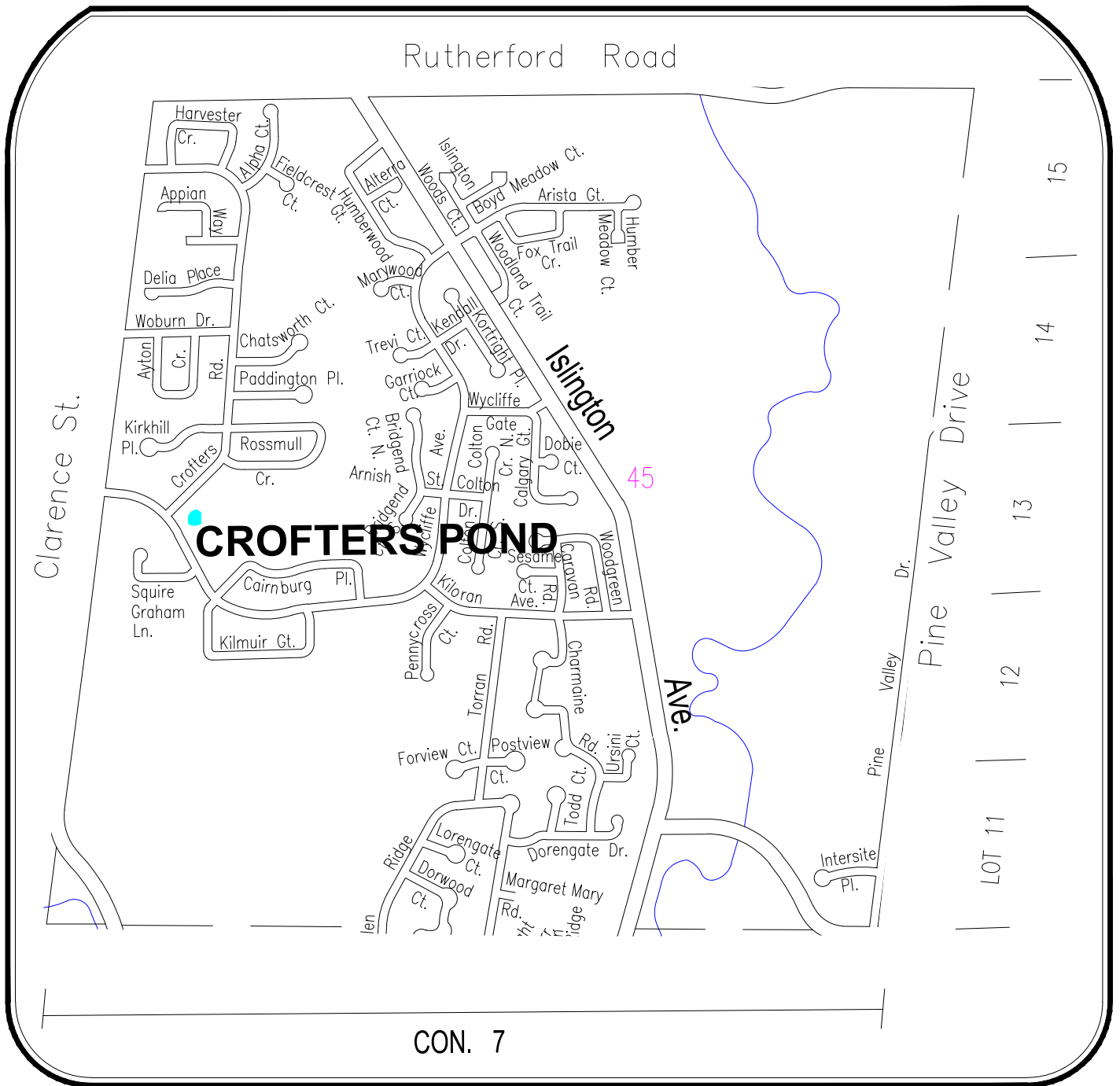
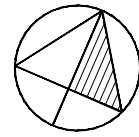

Public Works

... Working For You!

CITY BLOCK NUMBER 46

Not To Scale

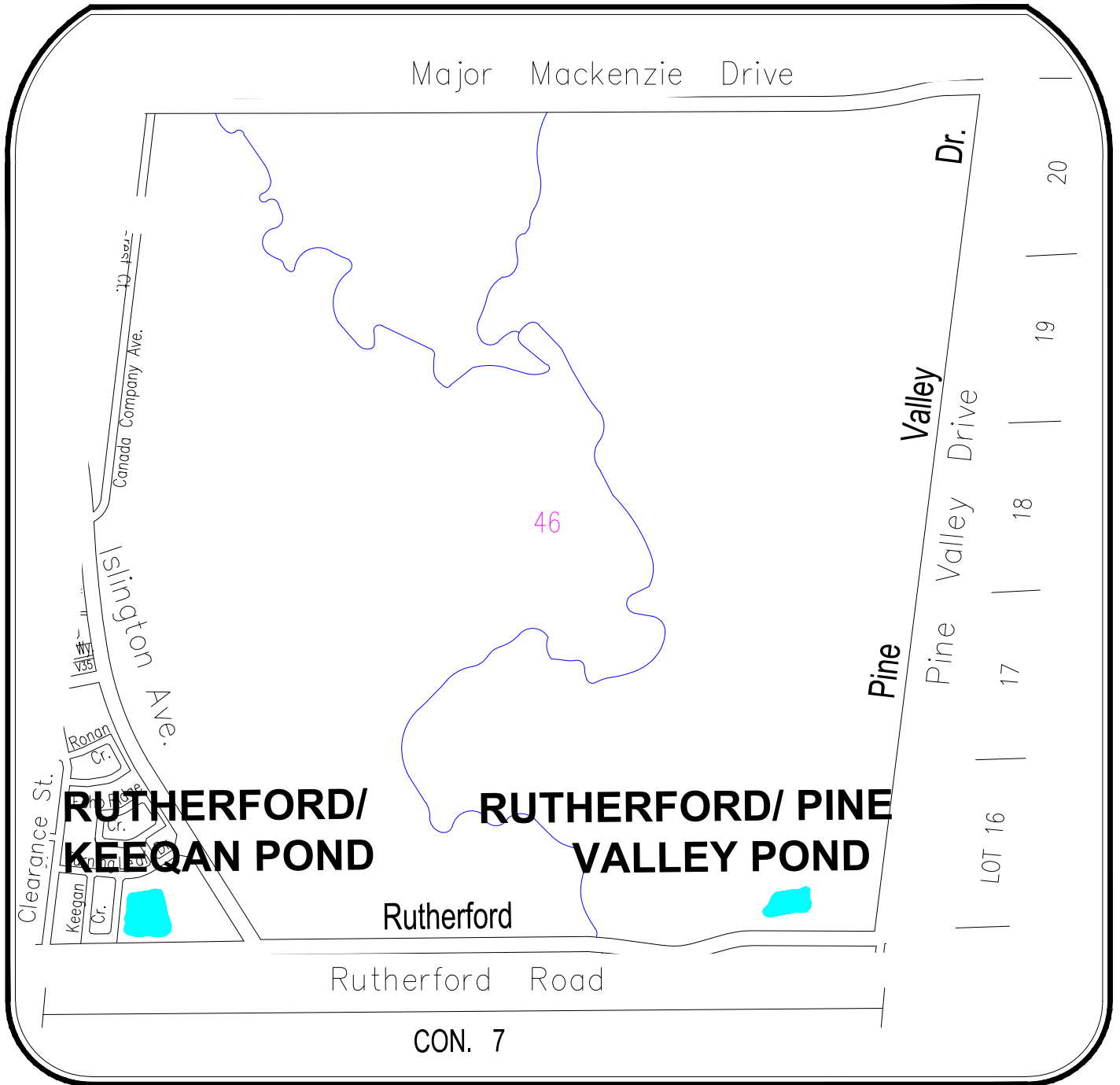
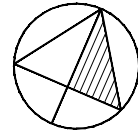

CITY BLOCK NUMBER 50

Not To Scale

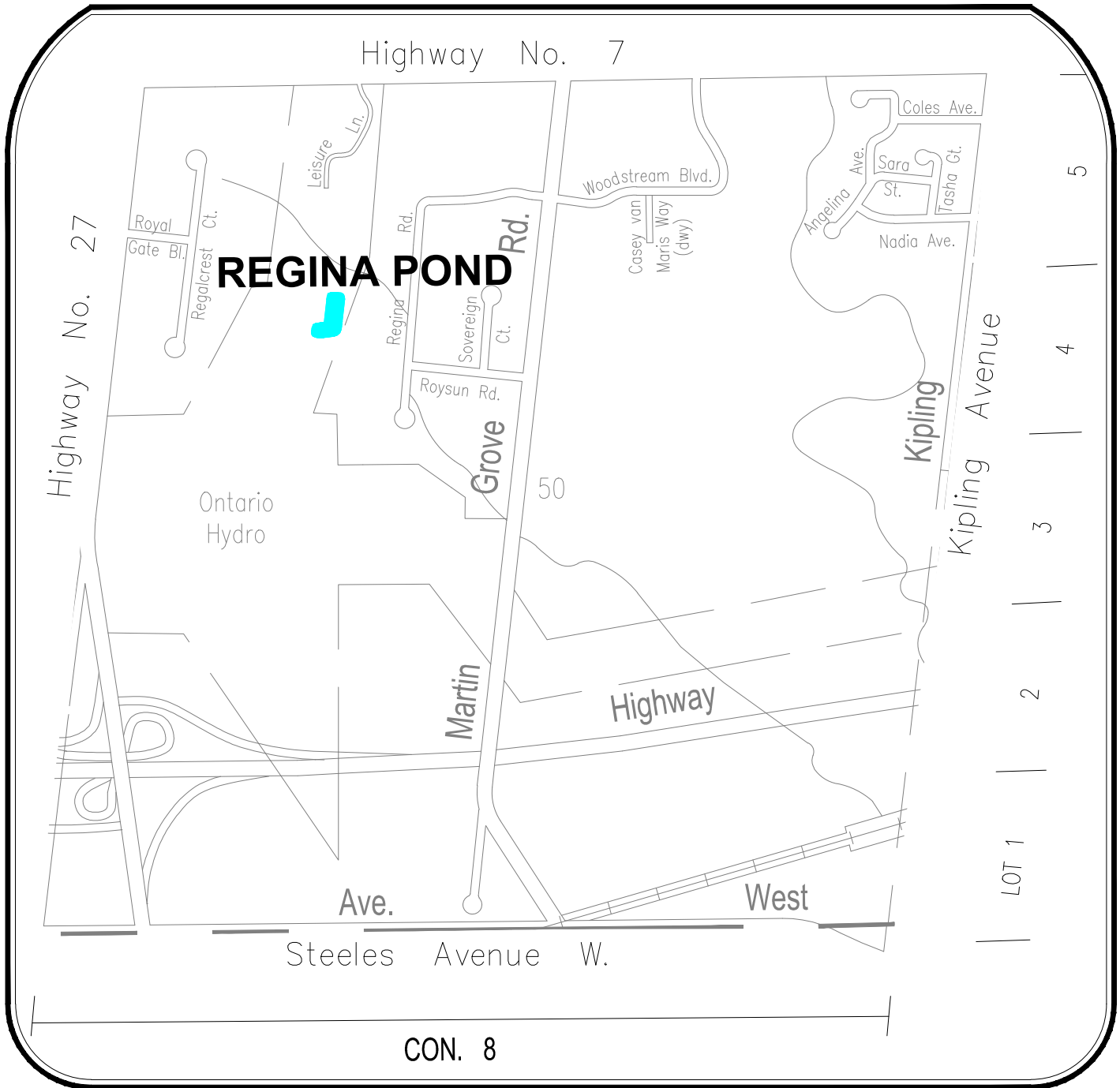
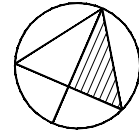

CITY BLOCK NUMBER 51

Not To Scale

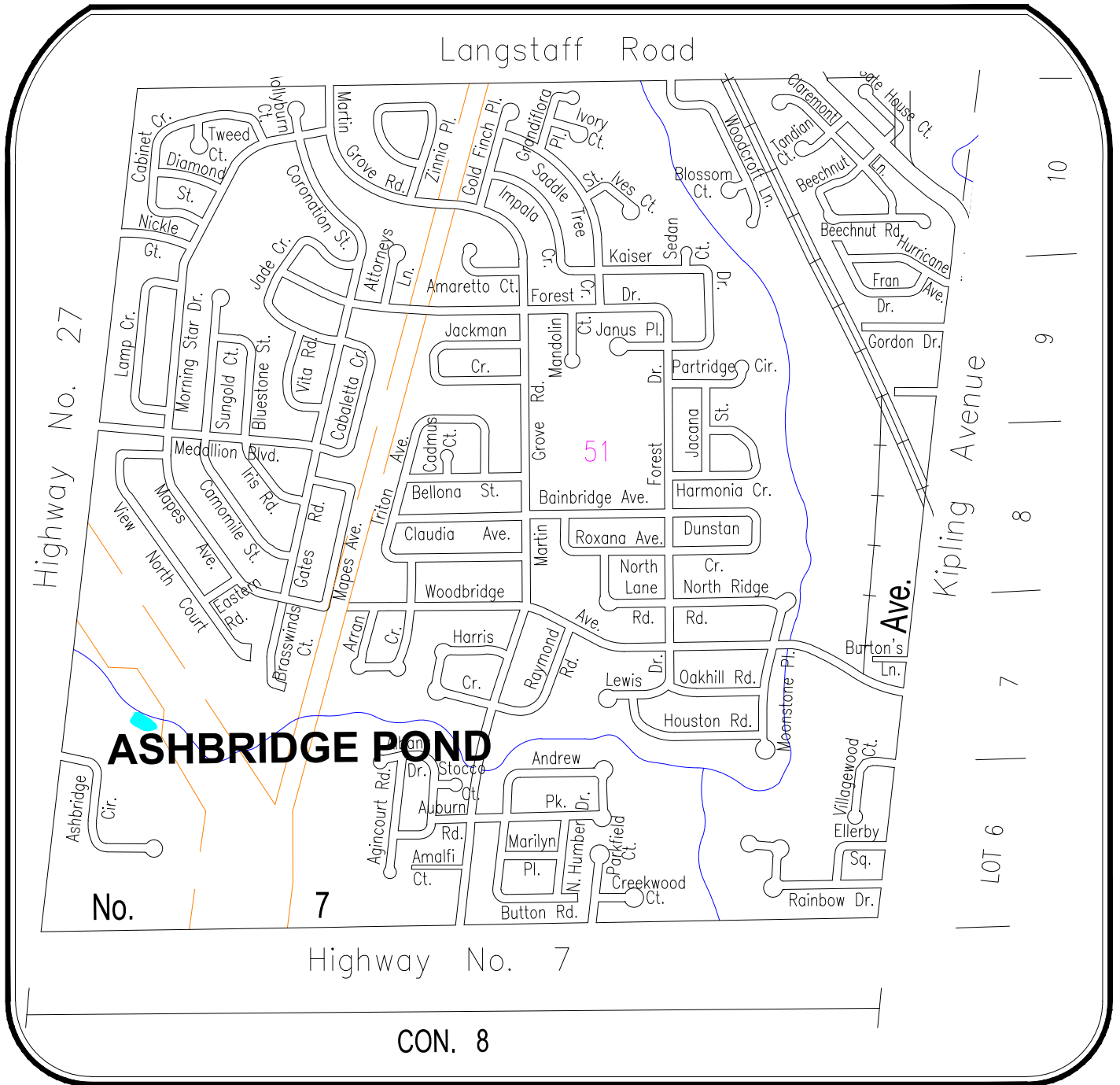
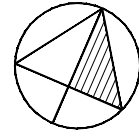

Public Works

... Working For You!

CITY BLOCK NUMBER 52

Not To Scale

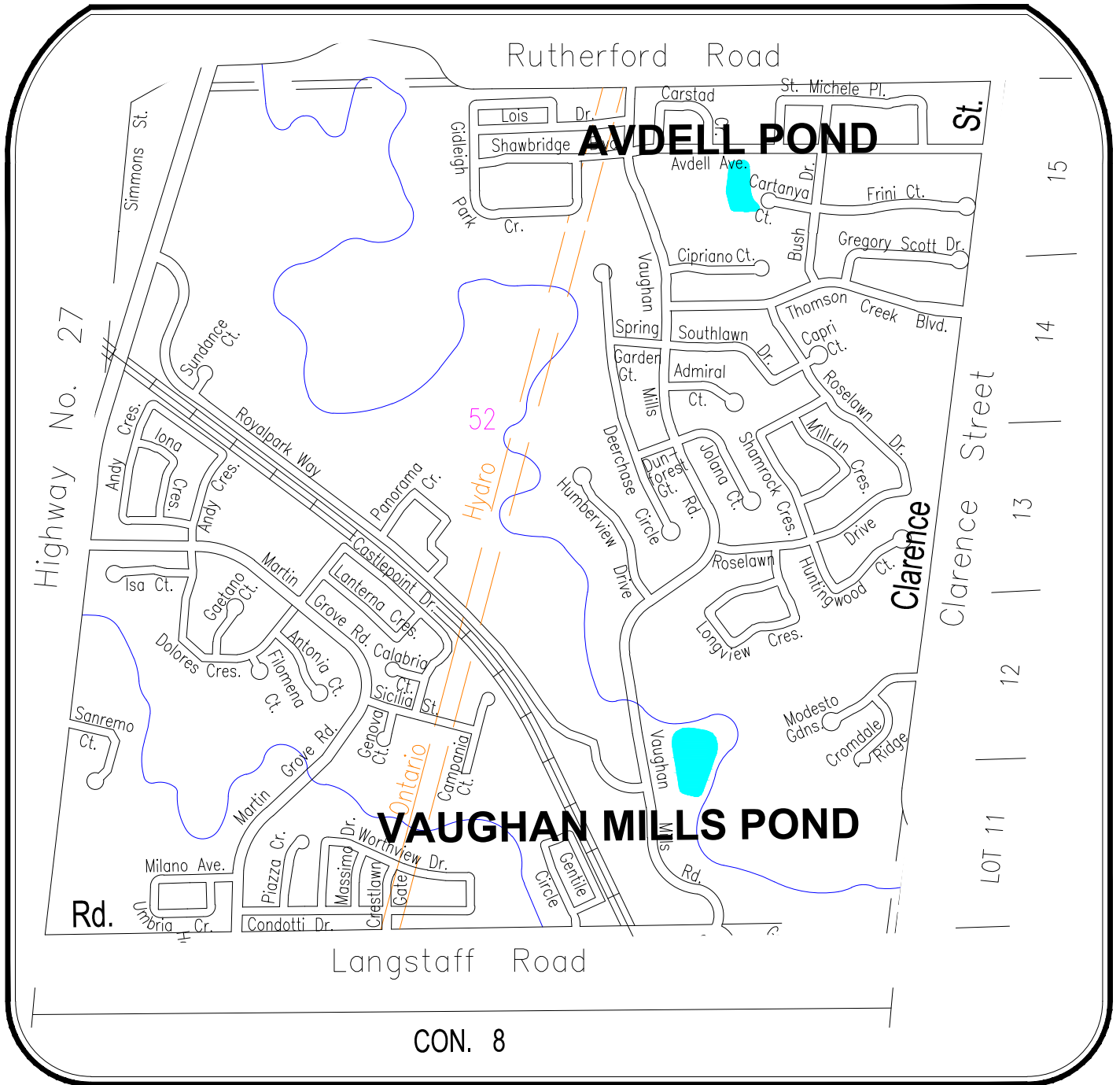
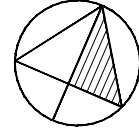

Public Works

... Working For You!

CITY BLOCK NUMBER 53

Not To Scale

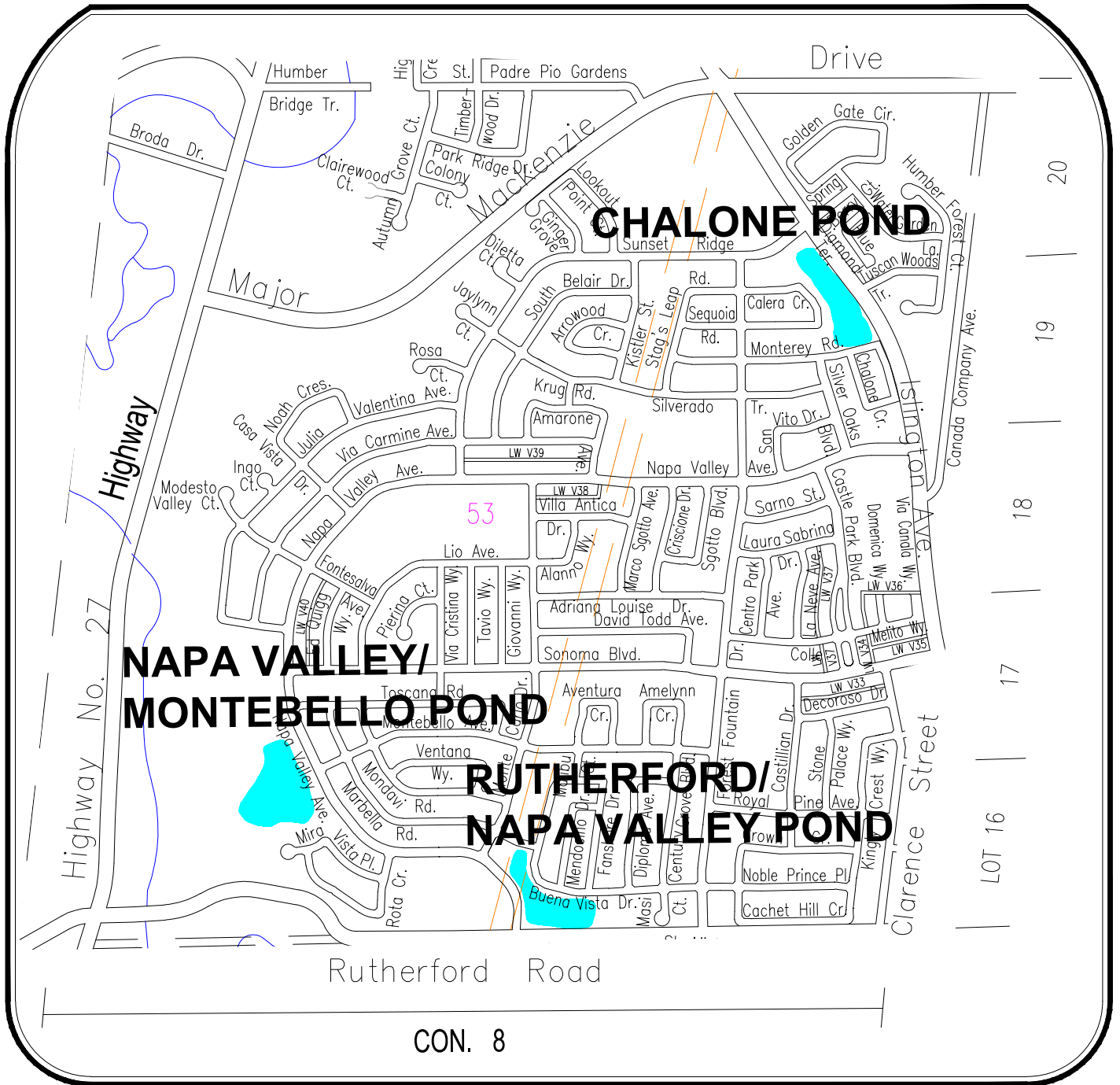
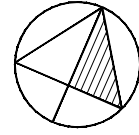

CITY BLOCK NUMBER 54

Not To Scale

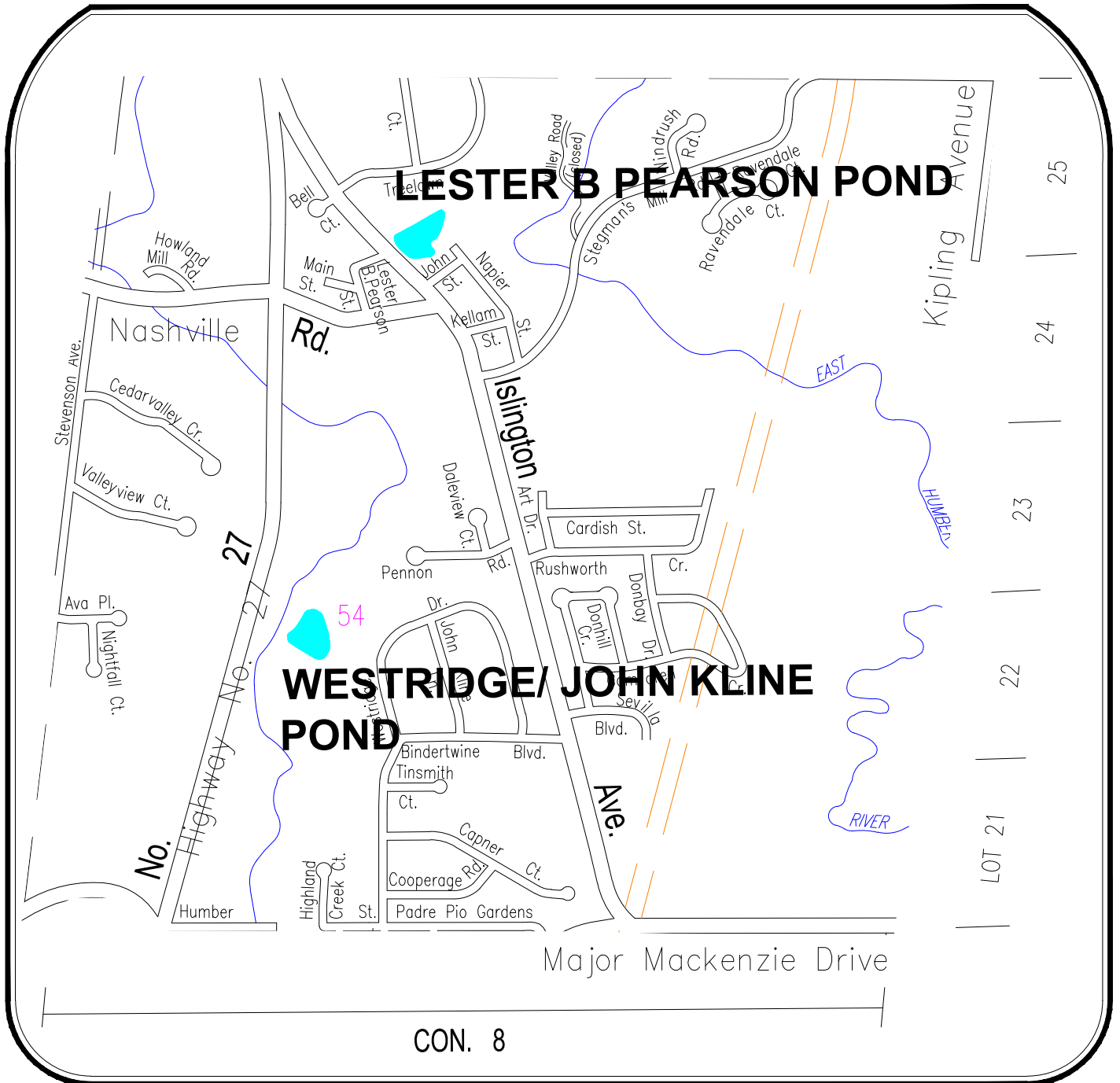
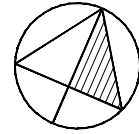

CITY BLOCK NUMBER 55

Not To Scale

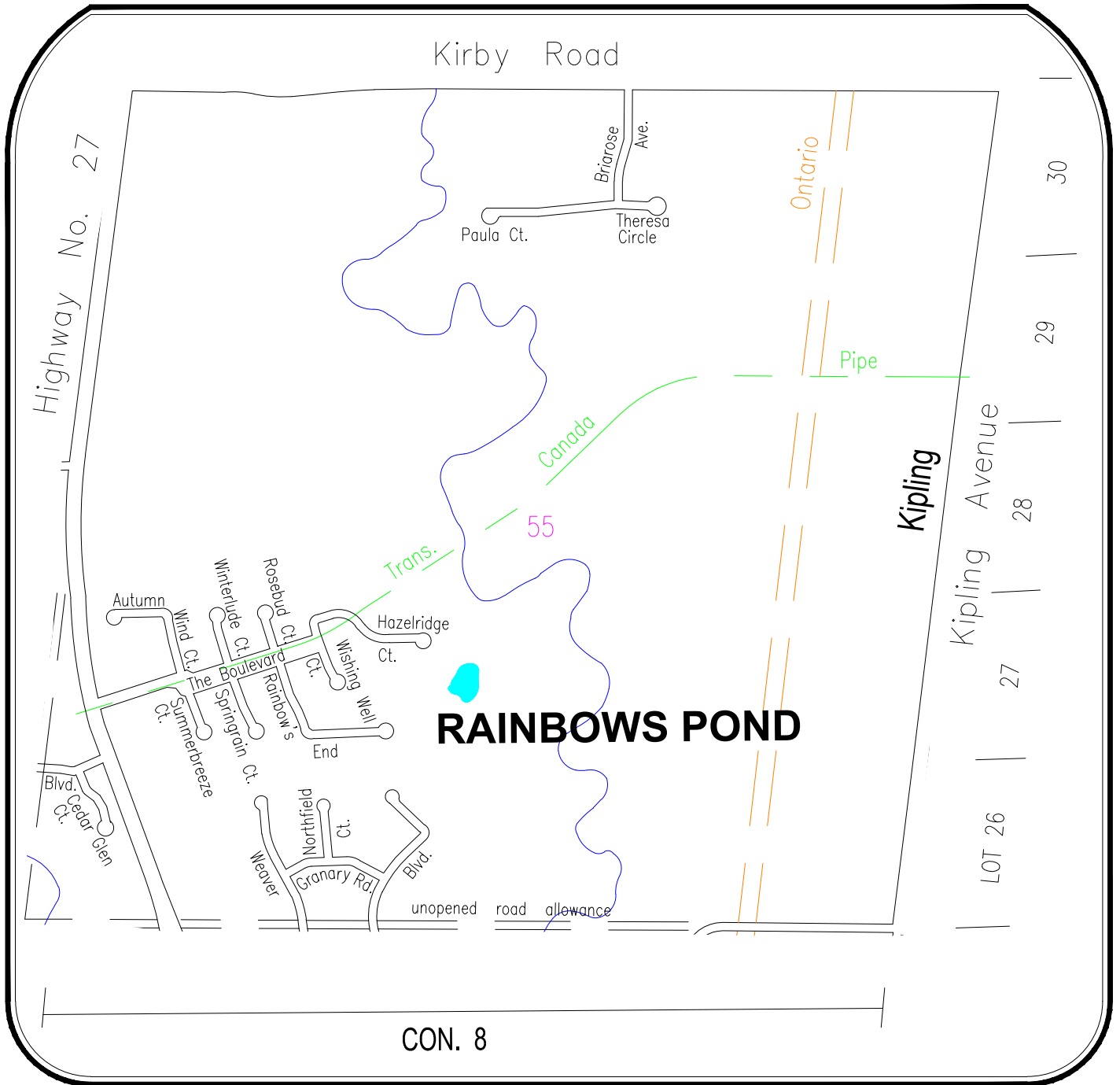
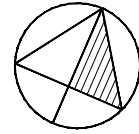

CITY BLOCK NUMBER 57

Not To Scale

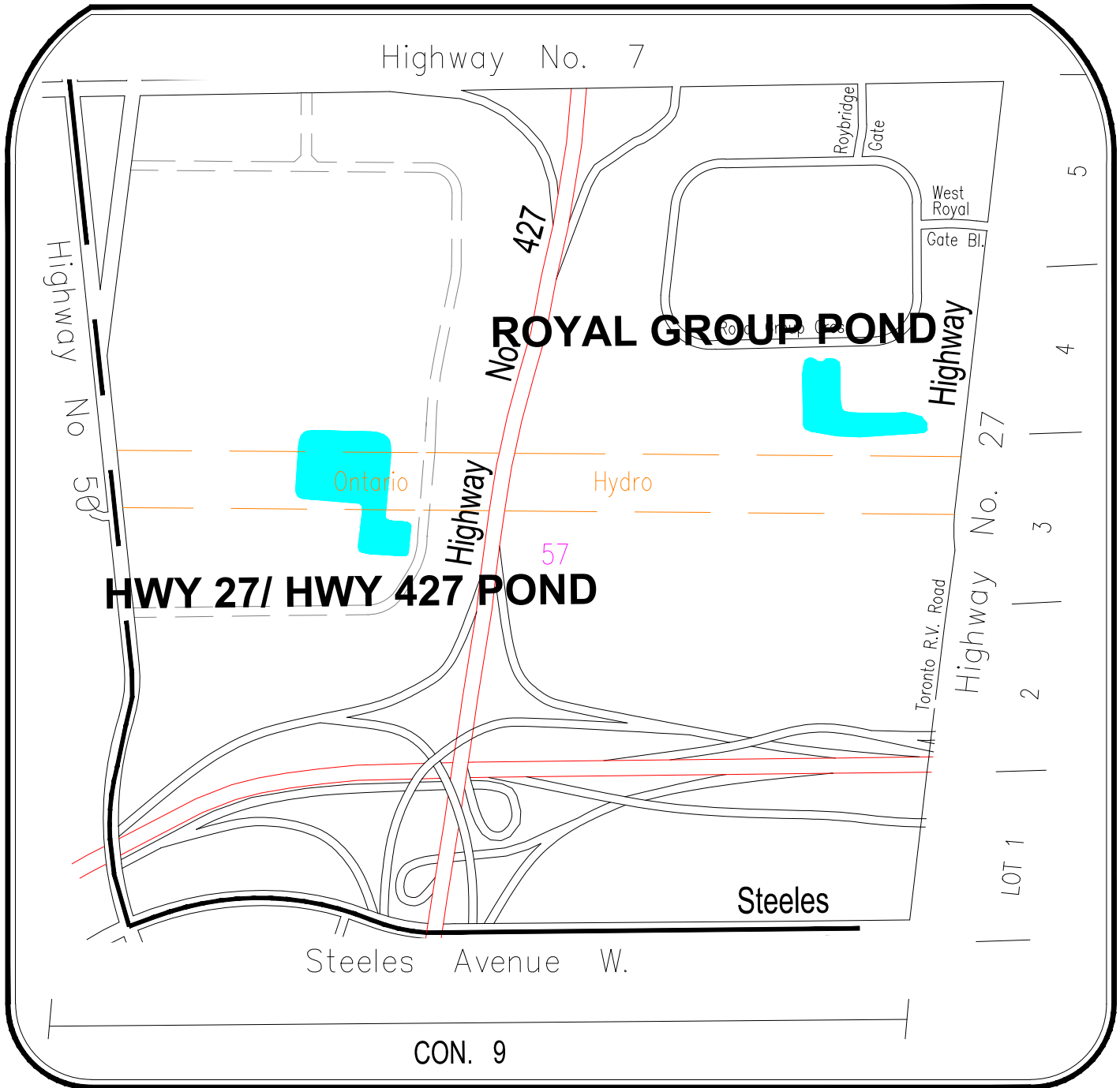
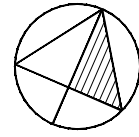

CITY BLOCK NUMBER 58

Not To Scale

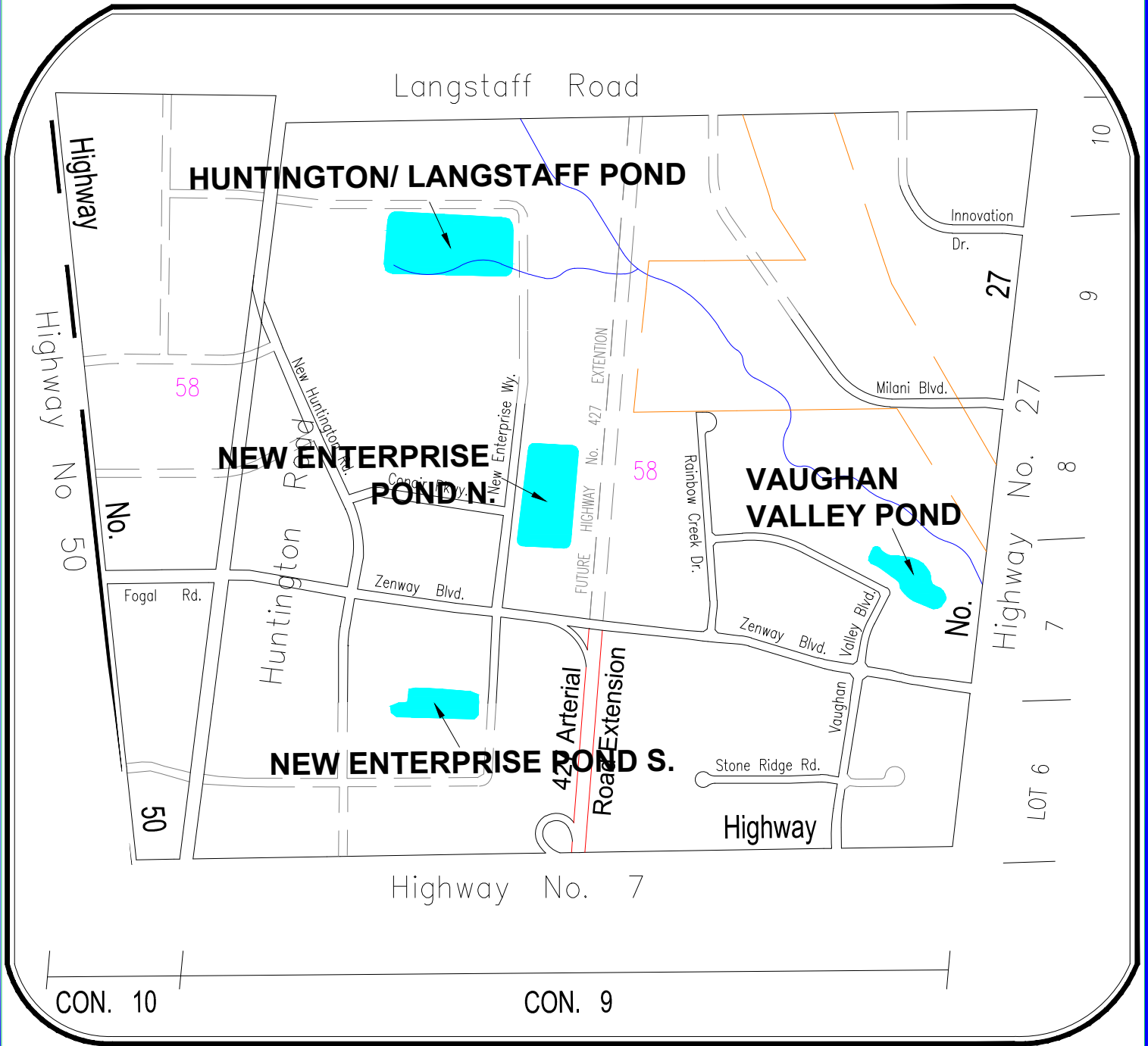
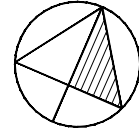

Public Works

... Working For You!

CITY BLOCK NUMBER 62

Not To Scale

